

- LEGEND:**
- (LP) = LOW POINT
 - (HP) = HIGH POINT
 - (PC) = POINT OF CURVATURE
 - (PT) = POINT OF TANGENCY
 - TC = TOP OF CURB
 - CN = CROWN
 - FL = FLOWLINE
 - ME = MATCH EXISTING ELEVATION
 - = DIRECTION OF STORMWATER FLOW
 - ▨ = PAVEMENT REMOVAL

- NOTES:**
1. UNLESS OTHERWISE INDICATED, DIMENSIONS ARE MEASURED TO BACK OF CURB.
 2. ALL TOP OF CURB GRADES ARE TO TOP OF COMBINED CURB & GUTTER. 0.25' MUST BE SUBTRACTED FROM TOP OF CURB ELEVATIONS TO TOP OF ROLL CURB.

BENCHMARK:
 CITY OF WICHITA DISC. AT THE NW COR. OF MAY & WEST ST. 65' W. OF CL WEST ST., 50' N. OF CL MAY
 ELEV. = 108.63 CITY DATUM
 NORTH BOLT OF FIRE HYDRANT, AT THE NW CORNER KESSLER & MAY
 ELEV. = 112.78 CITY DATUM

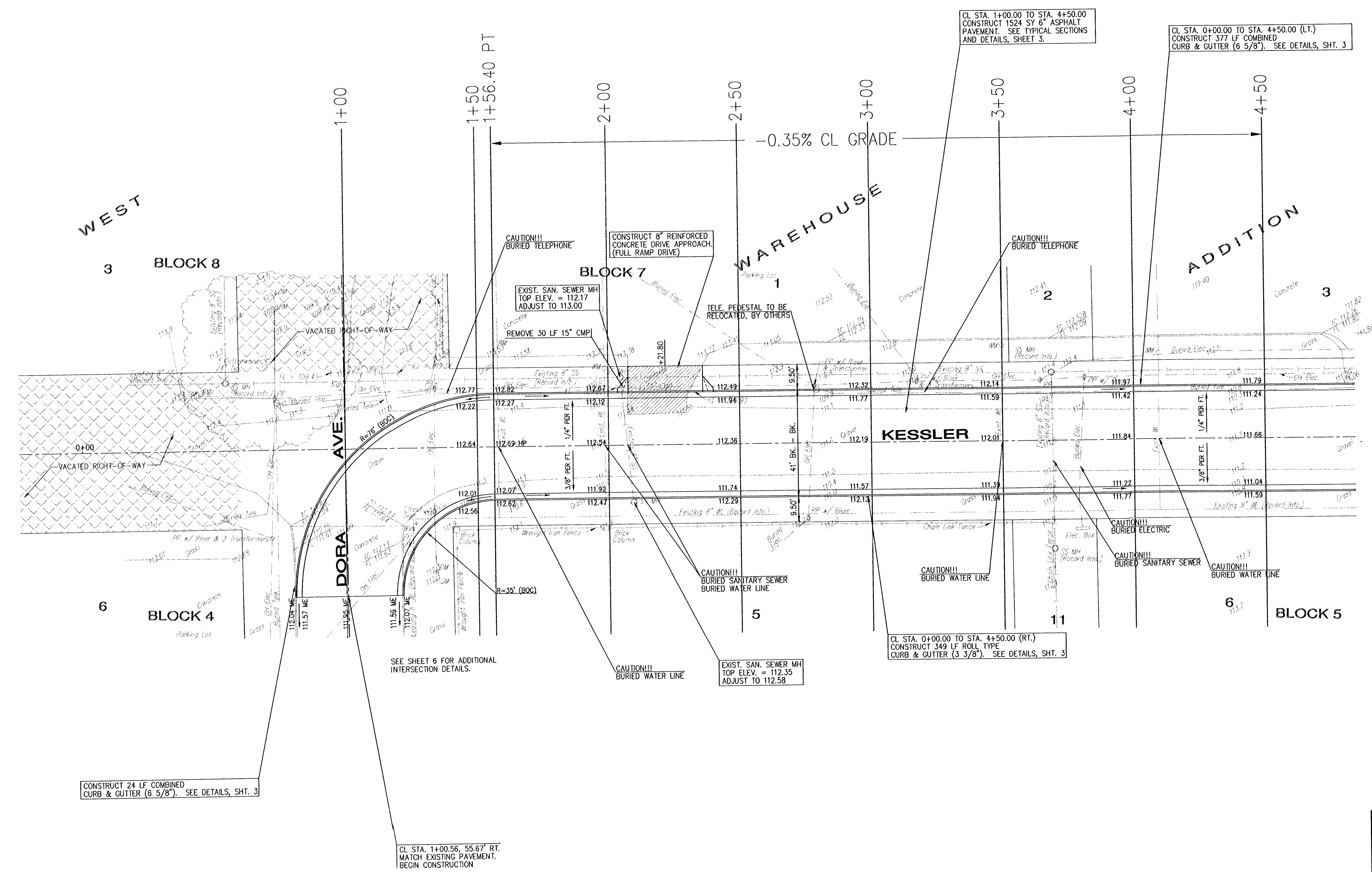

CONSTRUCT 24 LF COMBINED CURB & GUTTER (6 5/8"). SEE DETAILS, SHT. 3

CL STA. 1+00.56, 55.67' RT. MATCH EXISTING PAVEMENT. BEGIN CONSTRUCTION

CL STA. 0+00.00 TO STA. 4+50.00 (RT.) CONSTRUCT 349 LF ROLL TYPE CURB & GUTTER (3 3/8"). SEE DETAILS, SHT. 3

CL STA. 1+00.00 TO STA. 4+50.00 CONSTRUCT 1524 SY 6" ASPHALT PAVEMENT. SEE TYPICAL SECTIONS AND DETAILS, SHEET 3.

CL STA. 0+00.00 TO STA. 4+50.00 (LT.) CONSTRUCT 377 LF COMBINED CURB & GUTTER (6 5/8"). SEE DETAILS, SHT. 3

YOUNG & ASSOCIATES, PA
 Civil and Environmental Engineers

City of Wichita
 Sedgwick County, Kansas

KESSLER STREET
 (Sta. 0+00 TO 4+50.00)
 PAVING PLAN

Date: October 2002 Engr.: CRY Tech.: DAS, JVS
 Y&A Proj. No.: 02-144 Scale: As Noted

100 South Georgia
 Derby, Kansas, 67037
 Tele: (316) 788-2552
 Fax: (316) 788-4408

Sheet No. 4 of 15

C:\McAdams\144\FIN\144strppl.dwg Mon Nov 25 12:00:46 2002