

BENCHMARKS:
 Oliver and 45th St. N. - Top of Brass Plate on SW Corner of R.C.B.C. East of Intersection. ELEV. = 1398.88 NGVD (211.48 City Datum)

60d Nail In H.L.P., 33' S. of the NW Corner of Gov't. Lot 1 in the NE1/4 of Sec. 26, TWP. 26-S, R-1-E of the 6th P.M. Elev. = 1377.19 NGVD (189.79 City Datum)

P.V.I.
 Elev. = 205.20
 No V.C.

Curve #4
 Curve Data Based on Centerline
 Rad. = 175' Delta = 51° 34' 17" Tangent = 84.54'
 Arc = 157.52' L.C. = 152.25' Def./Ft. = 9.82187 Min.

Station	Arc	FACE CHORD LENGTHS		Defl.	T. Defl.
		8' Lt.	8' Rt.		
11+69.94	-	-	-	0'00"00"	0'00"00"
11+75.00	5.06'	5.78'	4.34'	0'49"42"	0'49"42"
12+00.00	25.00'	28.55'	21.41'	4'05"33"	4'55"15"
12+25.00	25.00'	28.55'	21.41'	4'05"33"	9'00"47"
12+50.00	25.00'	28.55'	21.41'	4'05"33"	13'06"20"
12+75.00	25.00'	28.55'	21.41'	4'05"33"	17'11"53"
13+00.00	25.00'	28.55'	21.41'	4'05"33"	21'17"26"
13+25.00	25.00'	28.55'	21.41'	4'05"33"	25'22"59"
13+27.46	2.46'	2.81'	2.11'	0'24"10"	25'47"09"

Curve #5
 Curve Data Based on Centerline
 Rad. = 150' Delta = 51° 34' 17" Tangent = 72.47'
 Arc = 135.01' L.C. = 130.50' Def./Ft. = 11.45946 Min.

Station	Arc	FACE CHORD LENGTHS		Defl.	T. Defl.
		8' Lt.	8' Rt.		
13+27.46	-	-	-	0'00"00"	0'00"00"
13+50.00	22.54'	18.77'	26.27'	4'18"18"	4'18"18"
13+75.00	25.00'	20.81'	29.13'	4'46"29"	9'04'42"
14+00.00	25.00'	20.81'	29.13'	4'46"29"	13'51"16"
14+25.00	25.00'	20.81'	29.13'	4'46"29"	18'37'45"
14+50.00	25.00'	20.81'	29.13'	4'46"29"	23'24'14"
14+62.47	12.47'	10.39'	14.54'	2'22"54"	25'47'08"

P.V.I.
 Elev. = 208.80
 No V.C.

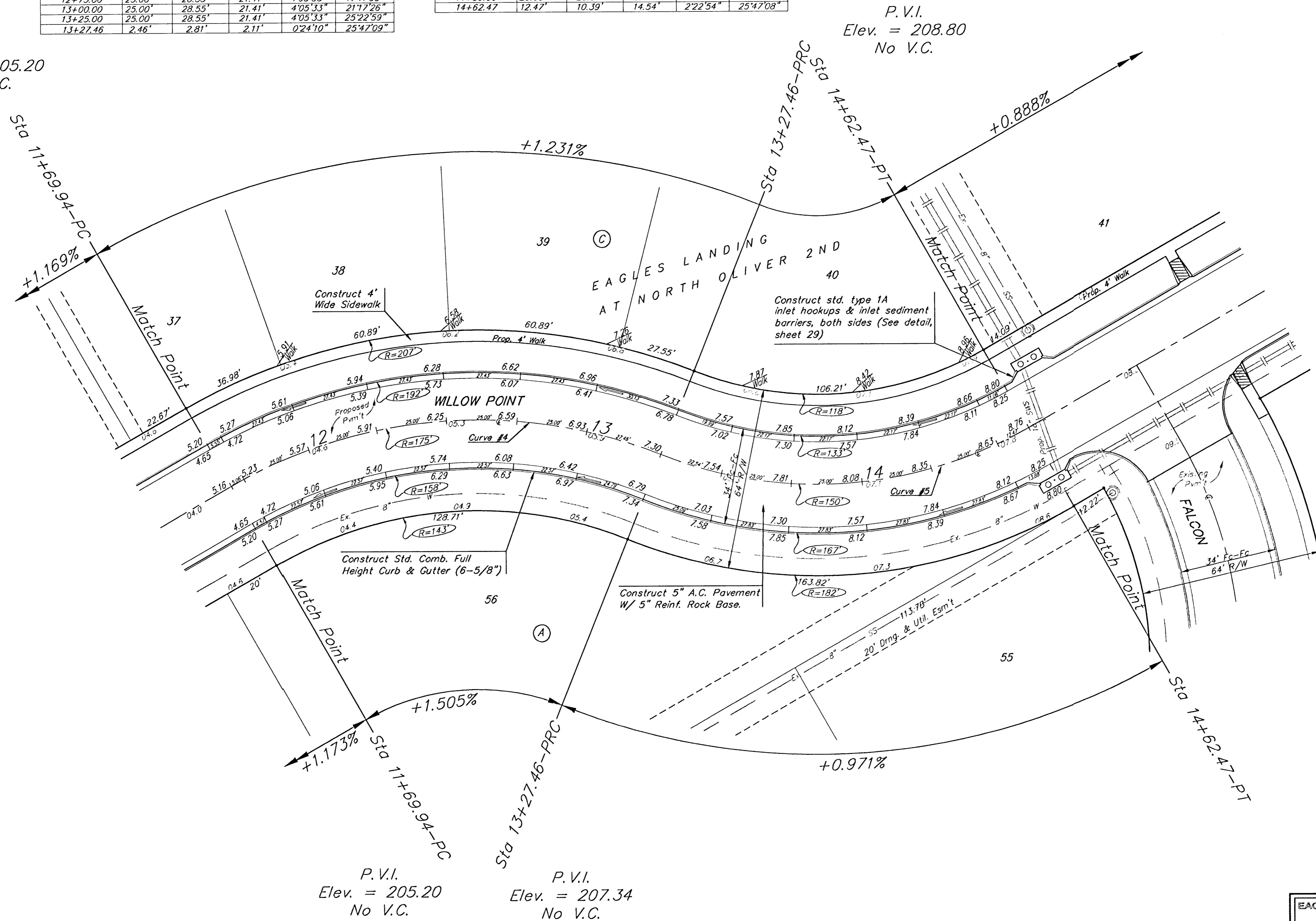

P.V.I.
 Elev. = 205.20
 No V.C.

P.V.I.
 Elev. = 207.34
 No V.C.

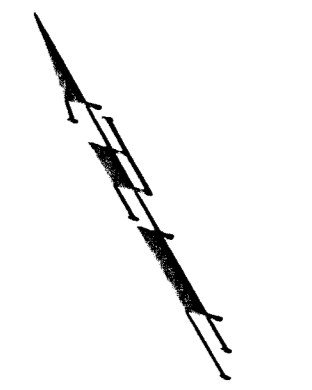

Scale: 1" = 20'
 • = Iron

EAGLES LANDING AT NORTH OLIVER 2ND ADDITION - PH. II
WILLOW POINT
 STA 11+89.94 TO STA 14+82.49

BAUGHMAN COMPANY P.A.
 ENGINEERING, SURVEYING, & PLANNING
 316-262-7271 • 315 ELLIS • WICHITA, KANSAS 67211

PROJECT NUMBER: 472-83485
 SHEET: 9 OF 40

DESIGN: NBW DRAWN: TMS APPROVED: DATE: 03/03 SCALE: Noted