

BENCHMARKS:
 Oliver and 45th St. N. - Top of
 Brass Plate on SW Corner of
 R.C.B.C. East of Intersection.
 ELEV. = 1398.88 NGVD
 (211.48 City Datum)

60d Nail In H.L.P., 33' S. of the
 NW Corner of Gov't. Lot 1 in the
 NE1/4 of Sec. 26, TWP. 26-S,
 R-1-E of the 6th P.M. Elev. =
 1377.19 NGVD
 (189.79 City Datum)

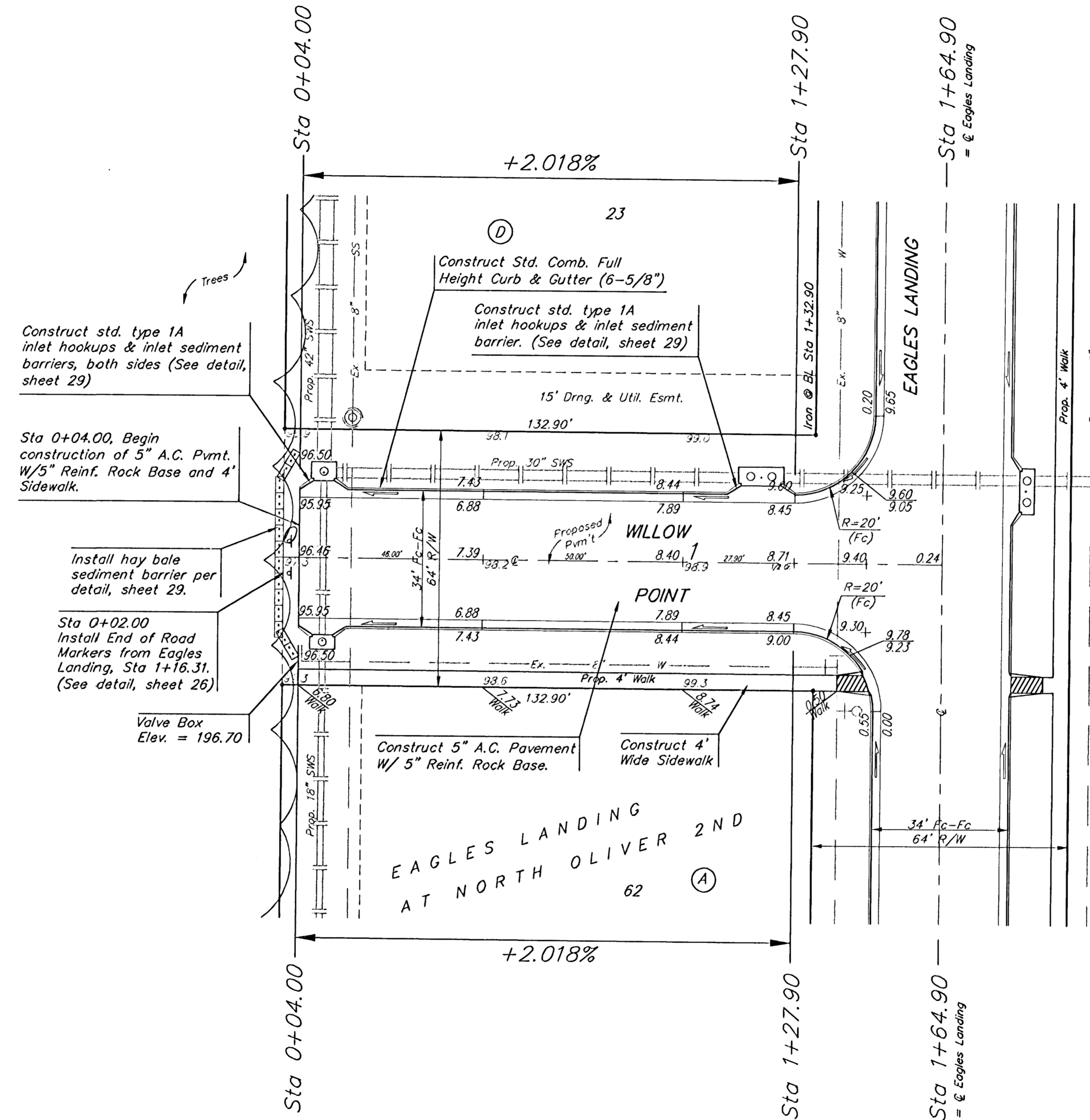

Scale: 1" = 20'
 • = Iron



Construct std. type 1A
 inlet hookups & inlet sediment
 barriers, both sides (See detail,
 sheet 29)

Sta 0+04.00, Begin
 construction of 5" A.C. Pvmt.
 W/5" Reinf. Rock Base and 4'
 Sidewalk.

Install hay bale
 sediment barrier per
 detail, sheet 29.

Sta 0+02.00
 Install End of Road
 Markers from Eagles
 Landing, Sta 1+16.31.
 (See detail, sheet 26)

Valve Box
 Elev. = 196.70

EAGLES LANDING AT NORTH OLIVER 2ND ADDITION - PH. II
WILLOW POINT
 STA 0+04.00 TO STA 1+64.90

BAUGHMAN COMPANY P.A.
 ENGINEERING, SURVEYING, & PLANNING
 316-262-7271 • 315 ELLIS • WICHITA, KANSAS 67211

PROJECT NUMBER
472-83485

DESIGN NBW	DRAWN TMS	APPROVED	DATE 03/03	SCALE Noted	SHEET 11 OF 40
---------------	--------------	----------	---------------	----------------	---------------------------------------