

**BENCHMARKS:**  
 Oliver and 45th St. N. - Top of  
 Brass Plate on SW Corner of  
 R.C.B.C. East of Intersection.  
 ELEV. = 1398.88 NGVD  
 (211.48 City Datum)

60d Nail In H.L.P., 33' S. of the  
 NW Corner of Gov't. Lot 1 in the  
 NE1/4 of Sec. 26, TWP. 26-S,  
 R-1-E of the 6th P.M. Elev. =  
 1377.19 NGVD  
 (189.79 City Datum)

Scale: 1" = 20'  
 • = Iron

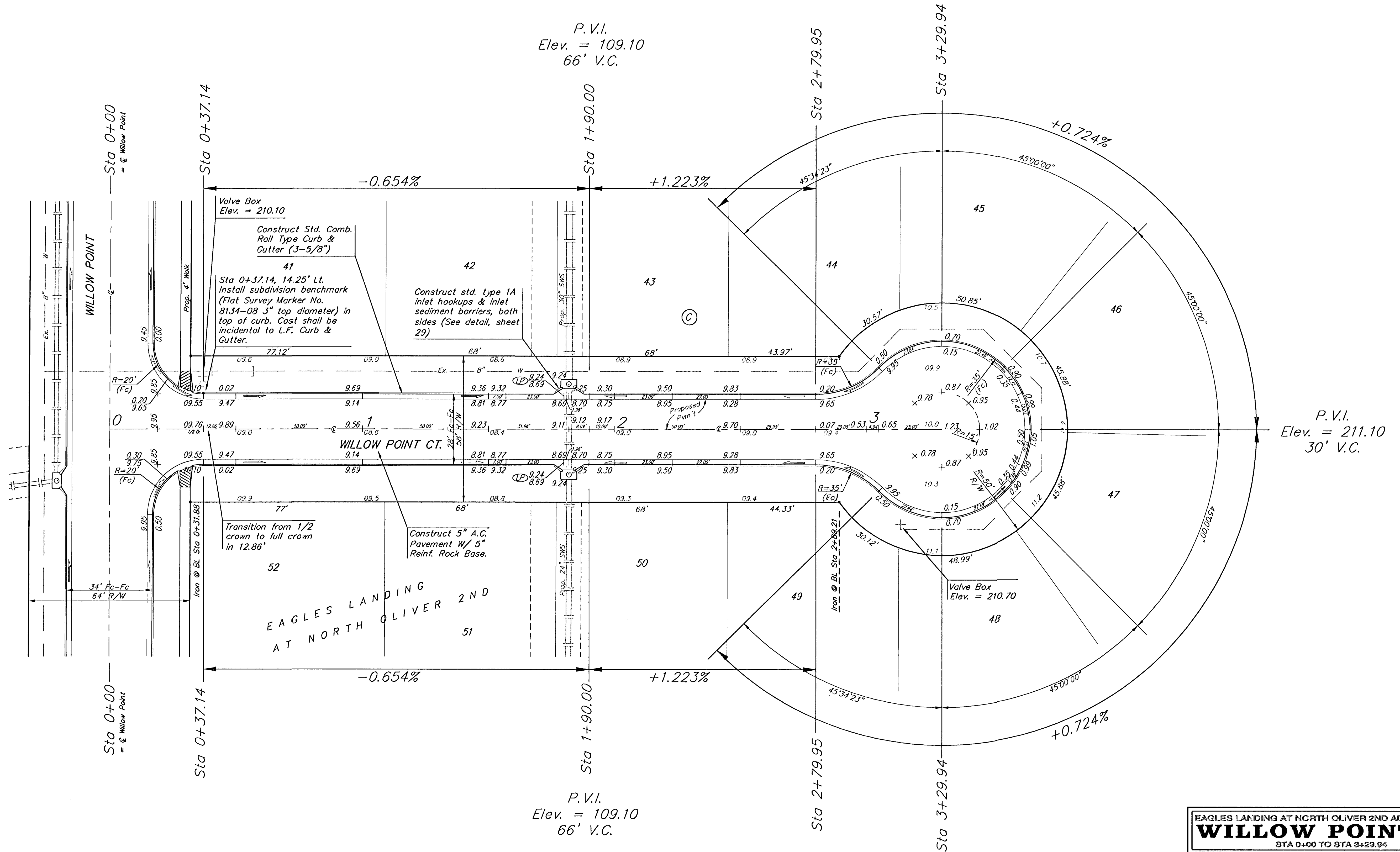

P.V.I.  
 Elev. = 109.10  
 66' V.C.

P.V.I.  
 Elev. = 211.10  
 30' V.C.

P.V.I.  
 Elev. = 109.10  
 66' V.C.

NOTE: ROLL TYPE CURB & GUTTER TO BE CONSTRUCTED ON THE PAVEMENT SHOWN ON THIS SHEET. TOP OF CURB ELEVATIONS ARE GIVEN FOR FULL HEIGHT CURB.

EAGLES LANDING AT NORTH OLIVER 2ND ADDITION - PH. II  
**WILLOW POINT CT.**  
 STA 0+00 TO STA 3+29.94

**BAUGHMAN COMPANY P.A.**  
 ENGINEERING, SURVEYING, & PLANNING  
 316-262-7271 • 315 ELLIS • WICHITA, KANSAS 67211

PROJECT NUMBER  
**472-83485**

DESIGN NBW	DRAWN TMS	APPROVED	DATE 03/03	SCALE Noted	SHEET 14 OF 40
---------------	--------------	----------	---------------	----------------	-------------------------