

5.42-PRC  
 P.V.I. = 180.50  
 Elev. = 65.24' V.C.

Curve #5  
 Curve Data Based on Centerline  
 Rad. = 300' Delta = 41°08' 30" Tangent = 1  
 Arc = 215.42' L.C. = 210.82' Del/Ft. = 5.729

Station	Arc	FACE CHORD LENGTHS		Del
		8' Lt.	8' Rt.	
3+65.42	-	-	-	0'00"
3+75.00	9.58'	8.78'	10.38'	0'54"
4+00.00	25.00'	22.91'	27.08'	2'23"
4+25.00	25.00'	22.91'	27.08'	2'23"
4+50.00	25.00'	22.91'	27.08'	2'23"
4+75.00	25.00'	22.91'	27.08'	2'23"
5+00.00	25.00'	22.91'	27.08'	2'23"
5+25.00	25.00'	22.91'	27.08'	2'23"
5+50.00	25.00'	22.91'	27.08'	2'23"
5+75.00	25.00'	22.91'	27.08'	2'23"
5+80.84	5.84'	5.35'	6.33'	0'33"

Adjust Inlet Top to match proposed grade. Cost to be bid as "Inlet Adjustment".

P.V.I.  
 Elev. = 177.30  
 55.14' V.C.

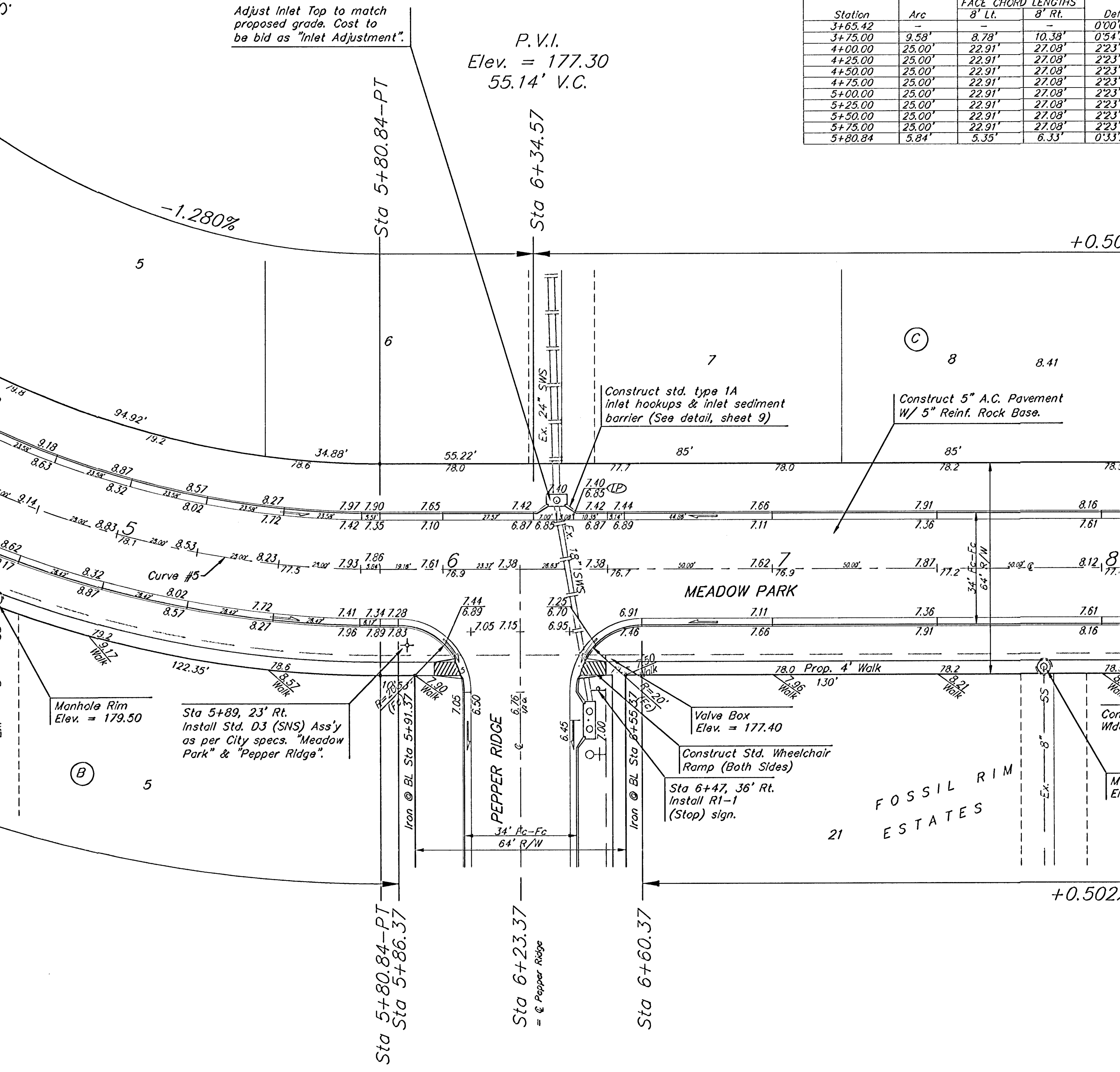

Construct std. type 1A inlet hookups & inlet sediment barrier (See detail, sheet 9)

Construct 5" A.C. Pavement W/ 5" Reinf. Rock Base.

Sta 5+89, 23' Rt. Install Std. D3 (SNS) Ass'y as per City specs. "Meadow Park" & "Pepper Ridge".

Valve Box Elev. = 177.40  
 Construct Std. Wheelchair Ramp (Both Sides)

Sta 6+47, 36' Rt. Install R1-1 (Stop) sign.

FOSSIL RIM  
 21 ESTATES