

PLAN	CHECKED	DATE
	CHECKED	
BY		

PROFILE	CHECKED	DATE
	CHECKED	
BY		

Saved: 04-03-2017 5:07:05 PM by: BUS
 Plot Scale: 1" = 10'-0" (Horizontal) 1" = 10'-0" (Vertical)
 U:\Projects\2017\15138\004\Drawings\15138-004-11C-SWS LINE NO. 1-SOUTH ENTRANCE

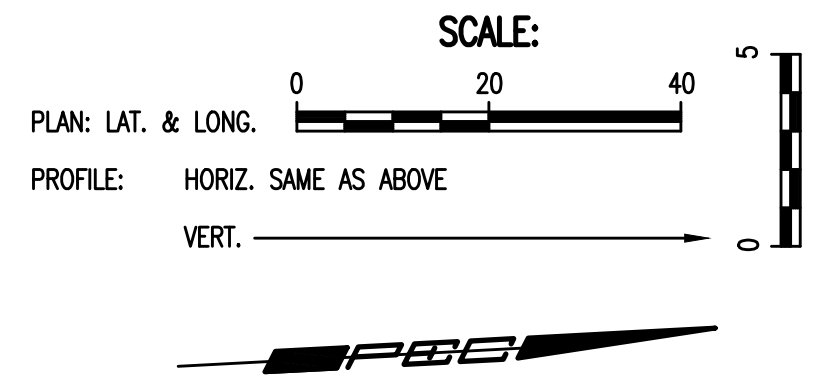
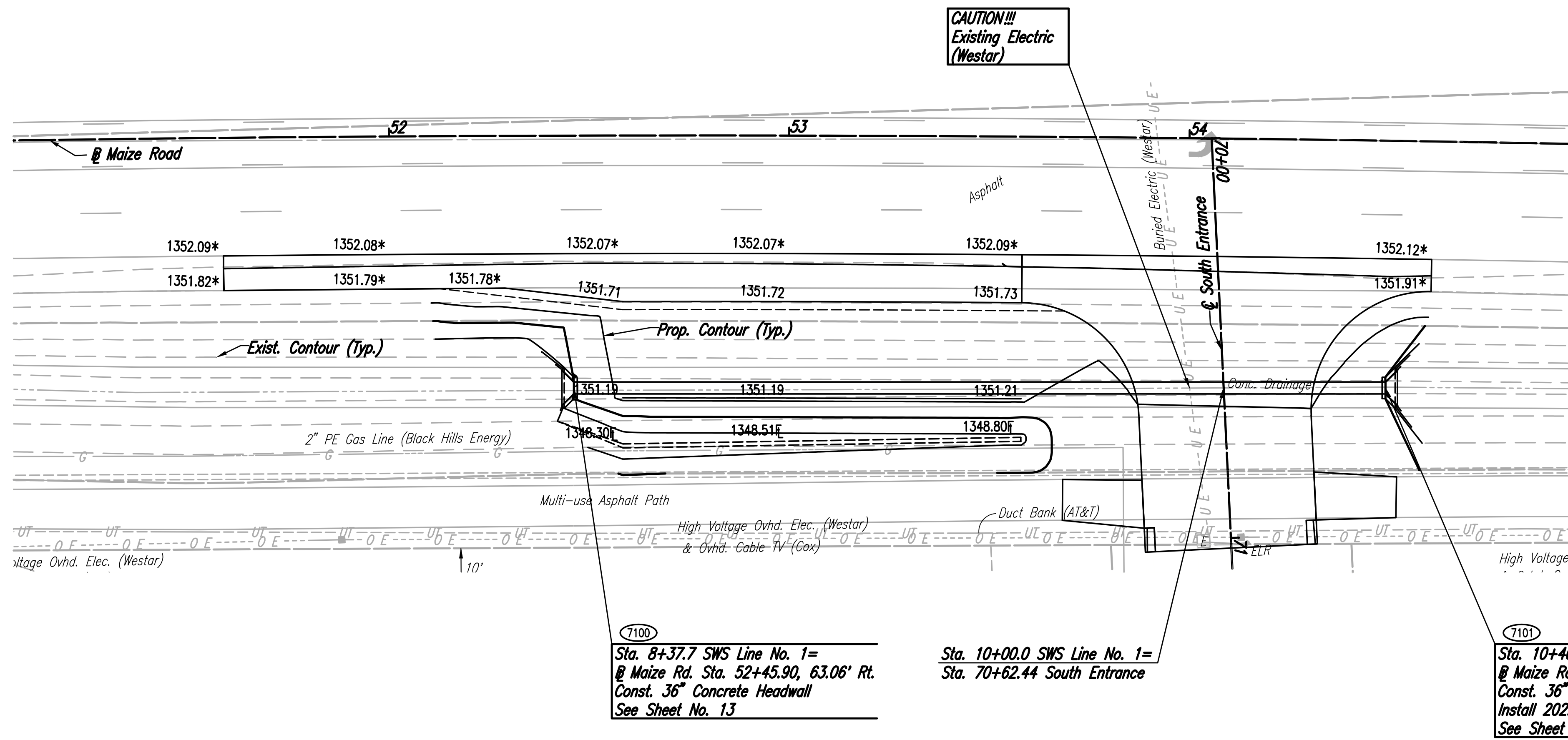

COORDINATE LIST		
POINT	NORTH	EAST
7100	9,242.4416	5,169.8444
7101	9,444.8697	5,180.5726

NOTE (A): ALL STORM SEWER EXCAVATION UNDER PAVEMENT SHALL BE SAND FILLED AND FLUSHED (JETTED AND VIBRATED) WITH WATER PER THE REQUIREMENTS LISTED IN THE STANDARD SPECIFICATIONS FOR THE CITY OF WICHITA. THE SAND FILL SHALL START AT THE TOP OF IMPROVED BEDDING (PER STANDARD SPECIFICATIONS) AND BE BROUGHT UP UNIFORMLY TO BOTTOM OF PROPOSED CRUSHED ROCK BASE.



7100
 Sta. 8+37.7 SWS Line No. 1=
 @ Maize Rd. Sta. 52+45.90, 63.06' Rt.
 Const. 36" Concrete Headwall
 See Sheet No. 13

Sta. 10+00.0 SWS Line No. 1=
 Sta. 70+62.44 South Entrance

7101
 Sta. 10+40.4 SWS Line No. 1=
 @ Maize Rd. Sta. 54+49.87, 61.78' Rt.
 Const. 36" Concrete Headwall
 Install 202.7 L.F. 36" RCP (S)
 See Sheet No. 13

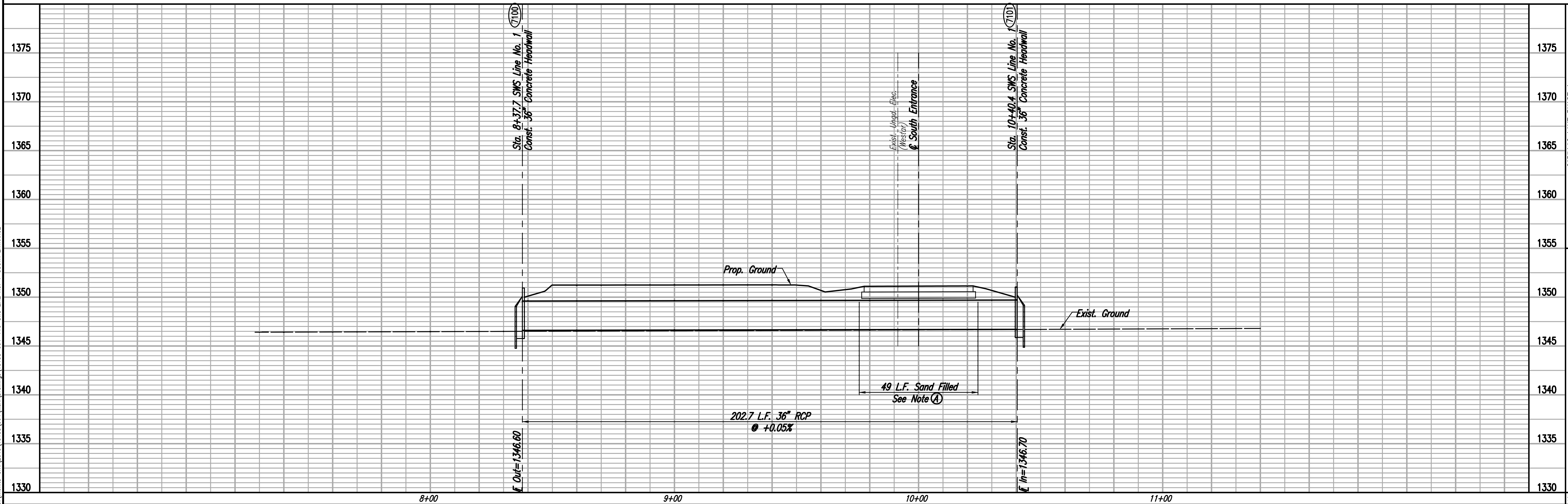

CADILLAC LAKE PHASE 1
 MAIZE ROAD TURNING LANES

SWS LINE NO. 1 - SOUTH ENTRANCE

GARY JANZEN, P.E. - CITY ENGINEER
 CITY OF WICHITA PROJECT NO. 472-55237

PROFESSIONAL ENGINEERING CONSULTANTS, P.A.
 303 SOUTH TOPEKA WICHITA, KS 67202
 316-262-2691 www.pec1.com

PEC

Designed By: BMM
 Drawn By: BUS

Job No.: 35-15138-004
 Date: April 2017