

6119 @ Sta. 57+89.27 Maize Road=  
 @ Sta. 75+00.00 North Entrance

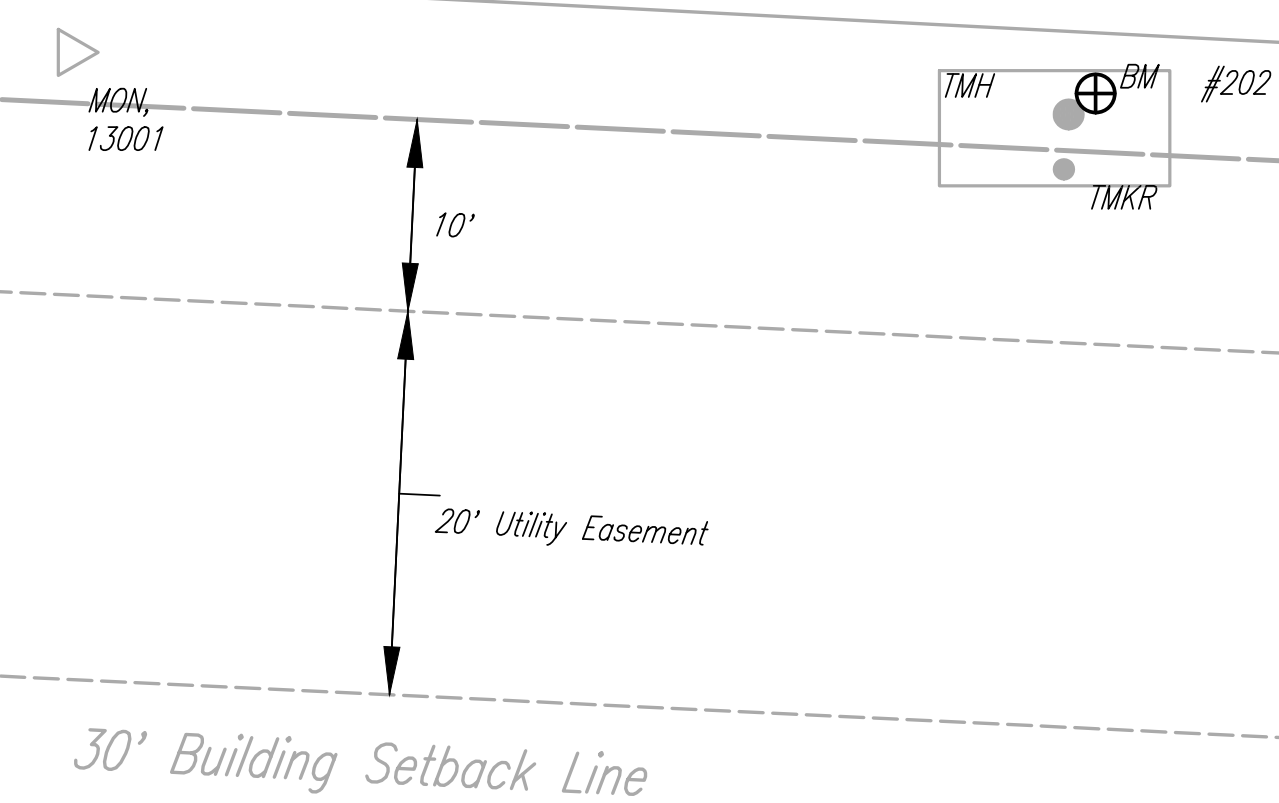
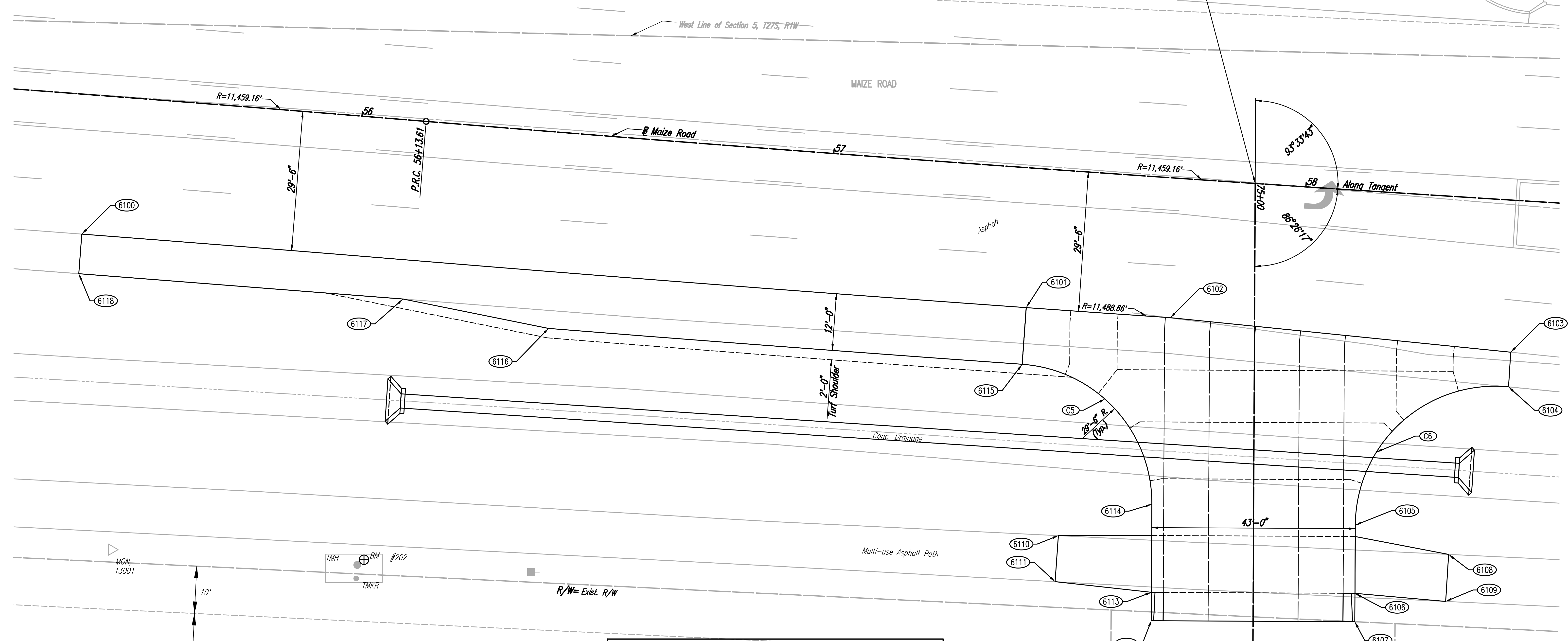

COORDINATE LIST					
POINT	NORTH	EAST	STATION	OFFSET	DESCRIPTION
6100	9,539.5881	5,155.0542	55+42.87	29.50' RT.	EDGE OF PAVEMENT
6101	9,739.1332	5,170.5834	57+42.87	29.50' RT.	EDGE OF PAVEMENT
6102	9,769.5959	5,172.7151	57+73.27	29.50' RT.	EDGE OF PAVEMENT P.I.
6103	9,841.5031	5,180.0030	58+45.37	32.08' RT.	EDGE OF PAVEMENT
6104	9,841.0467	5,187.3325	58+45.37	39.42' RT.	EDGE OF PAVEMENT
6105	9,808.6624	5,216.5460	75+72.08	21.50' LT.	EDGE OF PAVEMENT
6106	9,808.5915	5,230.9457	75+86.48	-21.50' LT.	TOP OF CURB
6107	9,808.5620	5,236.9456	75+92.48	21.50' LT.	TOP OF CURB
6108	9,828.3884	5,222.7223	75+78.18	41.26' LT.	EDGE OF PATH
6109	9,827.7607	5,232.6580	75+88.10	40.68' LT.	EDGE OF PATH
6110	9,745.9234	5,218.7597	75+74.60	41.23' RT.	EDGE OF PATH
6111	9,745.2389	5,228.4870	75+84.33	41.86' RT.	EDGE OF PATH
6112	9,765.5625	5,236.7341	75+92.48	21.50' RT.	TOP OF CURB
6113	9,765.5921	5,230.7342	75+86.48	21.50' RT.	TOP OF CURB
6114	9,765.6836	5,212.1254	75+67.87	21.50' RT.	EDGE OF PAVEMENT
6115	9,738.2807	5,182.5549	57+42.87	41.50' RT.	EDGE OF PAVEMENT
6116	9,638.2047	5,174.9849	56+42.87	41.50' RT.	EDGE OF PAVEMENT
6117	9,607.4698	5,168.7733	56+11.83	37.80' RT.	EDGE OF PAVEMENT
6118	9,538.9491	5,163.4192	55+42.87	37.89' RT.	EDGE OF PAVEMENT
6119	9,787.5172	5,144.3638	57+89.27	00.00' RT.	MAIZE ROAD BASELINE

Curve Data (C5)  
 $\Delta=86^{\circ}12'22''$   
 $D=194^{\circ}13'23''$   
 $R=29.50'$   
 $T=27.61'$   
 $L=44.39'$   
 $E=10.90'$

Curve Data (C6)  
 $\Delta=95^{\circ}19'47''$   
 $D=194^{\circ}13'23''$   
 $R=29.50'$   
 $T=32.38'$   
 $L=49.08'$   
 $E=12.20'$

6100 = COORDINATE POINT NO.  
 SEE SHEET NO. 3 FOR PLAT COORDINATES

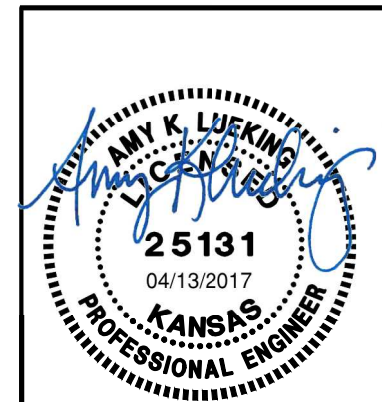

No.	Revision	By	Date
CADILLAC LAKE PHASE 1 MAIZE ROAD TURNING LANES <b>GEOMETRY PLAN-NORTH ENTRANCE</b> GARY JANZEN, P.E. - CITY ENGINEER CITY OF WICHITA PROJECT NO. 472-85237 PROFESSIONAL ENGINEERING CONSULTANTS, P.A. 303 SOUTH TOPEKA WICHITA, KS 67202 316-262-2691 www.pec1.com			
Designed by	BMM	Job No.	35-15138-004
Drawn by	BJS	Date	April 2017
			Sht. 07 of 28

Sowed 04-03-2017 5:00:27 PM by BJS  
 Plot Scale 1:1 04-13-2017 7:55:51 AM by BJS  
 U:\Wichita-Civil\2015\15138\004\Main\Drawings\15138-004-07C-GEOMETRY PLAN-NORTH ENTRANCE