

Southeast Corner of Intersection

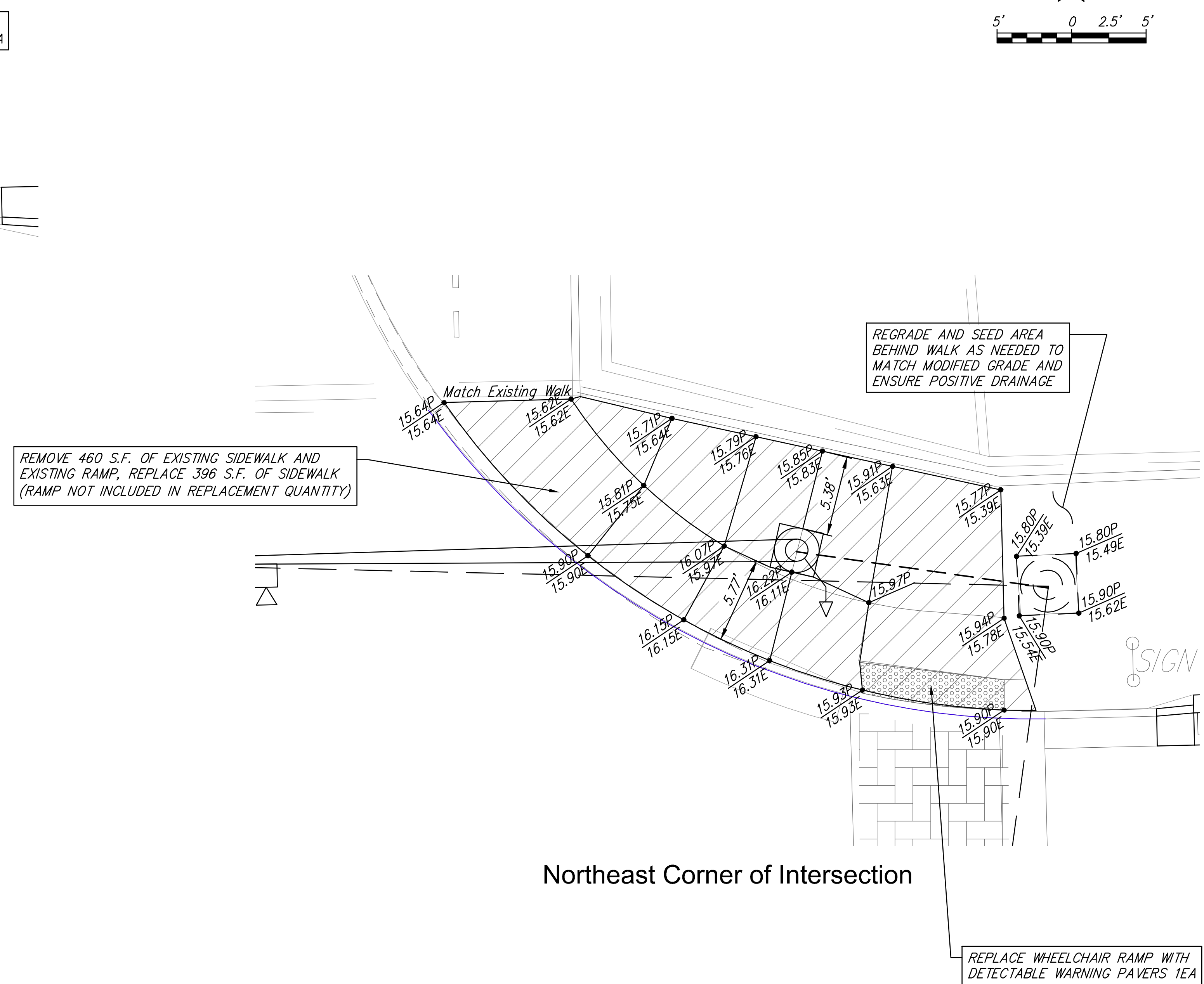

Northeast Corner of Intersection

**NOTES:**

1. ADD 1300.00 TO ALL SPOT ELEVATIONS TO CONVERT TO NAVD88 DATUM.  
 16.00P = PROPOSED GRADE  
 15.95E = EXISTING GRADE
2. THE CONTRACTOR SHALL VERIFY THAT SIDEWALK AND WHEELCHAIR RAMPS MEET ALL APPLICABLE AND CURRENT ADA STANDARDS.
3. ALL AREAS TO BE REGRADED SHALL BE SEEDED BY CONTRACTOR. CONTRACTOR RESPONSIBLE FOR ALL SEDIMENT AND EROSION CONTROL.

F:\Projects\Projects 4800-4899\4811T (Harry & 127th Signals)\4811T Engineering Base.dwg

<b>Harry &amp; 127th Sidewalk Elevations</b>		DATE 3-7-2017
	<p><b>RUGGLES &amp; BOHM</b>          ENGINEERING   SURVEYING   LANDSCAPE ARCHITECTURE   GOVERNMENT          924 NORTH MAIN WICHITA, KANSAS 67203 P (316) 264-8008 F (316) 264-4621          WWW.RBKANSAS.COM</p>	DESIGN MTD
		DRAWN MTD
PROJECT NUMBER <b>472-85337</b>		REVIEW KWL
DRAWING FILE <b>4811T Engineering Base [Sidewalk Elevations]</b>		SHEET <b>4</b>
		OF <b>9</b>