

WATER MAIN AND SANITARY SEWER IMPROVEMENTS

TO SERVE

# FAIRMOUNT PARK ADDITION

FOR

SEDGWICK COUNTY, KANSAS

THE CITY OF WICHITA,

Gary Janzen, P.E., City Engineer

Index

1	Title Sheet
2	Notepage
3-4	Sanitary Sewer Line 1
5	Sanitary Sewer Line 2
6-9	Water Line 1
10	Water Line 2
11	Water Line 3
12	Water Line 4
13-17	Standard Details
18	Water Meter Table & Paving Details
19	Wheel Chair Ramp Details
20-24	Erosion Control Details

VICINITY MAP

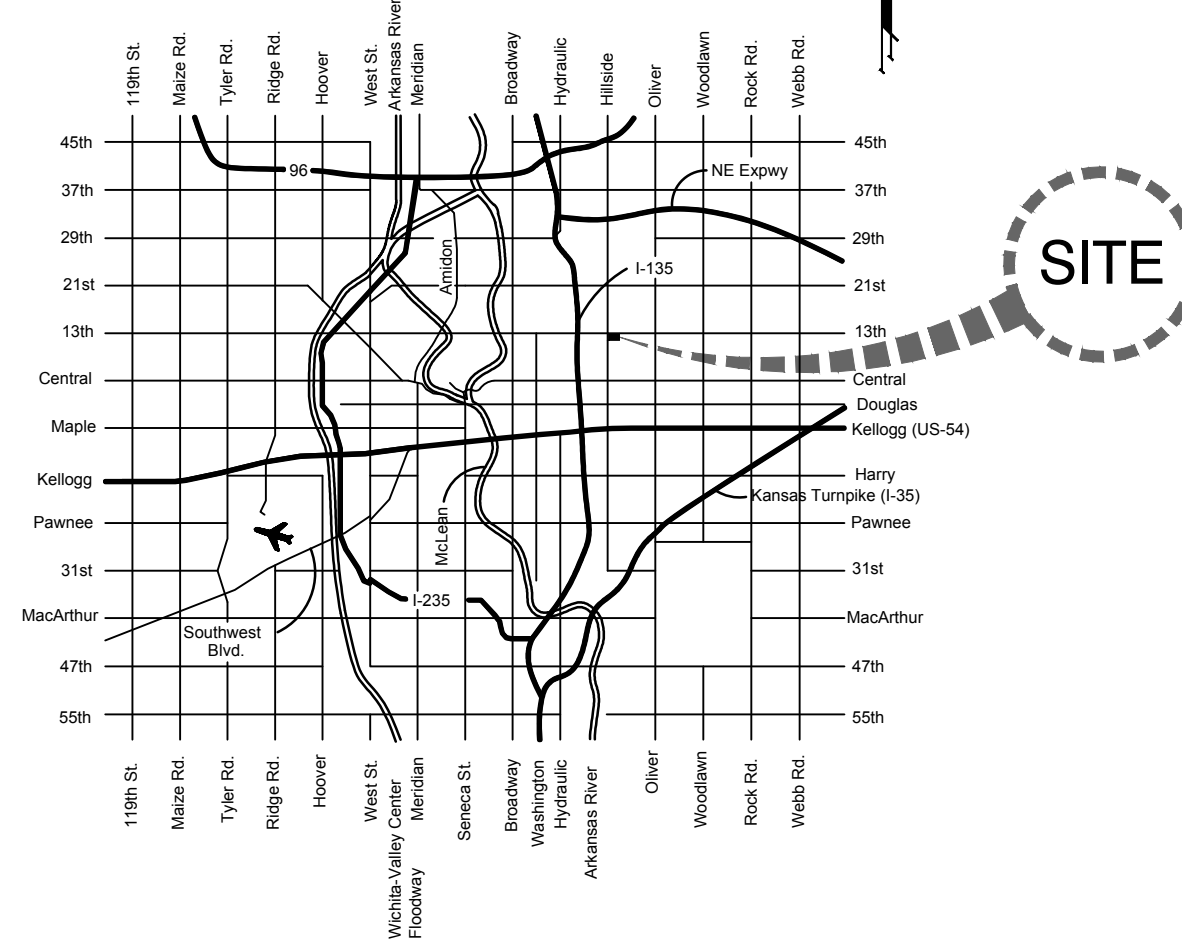

**WATER**  
City Project No. - 448-90766  
O.C.A. No. - 636438

**SANITARY SEWER**  
City Project No. - 468-85158  
O.C.A. No. - 620865

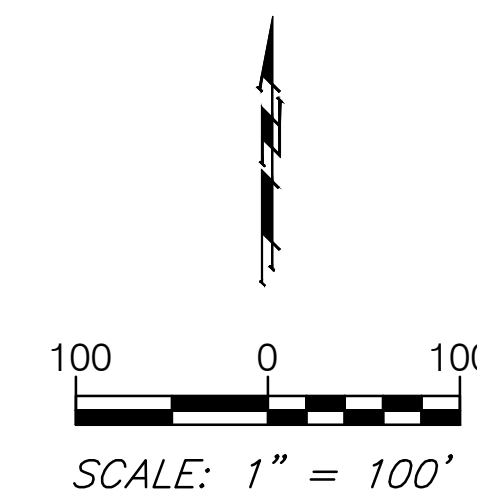

**BENCHMARKS:**

- BM #1 - Chiseled "X" in the Northwest Corner of the South Drive to 1305 N. Hillside.  
Elev. = 1358.70 (NAVD 88)
- BM #2 - Chiseled "X" in the South Lane of 12th Street North Just West of the Walk to 3501 E. 12th Street North.  
Elev. = 1358.70 (NAVD 88)
- BM #3 - Mag Nail Near the North High Edge of 12th Street North 1/2 Block East of Hillside.  
Elev. = 1361.11 (NAVD 88)
- BM #4 - Chiseled "X" in the Sidewalk on the West Side of Vassar Avenue 12' South of the Walk to 1337 N. Vassar.  
Elev. = 1376.30 (NAVD 88)
- BM #5 - Chiseled "X" at the Centerline of the Wheel Chair Ramp in the West Side of the Valley Gutter at Yale Avenue.  
Elev. = 1360.92 (NAVD 88)
- BM #6 - Chiseled "□" on the Top of Curb at the Southwest Curb Return of the Holyoke Avenue Valley Gutter.  
Elev. = 1367.28 (NAVD 88)
- BM #7 - Chiseled "□" on the Top of Curb at the Northwest Curb Return of the Driveway to 3237 E. 12th Street North.  
Elev. = 1357.22 (NAVD 88)

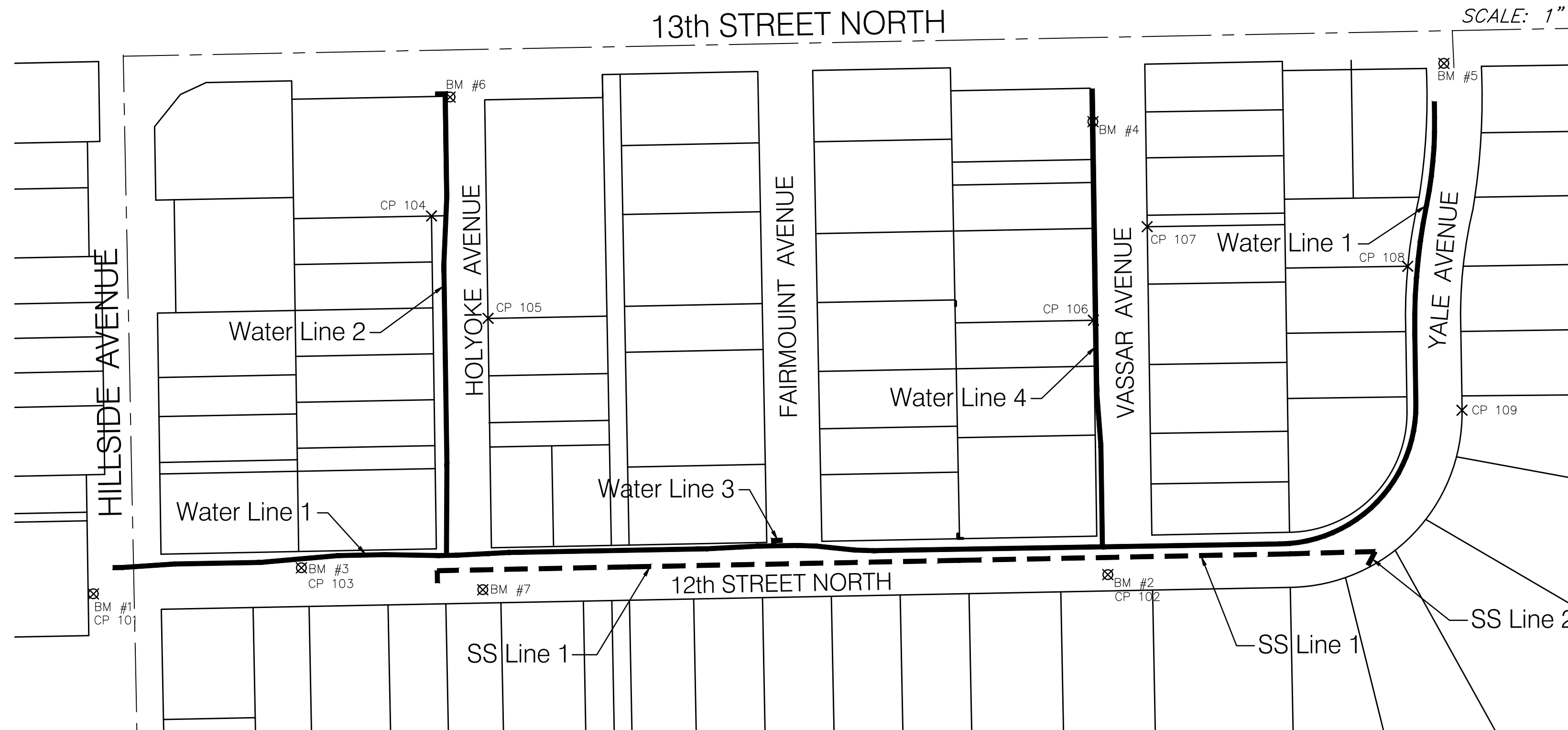

**CONTROL POINTS:**

- |  |   |
|--|---|
| CP #101 - Chiseled "X"<br>BL Sta. 0+55.55, 11.93' Rt.<br>N-1693247.61<br>E-1659711.36          | CP #106 - 1" Steel Bar<br>BL Sta. 3+64.81, 30.06' Lt.<br>N-1693545.53<br>E-1660800.89             |
| CP #102 - Mag Nail<br>BL Sta. 11+60.98, 12.33' Rt.<br>N-1693268.52<br>E-1660816.59             | CP #107 - #4 Rebar w/ Baughman Cap<br>BL Sta. 4+65.41, 30.28' Rt.<br>N-1693647.02<br>E-1660859.72 |
| CP #103 - Chiseled "X"<br>BL Sta. 2+82.67, 12.02' Lt.<br>N-1693275.94<br>E-1659937.97          | CP #108 - 1/2" Iron Pipe<br>BL Sta. 16+97.21, 30.13' Lt.<br>N-1693533.31<br>E-1661141.03          |
| CP #104 - #4 Rebar w/ Savoy Cap<br>BL Sta. 4+92.52, 29.89' Lt.<br>N-1693659.37<br>E-1660079.29 | CP #109 - #5 Rebar<br>BL Sta. 16+10.58, 29.96' Rt.<br>N-1693447.58<br>E-1661202.40                |
| CP #105 - Nail in 1" Iron Pipe<br>BL Sta. 3+79.92, 29.99' Rt.<br>N-1693547.67<br>E-1660141.34  |   |



May 2017