

COW Benchmark at the Intersection of Meridian and 53rd St N, NE Corner, Top of Concrete Headwall.  
 44' North of Centerline  
 37' East of Centerline  
 50.90' NE of Section Corner  
 9' NE of and radial to curb  
 26' East of Section Line  
 Elev. = 1331.37 NGVD29

COW Benchmark at the intersection of Meridian and Keywest, NW Corner,  
 59' West of Centerline  
 32.3' North of Centerline  
 11.8' North of N curb line of Keywest  
 4.8' NW of center of Power Pole  
 Elev. = 1329.36 NGVD29

CBB Northlakes LLC  
 4647 N Meridian  
 Wichita, KS 67204-2401

Install 70 S.Y. Heavy Stone Rip-rap on side slope of channel as shown. See detail this sheet.

Remove Trees only as necessary for channel construction. All trees not in direct conflict with proposed channel shall remain and shall be protected from damage. Any trees that need trimmed shall be side trimmed with a chainsaw.

Scale: 1" = 20'

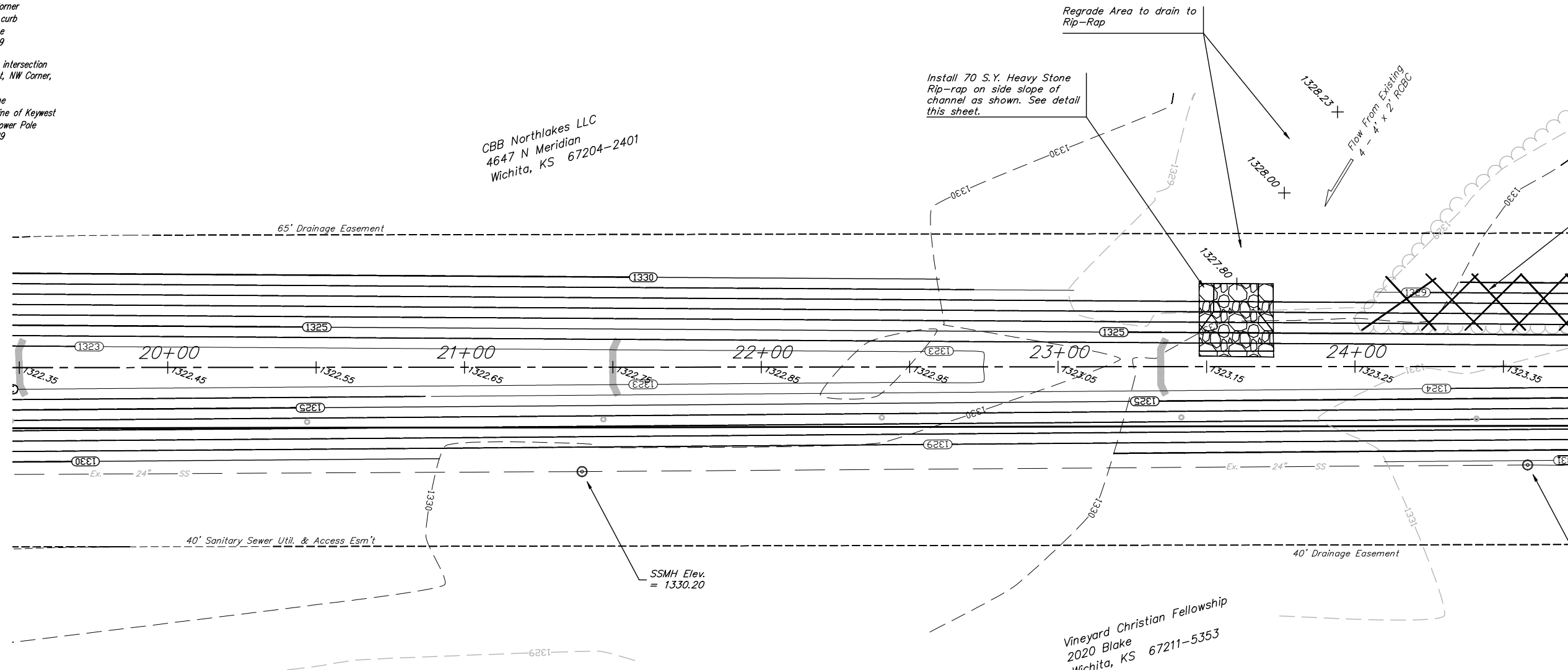

Vineyard Christian Fellowship  
 2020 Blake  
 Wichita, KS 67211-5353

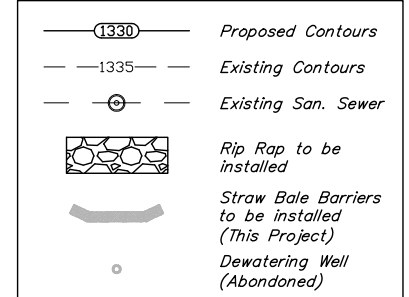
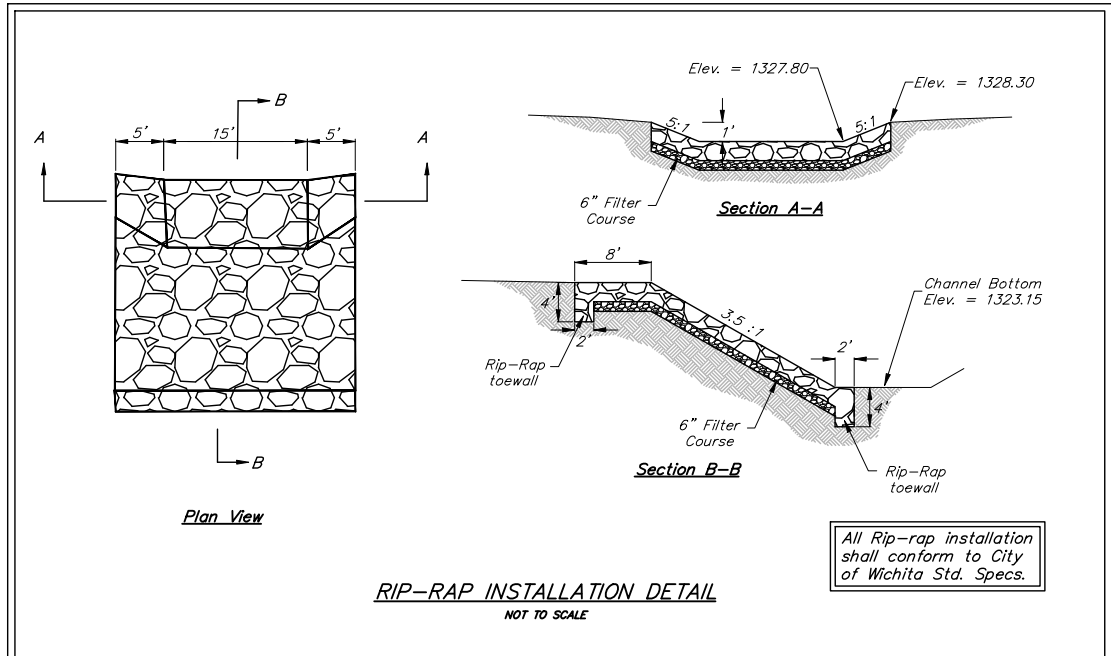

EROSION CONTROL MEASURE	UNITS	QUANTITY
INSTALL STRAW BALE BARRIER	EA	2
INSTALL HEAVY-STONE RIP RAP	SY	70

QUANTITIES ARE FOR INFORMATION ONLY!  
 CONTRACTOR SHALL VERIFY QUANTITIES PER FINAL BID QUANTITY SHEET.

**Baughman** Notgate Offsite Drainage  
**Channel Plan**  
 Storm Water Drain #307

Baughman Company, P.A. 315 8th St. Wichita, KS 67211 P 316-262-7771 F 316-262-0149  
 ENGINEERING | SURVEYING | PLANNING | LANDSCAPE ARCHITECTURE

PROJECT NUMBER 468-84253	DESIGN RDM/ABG	DRAWN RDM
REVISIONS:	APPROVED ABG	DATE 3-14-07
	SCALE Noted	
	SHEET	

**6 OF 22**

Northgate\OFFSITE CHANNEL.dwg