

SCALE:
HORIZONTAL: 1" = 20'
VERTICAL: 1" = 5'

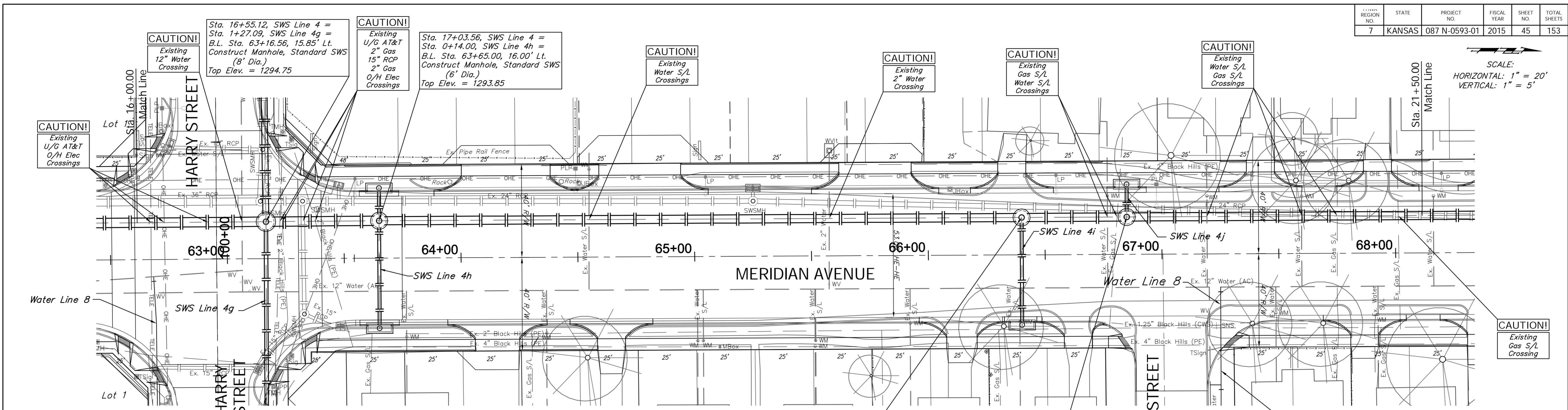

BENCHMARKS:
 BM #3 - City of Wichita Benchmark Disc in the Southeast Corner of the Intersection of Meridian and Harry, 29.5' South and 61' East of the Centerline of Both. Elev. = 1294.17 (NAVD 88)
 BM #4 - Chiseled "a" on the Top of Curb on the South Side of Figg Street, 80± East of Centerline of Meridian. Elev. = 1295.08 (NAVD 88)

Built per plan

Sta. 19+78.56, SWS Line 4 = Sta. 0+00.00, SWS Line 4i = B.L. Sta. 66+40.00, 16.00' Lt. Construct Manhole, Standard SWS (6' Dia.) Top Elev. = 1294.67

Sta. 20+23.56, SWS Line 4 = Sta. 0+14.00, SWS Line 4j = B.L. Sta. 66+85.00, 16.00' Lt. Construct Manhole, Standard SWS (6' Dia.) Top Elev. = 1294.85

