

BENCHMARK:
 BM #5 - Chiseled "b" on the Top of Curb on the South Side of
 Dooley Street, 80± East of Centerline of Meridian.
 Elev. = 1296.20 (NAVD 88)

REGION NO.	STATE	PROJECT NO.	FISCAL YEAR	SHEET NO.	TOTAL SHEETS
7	KANSAS	087 N-0593-01	2015	46	153

SCALE:
 HORIZONTAL: 1" = 20'
 VERTICAL: 1" = 5'

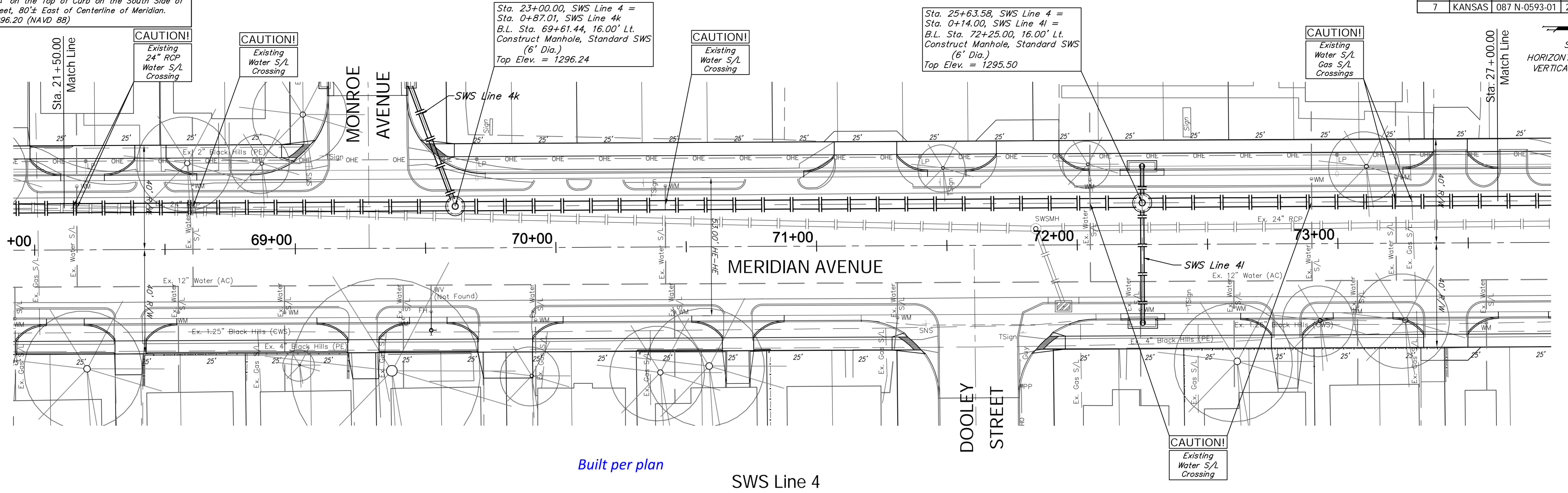

Built per plan
 SWS Line 4



Drawing File: E:\Projects\Meridian Orient to McCormick\Civil 3d\Meridian Base.dwg (SWS 10)
 Project No: 1004-E-93 CAPITAL IMPROVEMENT PROJECT

Design: TPV
 Drawn: STAFF
 Approved: TPV
 Scale: NOTED

MERIDIAN AVENUE SWS PLAN & PROFILE
 SWS Line 4 - Sta. 21+50.00 to Sta. 27+00.00
 MERIDIAN AVENUE - PAVINE AVENUE TO MCCORMICK AVENUE

Baughman Company, P.A.
 315 Ellis St., Wichita, KS 67211 P 316.262.7271 F 316.262.0149
 ENGINEERING | SURVEYING | PLANNING | LANDSCAPE ARCHITECTURE

May 2015
 SHEET 46 OF 153