

BENCHMARKS:
 RR spike in asphalt, SW COR., N1/2, SW1/4, Sec. 34, TWP. 26-S, R-2-E. Elev. = 1400.59 NAVD88
 RR spike in E. face of power pole, 174± N. of S. line, N1/2, SW1/4 & 49± E. of W. line, SW1/4, Sec. 34, TWP. 26-S, R-2-E. Elev. = 1398.64 NAVD88
 RR spike in S. face of power pole, 294± S. of N. line, SW1/4, & 48± E. of W. line, SW1/4, Sec. 34, TWP. 26-S, R-2-E. Elev. = 1386.14 NAVD88

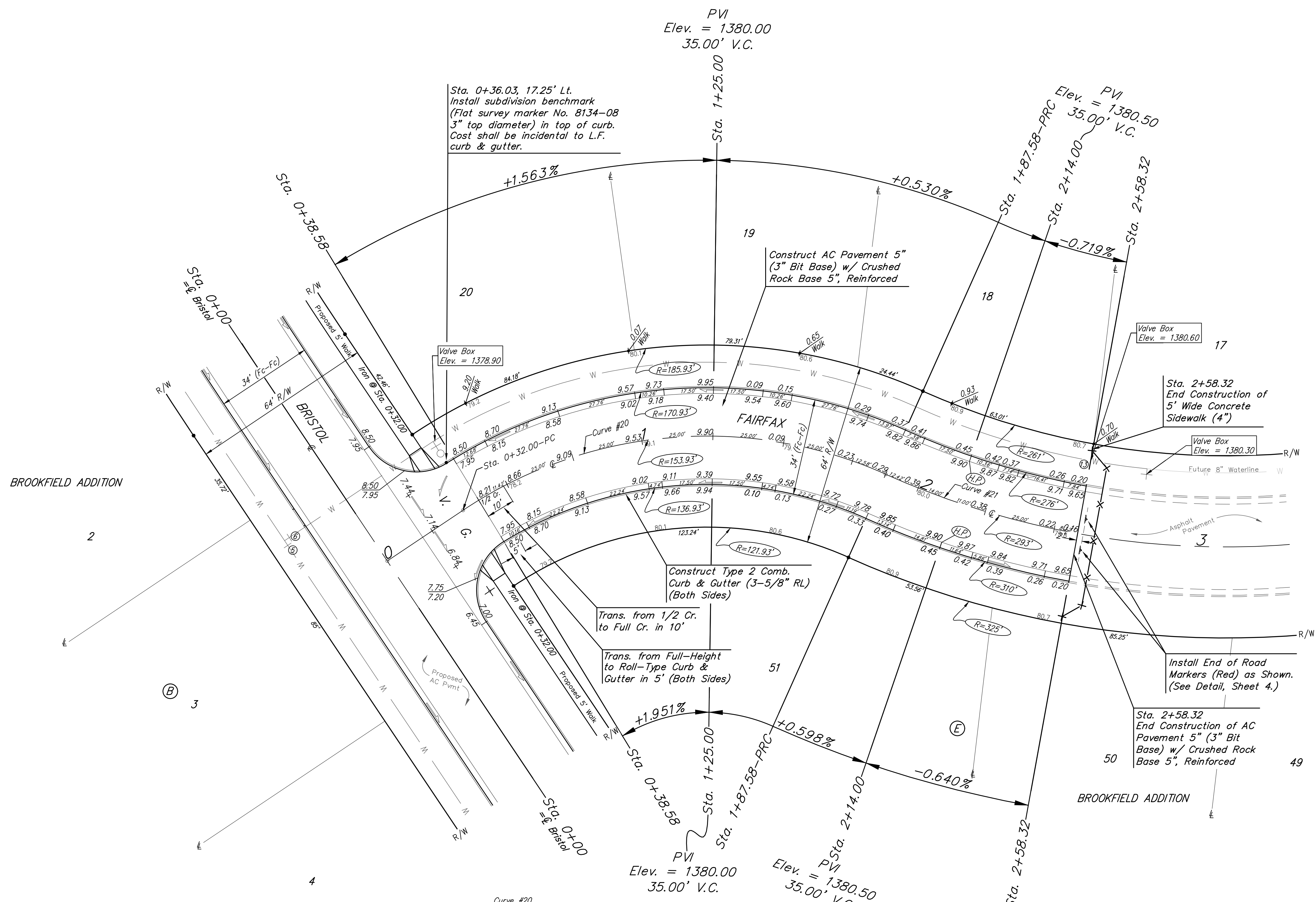
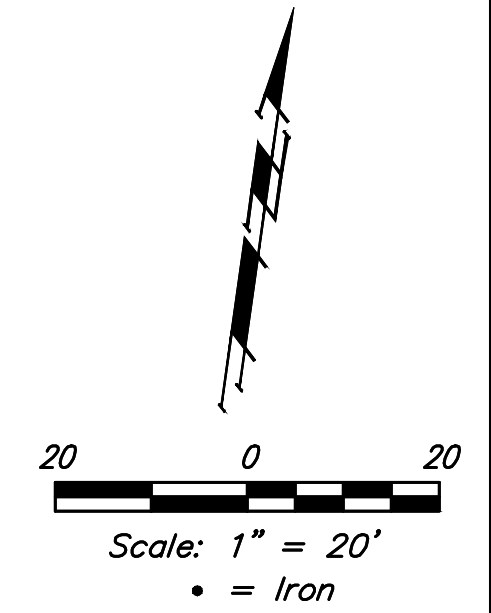

VALVE LOCATION TABLE

VALVE NUMBER	BASILINE STATION	OFFSET DISTANCE	OFFSET DIRECTION
1	6+41.51	26'	Lt
2	9+29.87	28'	Lt
3	11+31.19	24'	Lt
4	15+06.25	24'	Lt
5	20+08.15	26'	Lt
6	20+10.16	24'	Lt
7	22+49.32	28'	Lt
8	24+78.57	24.15'	Lt
9	26+25.10	37.5'	Lt.
10	3+42.25	24'	Lt.
11	5+12.40	26'	Lt.
12	4+67.97	23'	Lt.
13	2+58.32	26'	Lt.
14	10+81.63	26'	Lt.
15	0+55.47	22'	Lt.
16	5+72.45	23'	Lt.

SUBDIVISION BENCH MARKS

Street & Station	Location Description	Elevation
Brookview 7+97.63, 17.25' Lt.	Adjacent to Fire Hydrant at SW Corner of Lot 39, Block B	
Brookfield 16+70.20, 17.25' Lt.	Adjacent to Fire Hydrant at SE Corner of Lot 5, Block B	
Crest Ct 0+37.00, 14.25' Lt.	Adjacent to Fire Hydrant at East End of the North Return of Crest St & Crest Ct	
Brookview Ct 0+46.52, 25.75' Lt.	Adjacent to Fire Hydrant at South End of the East Return of Brookview & Brookview Ct	
Brookview Cir 4+17.29, 14.25' Lt.	Adjacent to Fire Hydrant at SW Corner of Lot 55, Block E	
Fairfax 0+36.03, 17.25' Lt.	Adjacent to Fire Hydrant at East End of the North Return of Bristol & Fairfax	

Curve #20
 Curve Data Based on Centerline
 Rad. = 153.93' Delta = 57°54'39" Tangent = 85.17'
 Arc = 155.58' L.C. = 149.04' Def./Ft. = 11.16676 Min.

Station	Arc	Face Chord Length		Defl.	Total Defl.
		8' Left	8' Right		
0+32.00	-	-	-	0'00"00"	0'00"00"
0+38.58	6.58'	7.65'	5.51'	1'13'29"	1'13'29"
0+50.00	11.42'	13.27'	9.56'	2'07'31"	3'21'00"
0+75.00	25.00'	29.03'	20.92'	4'39'10"	8'00'10"
1+00.00	25.00'	29.03'	20.92'	4'39'10"	12'39'20"
1+25.00	25.00'	29.03'	20.92'	4'39'11"	17'18'31"
1+50.00	25.00'	29.03'	20.92'	4'39'10"	21'57'41"
1+75.00	25.00'	29.03'	20.92'	4'39'10"	26'36'51"
1+87.58	12.58'	14.62'	10.53'	2'20'29"	28'57'20"

Curve #21
 Curve Data Based on Centerline
 Rad. = 293' Delta = 13°49'58" Tangent = 35.54'
 Arc = 70.74' L.C. = 70.57' Def./Ft. = 5.86632 Min.

Station	Arc	Face Chord Length		Defl.	Total Defl.
		8' Left	8' Right		
1+87.58	-	-	-	0'00"00"	0'00"00"
2+00.00	12.42'	11.36'	13.48'	1'12'52"	1'12'52"
2+25.00	25.00'	22.86'	27.12'	2'26'39"	3'39'31"
2+50.00	25.00'	22.86'	27.12'	2'26'40"	6'06'11"
2+58.32	8.32'	7.61'	9.03'	0'48'48"	6'54'59"

Baughman Brookfield Addition - Phase I
FAIRFAX Sta. 0+38.58 to Sta. 2+58.32

Baughman Company, P.A. 315 Ellis St. Wichita, KS 67211 P 316-262-7271 F 316-262-0149
 ENGINEERING | SURVEYING | PLANNING | LANDSCAPE ARCHITECTURE

PROJECT NUMBER 472-85344	DESIGN AEG	DRAWN JAK
REVISIONS:	APPROVED	DATE 6/30/17
	SCALE Noted	SHEET 16 OF 56

E:\Projects\Brookfield Addition_1604F190\Engineering\Phase I\STR_1608544\STR PLANS.dwg