

BENCHMARKS:
 RR spike in asphalt, SW COR., N1/2, SW1/4, Sec. 34, TWP. 26-S, R-2-E. Elev. = 1400.59 NAVD88
 RR spike in E. face of power pole, 174± N. of S. line, N1/2, SW1/4 & 49± E. of W. line, SW1/4, Sec. 34, TWP. 26-S, R-2-E. Elev. = 1398.64 NAVD88
 RR spike in S. face of power pole, 294± S. of N. line, SW1/4, & 48± E. of W. line, SW1/4, Sec. 34, TWP. 26-S, R-2-E. Elev. = 1386.14 NAVD88

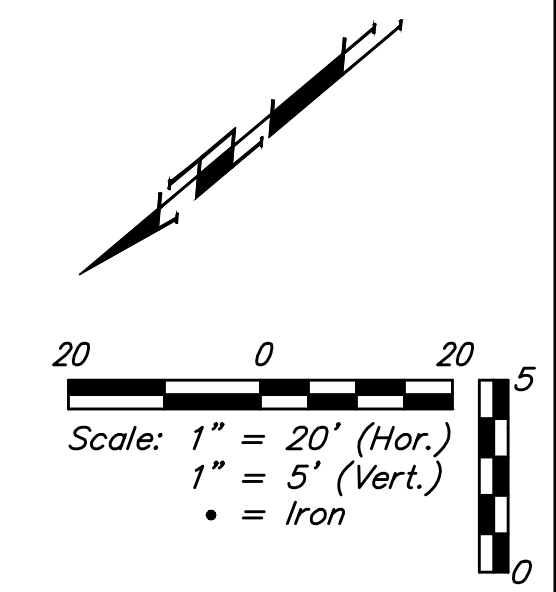
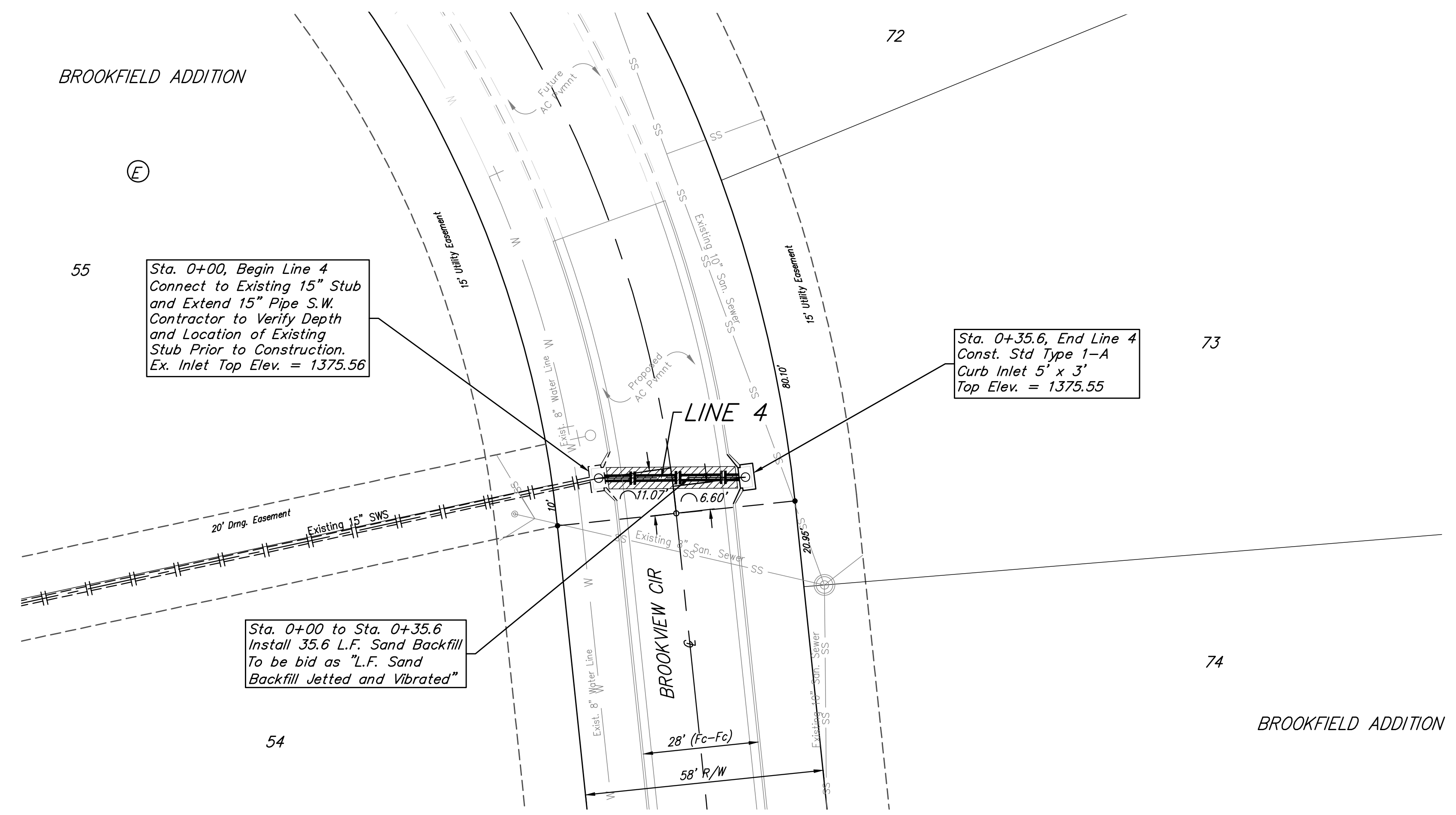

Sta. 0+00, Begin Line 4
 Connect to Existing 15" Stub
 and Extend 15" Pipe S.W.
 Contractor to Verify Depth
 and Location of Existing
 Stub Prior to Construction.
 Ex. Inlet Top Elev. = 1375.56

Sta. 0+35.6, End Line 4
 Const. Std Type 1-A
 Curb Inlet 5' x 3'
 Top Elev. = 1375.55

Sta. 0+00 to Sta. 0+35.6
 Install 35.6 L.F. Sand Backfill
 To be bid as "L.F. Sand
 Backfill Jetted and Vibrated"

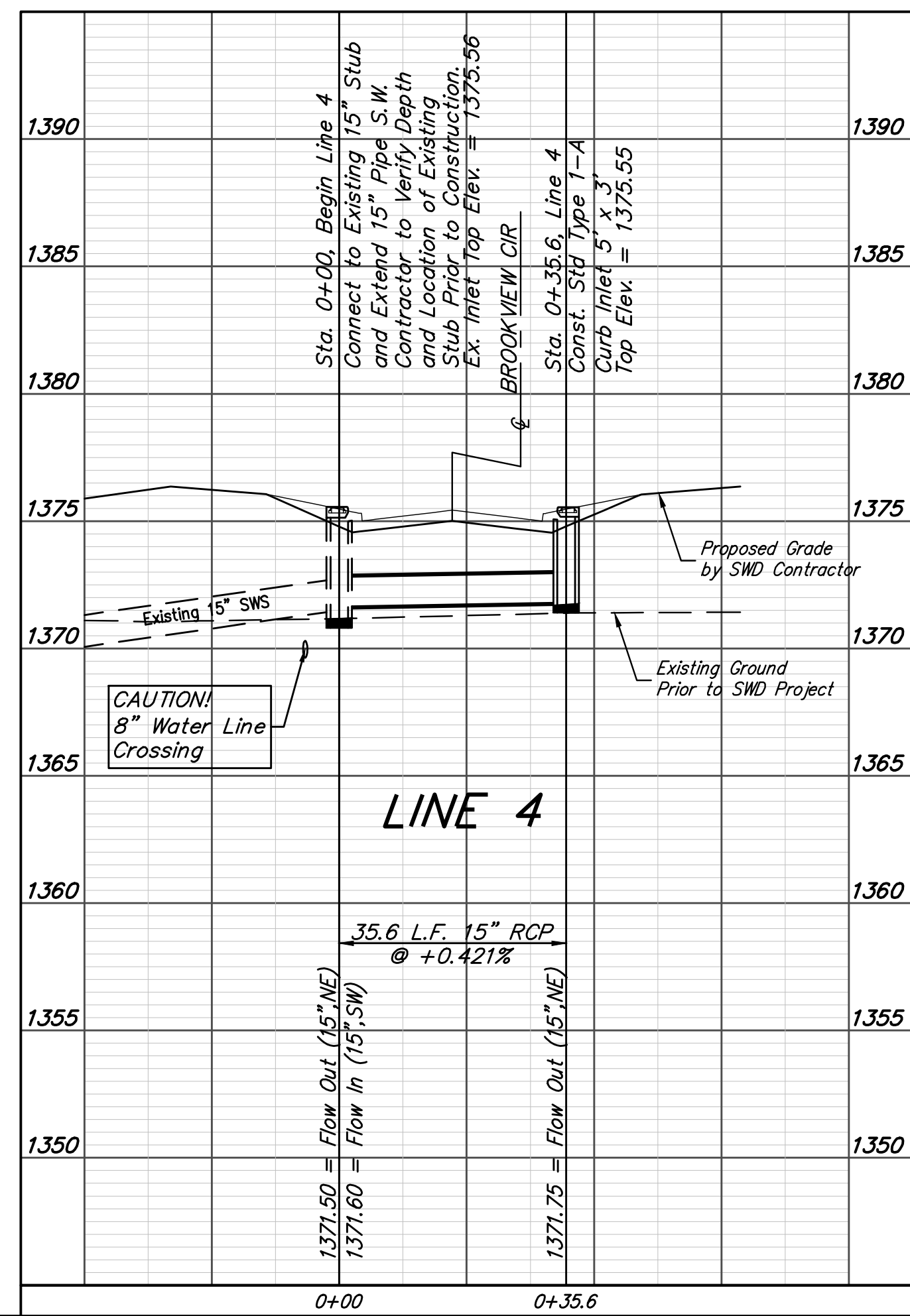

Baughman		Brookfield Addition - Phase I	
		LINE 4	
		Storm Water Sewer Improvements	
Baughman Company, P.A. 315 Ellis St. Wichita, KS 67211 P 316-262-7271 F 316-262-0149 ENGINEERING SURVEYING PLANNING LANDSCAPE ARCHITECTURE			
PROJECT NUMBER 472-85344	DESIGN AEG	DRAWN JAK	
REVISIONS:	APPROVED	DATE 6/30/17	
	SCALE Noted	SHEET	
			25 OF 56