

BENCHMARKS:
 RR spike in asphalt, SW COR., N1/2, SW1/4, Sec. 34, TWP. 26-S, R-2-E. Elev. = 1400.59 NAVD88

RR spike in E. face of power pole, 174± N. of S. line, N1/2, SW1/4 & 49± E. of W. line, SW1/4, Sec. 34, TWP. 26-S, R-2-E. Elev. = 1398.64 NAVD88

RR spike in S. face of power pole, 294± S. of N. line, SW1/4, & 48± E. of W. line, SW1/4, Sec. 34, TWP. 26-S, R-2-E. Elev. = 1386.14 NAVD88

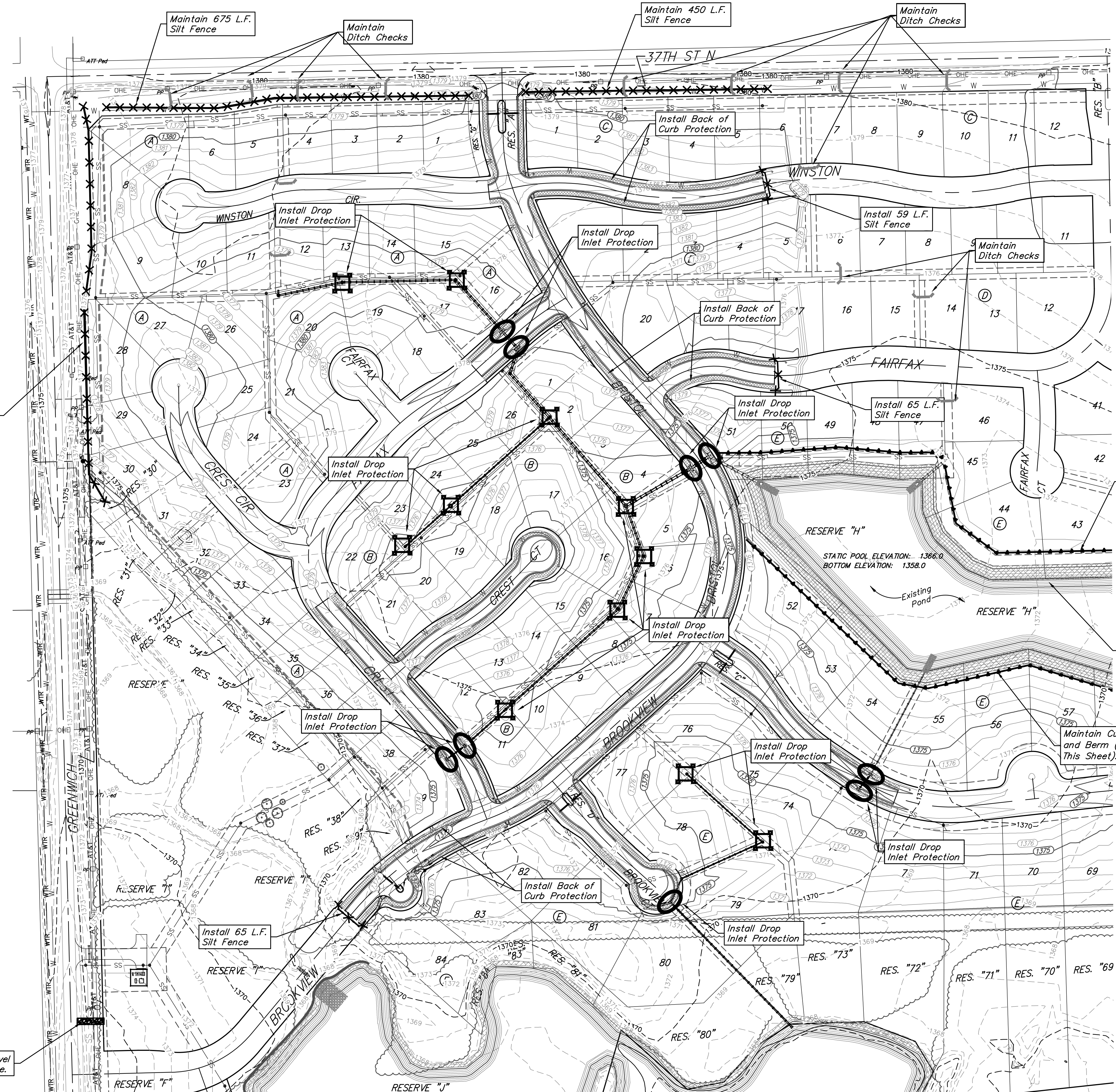

EROSION CONTROL PLAN LEGEND

- DROP INLET PROTECTION
- CURB INLET PROTECTION
- DITCH CHECKS
- SILT FENCING
- CUT-OFF TRENCH
- BACK OF CURB PROTECTION
- EROSION CONTROL MAT
- TEMPORARY DITCH

NO SCALE

Scale: 1" = 100'

Proposed Grade by SWD Contractor: 1364

Existing Ground: 1364

Cut-Off Trench Detail

NOTES:

- Contractor shall make sure all erosion control is in place before project is accepted. This plan represents the minimum standard. Any additional erosion control measures shall be installed by the Contractor as needed.
- Removal of Gravel Construction Entrance for pavement construction shall be included in bid item "Site Clearing"
- This Plan is Not To Be Used As A Comprehensive Grading Plan. All Spot Elevations Are Proposed & Subject To Change.

All areas disturbed during construction shall be seeded, mulched, and fertilized as per Cover Sheet General Notes.

EROSION CONTROL MEASURE	INSTALL	MAINTAIN
CONSTRUCTION ENTRANCE (EA)	0	1
CURB INLET BARRIER (EA)	9	0
BACK OF CURB PROTECTION (LF)	8,736	0
DROP INLET PROTECTION (EA)	11	0
DITCH CHECKS (EA)	0	14
SILT FENCE (LF)	189	1,875
MAINTAIN EROSION CONTROL BMP's (LS)	0	1

* ALL EXISTING BMP'S INCLUDING CONSTRUCTION ENTRANCE, SEDIMENT BARRIERS, SILT FENCE, CUT-OFF TRENCH, AND EROSION CONTROL MAT SHALL BE MAINTAINED AND REPAIRED IF NECESSARY.

Maintain 750 L.F. Silt Fence

Maintain 50'x12' Gravel Construction Entrance.

Maintain Cutoff Trench and Berm (See Detail, This Sheet).

Maintain Erosion Control Mat

Maintain Cutoff Trench and Berm (See Detail, This Sheet).

Baughman Brookfield Addition - Phase I
EROSION CONTROL

Baughman Company, P.A. 315 Ellis St. Wichita, KS 67211 P 316-262-7271 F 316-262-0149
 ENGINEERING | SURVEYING | PLANNING | LANDSCAPE ARCHITECTURE

PROJECT NUMBER 6/30/17	DESIGN AEG	DRAWN JAK
REVISIONS:	APPROVED	DATE 6/30/17
	SCALE Noted	SHEET 28 OF 56

E:\Projects\Brookfield Addition_1604P190\Engineering\Phase I\STR_1608E544\STR PLANS.dwg