

HSIP-N063(801)

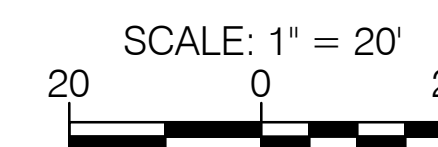

POINT TABLES:

Point Table			
Point #	Raw Description	Northing	Easting
700	BC	1901.3490	4832.9194
701	BC	1901.2437	4789.7625
702	BC	1915.9158	4789.7857
703	BC	1918.2158	4832.9194
704	BC	1919.3159	4853.9196
705	BC	1907.8491	4853.9196
706	BC	1907.8491	4889.9199
707	BC	1921.2456	4889.8525
708	BC	1906.8491	4906.9200
709	BC	1895.3490	4906.9200
710	BC	1895.3490	4940.9203
711	BC	1906.8491	4940.9203
712	BC	1900.3336	4968.0868
713	BC	1817.6999	4968.0868
714	BC	1820.5868	4972.1309
715	BC PT	1825.3166	4973.6535
716	BC PC	1896.2669	4973.3869
717	BC	1898.3164	4973.2956
718	BC PT	1900.3559	4973.0741
719	BC PC	1793.0575	4968.0868

Point Table			
Point #	Raw Description	Northing	Easting
720	BC	1790.2707	4972.1621
721	BC PT	1785.6082	4973.7852
722	BC PC	1774.5271	4973.7933
723	BC	1770.1358	4972.0205
724	BC PT	1767.4992	4968.0868
725	BC PC	1733.6187	5021.8543
726	BC	1736.4579	5019.0465
727	BC PT	1740.2993	5017.9567
728	BC PC	1798.8649	5017.7876
729	BC	1804.0030	5018.8475
730	BC PT	1808.3021	5021.8543
731	BC PC	1848.7463	5021.8543
732	BC	1853.0457	5018.7091
733	BC PT	1858.2463	5017.5551
734	BC	1900.3490	5017.3876
735	BC	1900.3490	5021.8543
736	BC	1986.7634	5191.5686
737	BC PC	1987.0411	5185.8893
738	BC	1988.8855	5179.6990
739	BC	1993.4831	5175.1621

Point Table			
Point #	Raw Description	Northing	Easting
740	BC	1993.4831	5198.5588
741	BC	1992.8131	5198.5665
742	BC	1991.9498	5196.5557
743	BC PC	1992.0029	5150.9944
744	BC	1989.7351	5146.8449
745	BC PT	1989.0964	5142.1594
746	BC	1989.5487	5133.2193
747	BC	1991.9831	5133.2510
748	BC	2024.4502	5023.8303
749	BC	2024.4616	5017.8339
750	BC PC	2113.6491	5017.5222
751	BC	2118.7671	5019.3481
752	BC PT	2121.5371	5024.0238
753	BC	1991.3831	4896.7533
754	BC	1984.7164	4896.7533
755	BC PC	1982.7502	4860.1950
756	BC	1984.9482	4852.3222
757	BC PT	1991.3831	4847.2819
758	BC PC	1991.3831	4819.7181
759	BC	1983.4444	4815.6978

Point Table			
Point #	Raw Description	Northing	Easting
760	BC PT	1979.9494	4807.5142
761	BC PC	1979.3203	4795.8261
762	BC	1982.5623	4786.5183
763	BC PT	1991.3831	4782.1205
764	BC PC	1991.3831	4750.2553
765	BC	1983.1102	4746.5076
766	BC	1979.3093	4738.2590
767	BC	1983.1910	4730.1839
768	BC PT	1991.3831	4726.5559

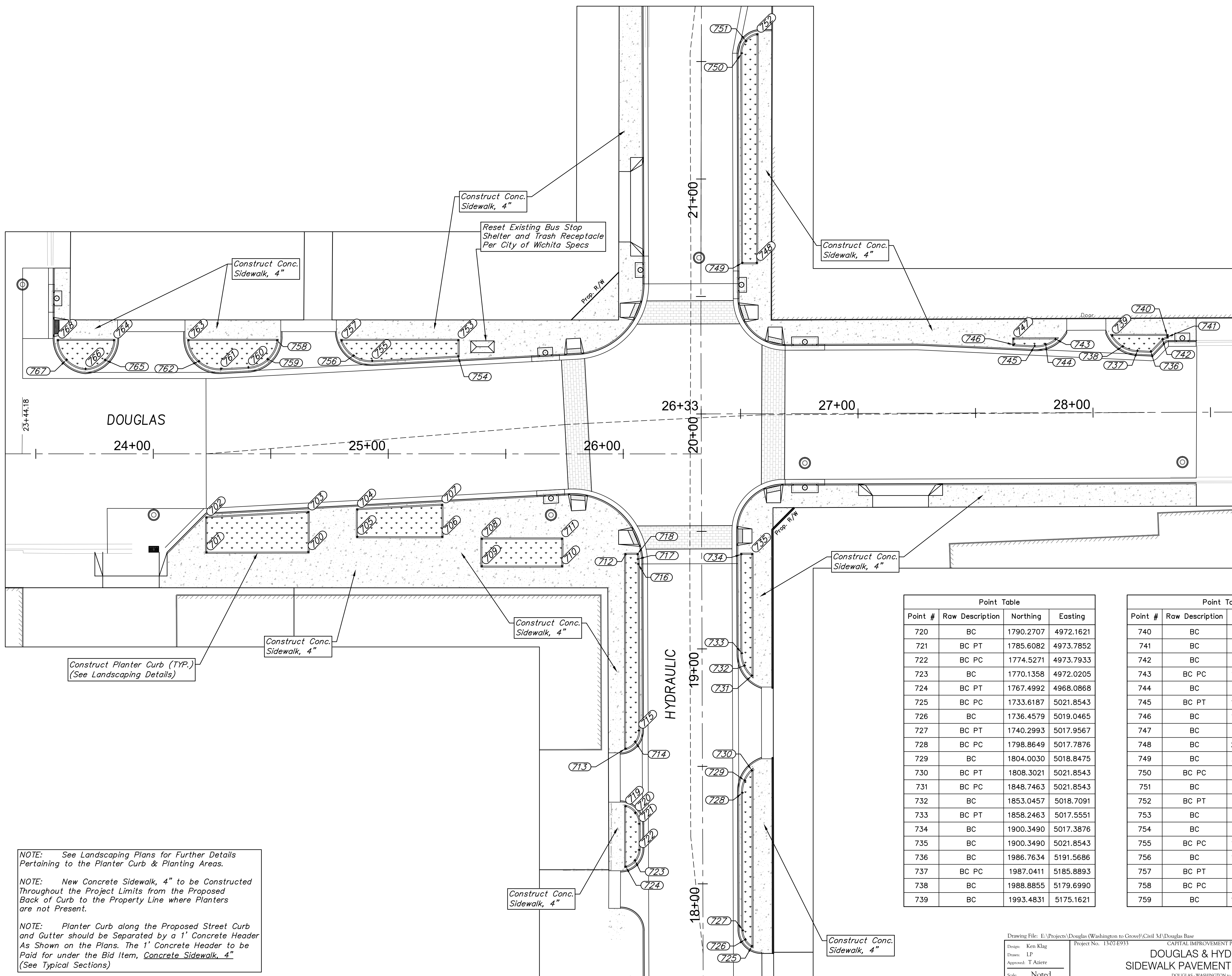

NOTE: See Landscaping Plans for Further Details Pertaining to the Planter Curb & Planting Areas.

NOTE: New Concrete Sidewalk, 4" to be Constructed Throughout the Project Limits from the Proposed Back of Curb to the Property Line where Planters are not Present.

NOTE: Planter Curb along the Proposed Street Curb and Gutter should be Separated by a 1' Concrete Header As Shown on the Plans. The 1' Concrete Header to be Paid for under the Bid Item, Concrete Sidewalk, 4" (See Typical Sections)

Drawing File: E:\Projects\Douglas (Washington to Grove)\Civil 3D\Douglas Base
 Design: Ken Klag
 Drawn: LP
 Approved: T Alieri
 Scale: Noted

Project No. 13-07-E933

CAPITAL IMPROVEMENT PROJECT
DOUGLAS & HYDRAULIC
 SIDEWALK PAVEMENT SITE PLAN
 DOUGLAS - WASHINGTON TO GROVE

Baughman Company, P.A.
 315 Ellis St. Wichita, KS 67211 P 316-262-7271 F 316-262-0149
 ENGINEERING | SURVEYING | PLANNING | LANDSCAPE ARCHITECTURE