

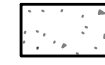



LEGEND

-  4" Concrete Sidewalk
-  Brick Pavers
-  Curb & Gutter
-  8" Concrete Pavement on a 7" Crushed Rock Base, Reinforced
-  9" Concrete Pavement on a 6" Crushed Rock Base, Reinforced
-  Flow Path for Drainage

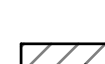

**Tran Systems**

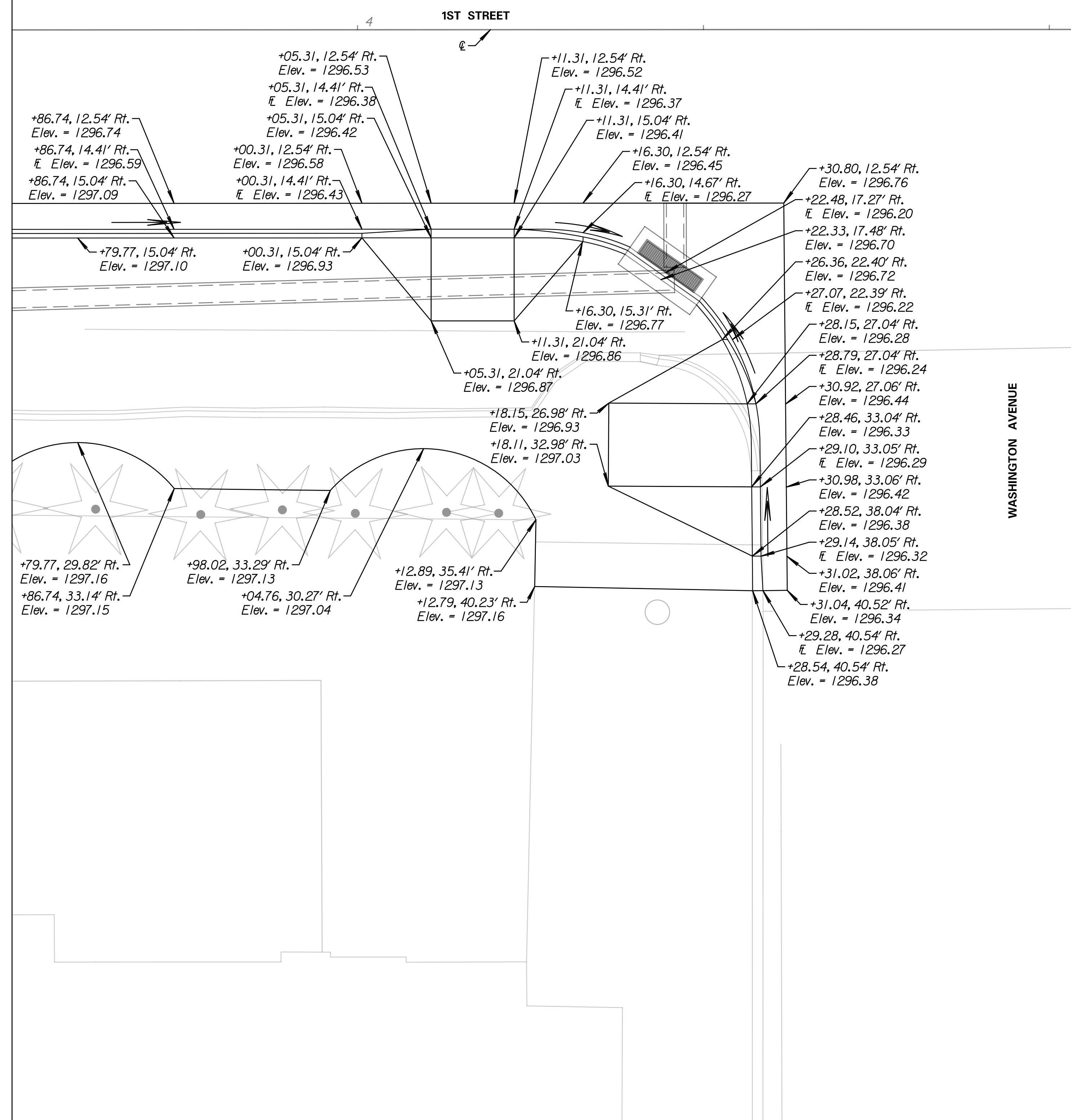
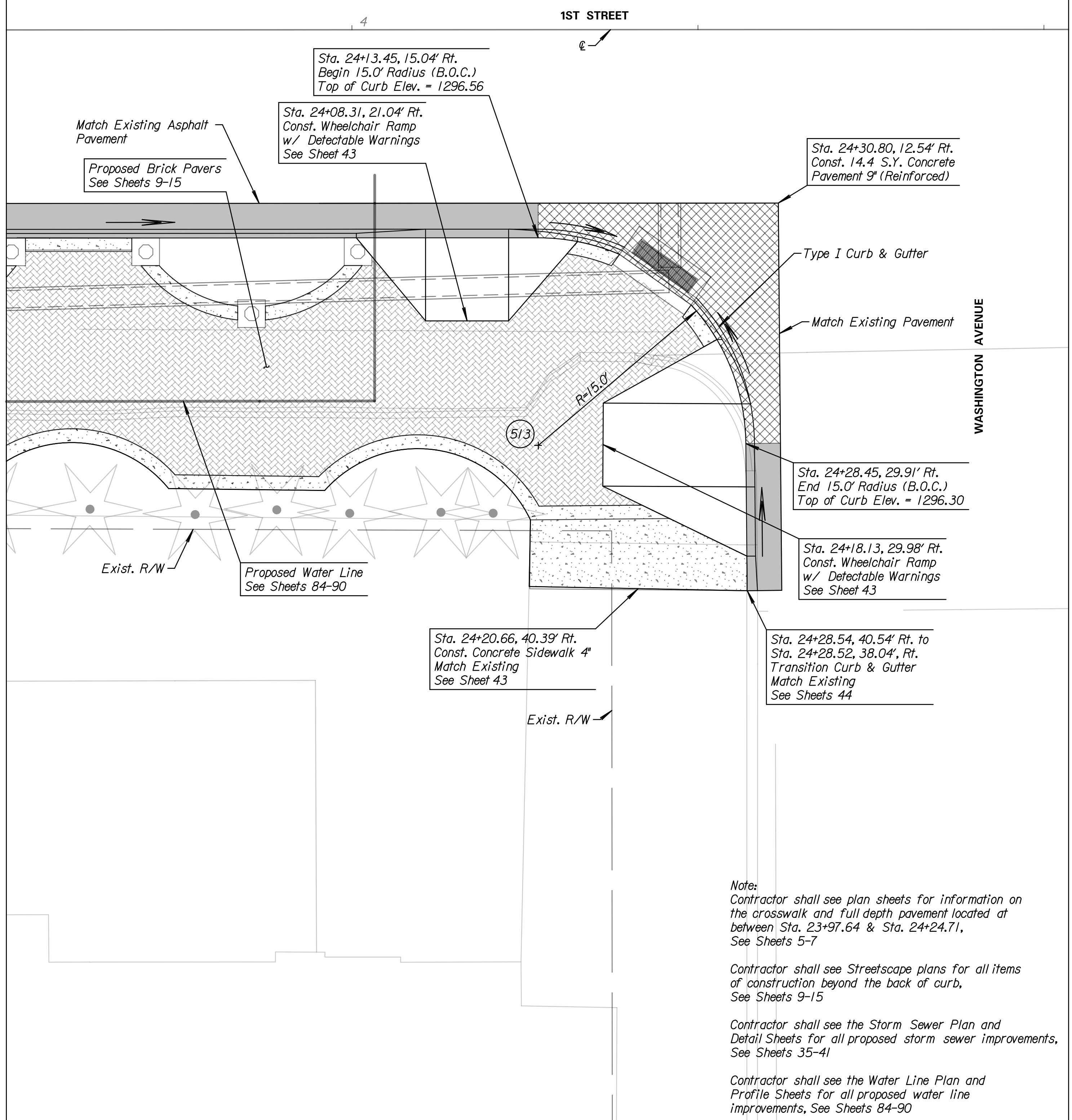
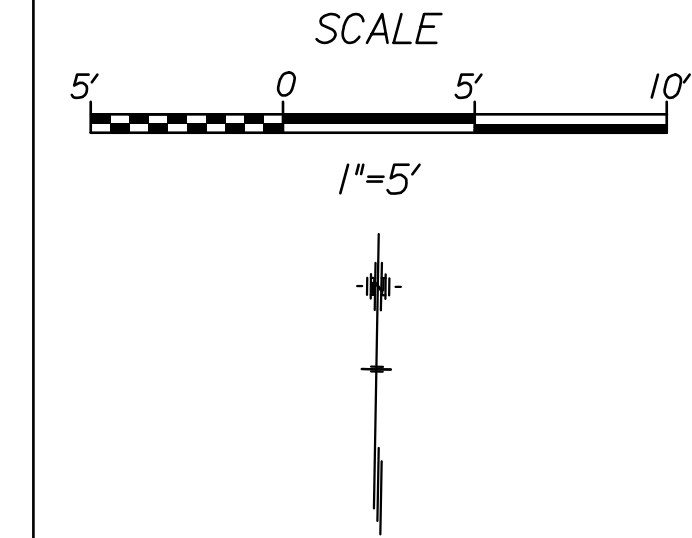
245 NORTH WACO  
SUITE 222  
WICHITA, KANSAS 67202  
PHONE: 316-303-3000  
FAX: 316-303-0166

CONSULTANTS:

**LK ARCHITECTURE, INC.**

345 RIVERVIEW  
SUITE 200  
WICHITA, KANSAS 67208  
PHONE: 316-268-0230

1ST STREET IMPROVEMENTS  
SANTA FE TO WASHINGTON IN OLD TOWN

WICHITA, KANSAS

**CITY OF WICHITA**

REVISIONS:	MARK	DATE	DESCRIPTION

PROJ NO: 472-85285  
SCALE: 1"=5'  
DATE: 7/5/2017  
DESIGNED BY: TAU  
DRAWN BY: TAU  
CHECKED BY: MDB

SHEET TITLE:  
**S.W. QUADRANT  
DETAIL LAYOUT  
1ST STREET &  
WASHINGTON AVE.**

SHEET NO.  
**33**

SHEET 33 OF 90

taummed 7/5/2017 3:56:20 PM c:\tran\systems\paw\_ba\alltrans\paw\taummed\048273\CLAY\M01-114.dgn