





LEGEND

-  Phase I
-  Channelizer
-  Type III Barricade
-  Type III Barricade w/ Sign
-  Single Post/Skid Mounted Sign

To Be Placed @
The Intersection of
Santa Fe and 3rd Street

Note:
†Type III Barricades and signs are to only be placed during construction through private drive or side street.

APavement markings conflicting with the traffic control or the final lane configuration shall be covered with an approved removable tape during construction. Temporary pavement markings shall be Type I Temporary Pavement Marking Tape. The Contractor shall maintain all temporary pavement markings throughout their intended service life.

All existing signs in conflict with the traffic control shall be covered or removed and either reset or stored for retrieval by the Owner as directed by the Engineer.

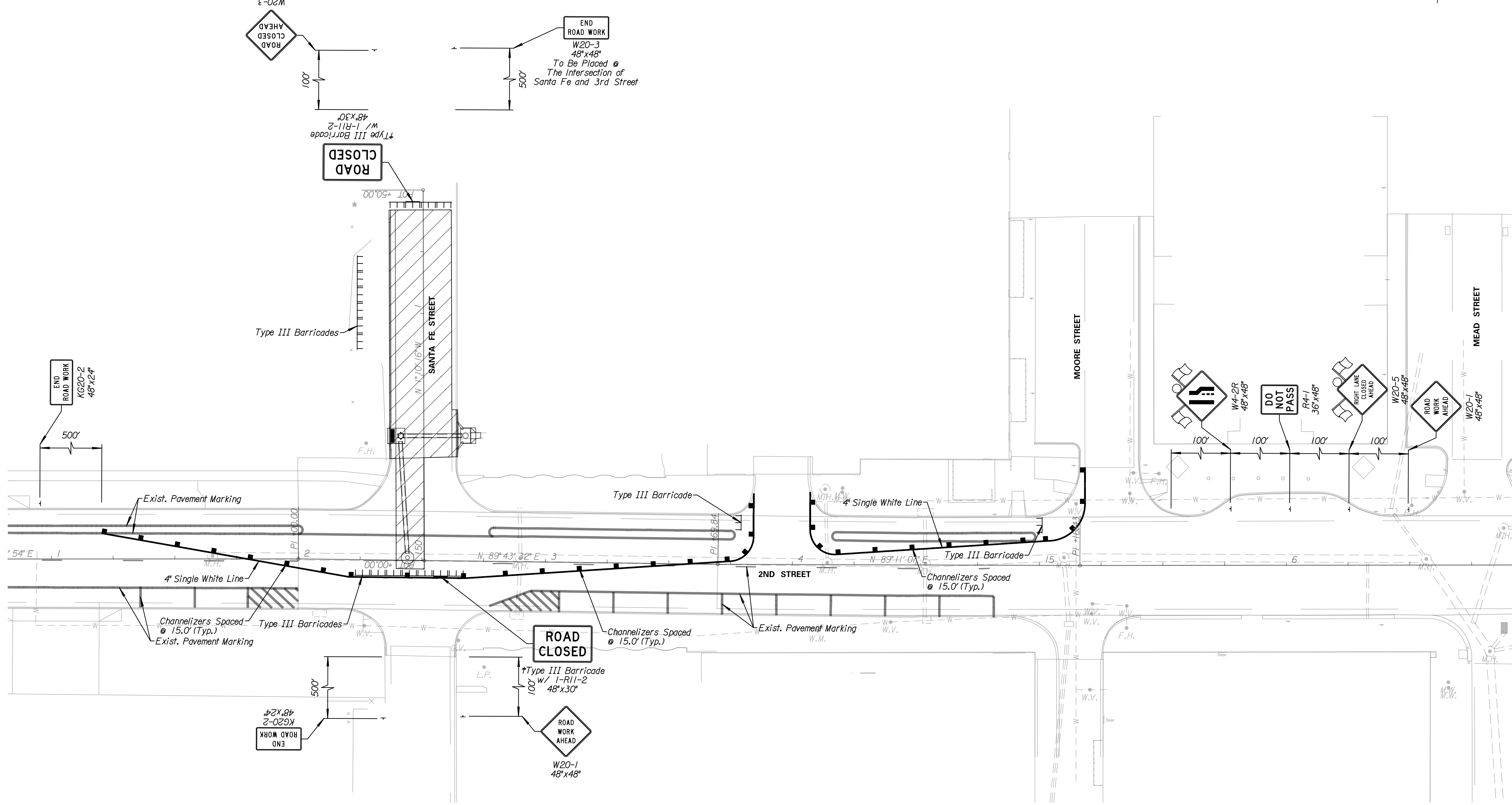
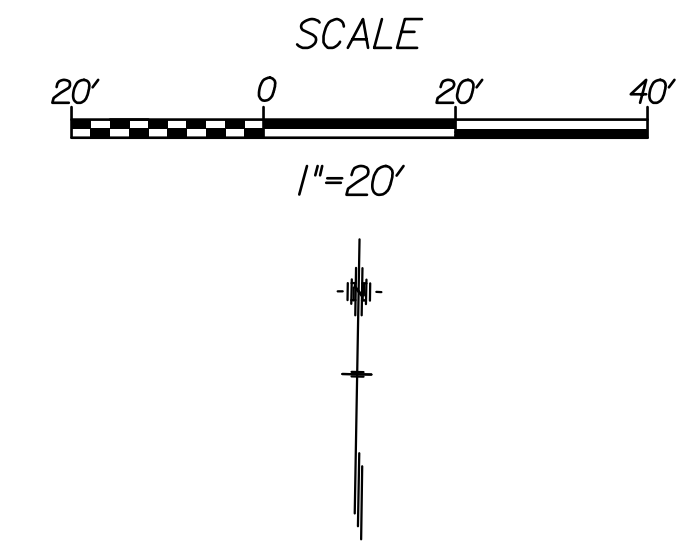

Tran Systems
245 NORTH WACO
SUITE 222
WICHITA, KANSAS 67202
PHONE: 316-303-3000
FAX: 316-303-0156

CONSULTANTS:
LK ARCHITECTURE, INC.
345 RIVERVIEW
SUITE 200
WICHITA, KANSAS 67208
PHONE: 316-268-0230

1ST STREET IMPROVEMENTS
SANTA FE TO WASHINGTON IN OLD TOWN
WICHITA, KANSAS
CITY OF WICHITA

REVISIONS:	MARK	DATE	DESCRIPTION

PROJ NO: 472-85285
SCALE: 1"=20'
DATE: 7/5/2017
DESIGNED BY: TAU
DRAWN BY: TAU
CHECKED BY: MDB

SHEET TITLE:
2ND STREET IMPROVEMENTS TRAFFIC CONTROL PHASE 1

SHEET NO.
56
SHEET 56 OF 90

tau\mml 7/5/2017 3:58:10 PM - c:\tran\systems\proj\local\tran\systems\proj\tau\mml\0482731C-CPP-M01-105.dgn