

J:\PROJECTS\2017\1401010462 - PREMIER ESTANCIA\GIS\CIVIL\CADD\PAV\RESIDENTIAL\PH2\1462-EP-05-PH2A.DWG  
 PLOTTED: Wednesday, July 19, 2017 8:08:17AM

SUBDIVISION BENCH MARKS				
NO.	STREET AND STATION	FROM CL	DESCRIPTION	ELEVATIONS
2	ESTANCIA, STA. 22+69.08	14.5' LT	TOP OF CURB AT NORTH END OF INLET HOOKUP	

NOTE: CONTRACTOR SHALL INSTALL SUBDIVISION BENCH MARKS ("FLAT SURVEY MARKERS NO. 8134-08 3" TOP DIAMETER" PROVIDED BY KANSAS BLUE PRINT CO., INC.) COSTS TO BE CONSIDERED SUBSIDIARY TO CONSTRUCTION OF COMBINED CURB AND GUTTER.

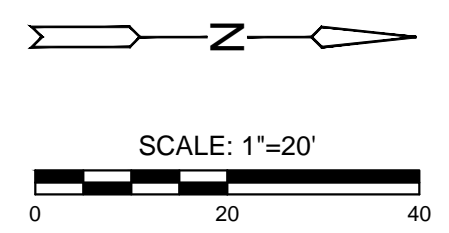
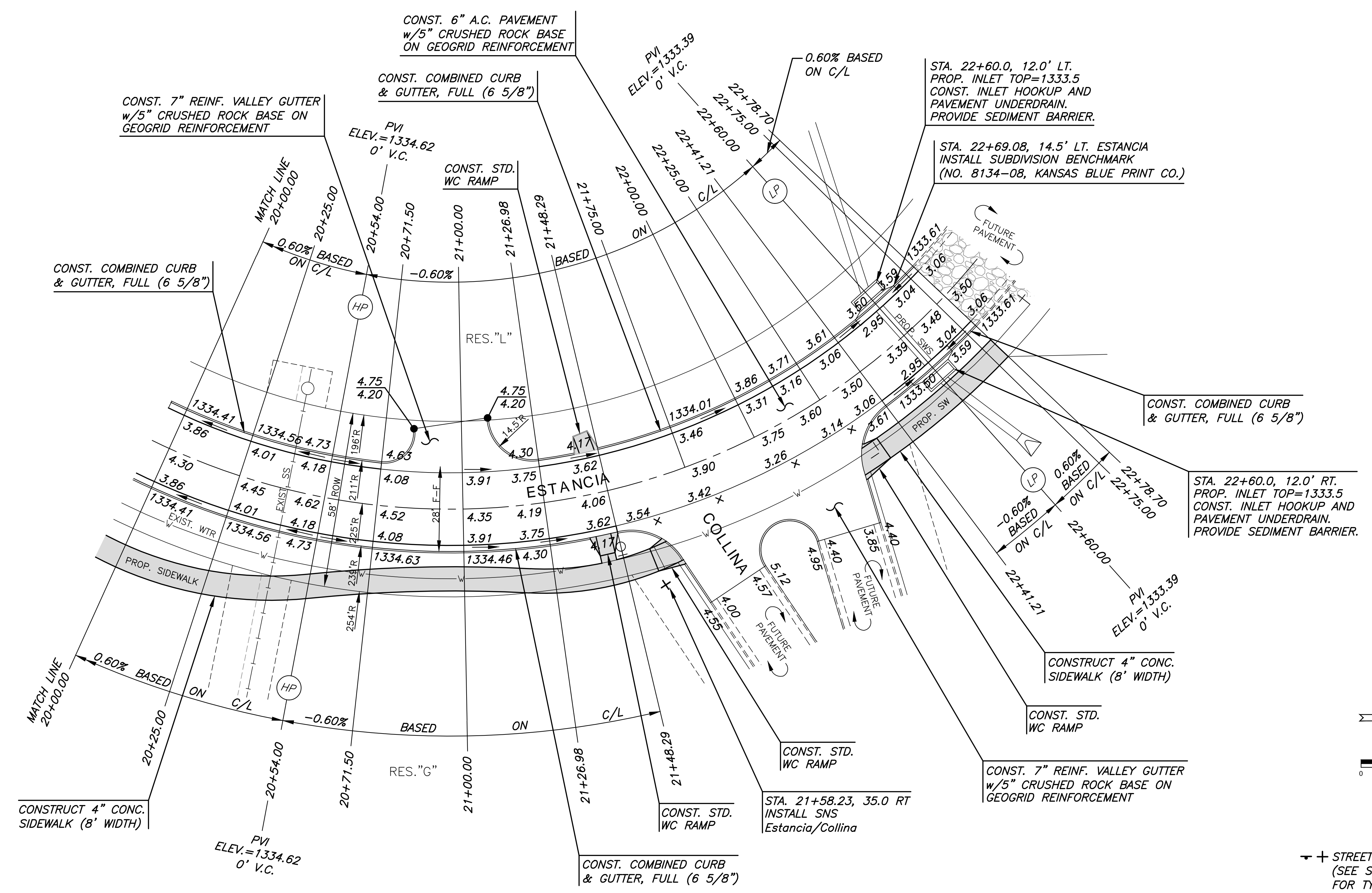

**LEGEND**

- STREET SIGN & SIGN LOCATION (SEE SIGN ASSEMBLY TABLE FOR TYPE & STATION OF SIGN)
- 10' TRANSITION FROM FULL TO ROLL CURB

- NOTES:**
- TOP OF CURB ELEVATIONS SHOWN ARE FOR FULL CURB. CONSTRUCT CURB AND GUTTER AS NOTED.
  - PVC SLEEVES TO BE BURIED AT A DEPTH OF 2' TO TOP OF SLEEVE, MINIMUM.



PAVING & INCIDENTAL DRAINAGE FOR  
**ESTANCIA ADDITION**  
 PHASE 2A

©2017 MKEC Engineering All Rights Reserved www.mkec.com  
 These drawings and their contents, including, but not limited to, all concepts, designs, & ideas are the exclusive property of MKEC Engineering (MKEC), and may not be used or reproduced in any way without the express consent of MKEC.

ESTANCIA (CONT.)		
PROJECT NO.	472-85244	
DATE	JUNE 2017	
SCALE	1" = 20'	
DESIGNED	DRAWN	CHECKED
DFL	RWB	GJA
NO.	REVISION	DATE
SHEET NO.		
09 OF 31		