

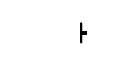



LEGEND

-  Phase 5
-  Single Post/Skid Mounted Sign
-  Channelizer
-  Tubular Marker (36")
-  Type III Barricade
-  Type III Barricade w/ Sign
-  Portable Changeable Message Board
-  Pavement Marking Removal

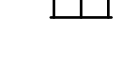
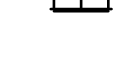

Note:
 KI-104a & KI-105a shall be placed in the appropriate positions. See Sheet 133 (TE 710) for more details.

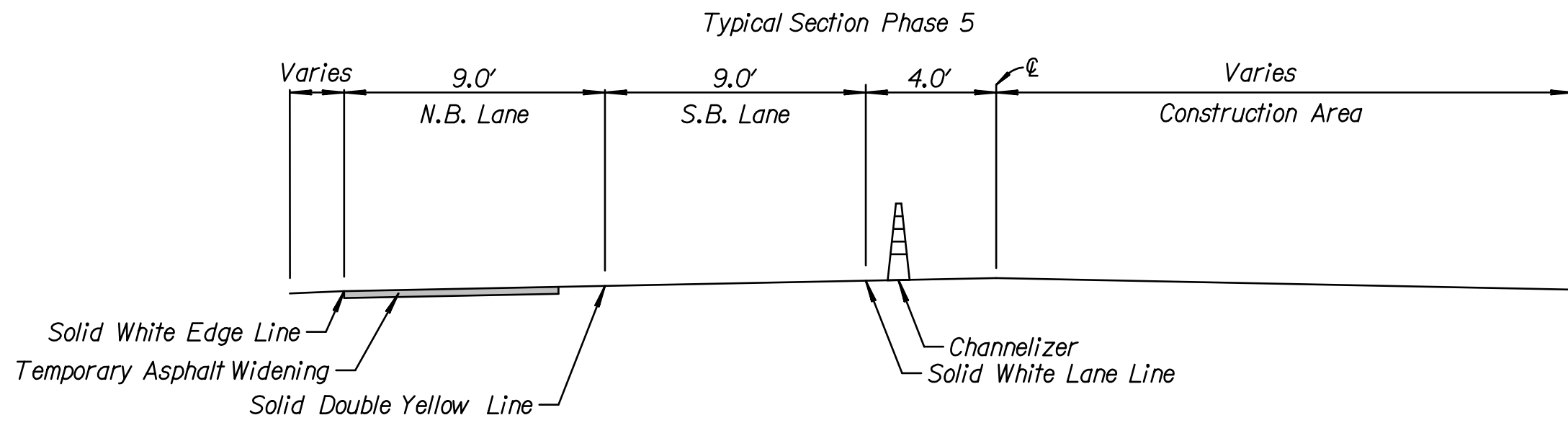
For the temporary traffic signal layout and details for Phase 5, See Sheets 127 & 129

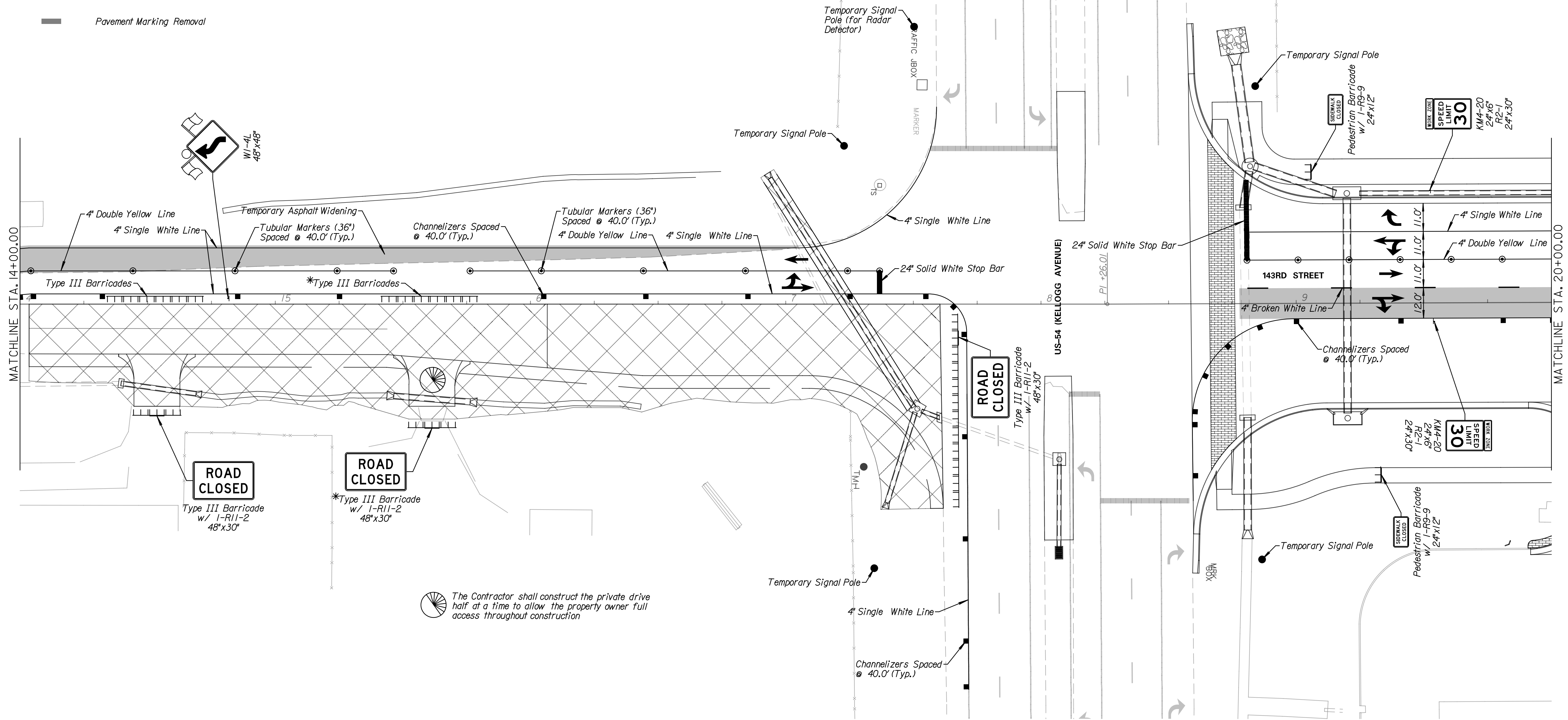
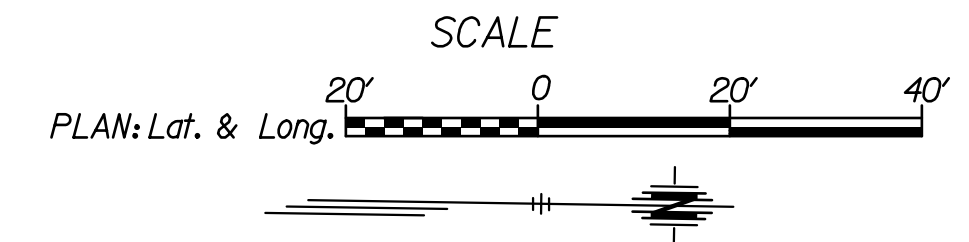

 The Contractor shall construct the private drive half at a time to allow the property owner full access throughout construction

Tran Systems
 245 NORTH WACO
 SUITE 222
 WICHITA, KANSAS 67202
 PHONE: 316-303-3000
 FAX: 316-462-5629

CONSULTANTS:

143RD STREET IMPROVEMENTS



REVISIONS:	MARK	DATE	DESCRIPTION

PROJ NO: 87 N-0614-01
 SCALE: 1"=20'
 DATE: 5/26/2017
 DESIGNED BY: TAU
 DRAWN BY: TAU
 CHECKED BY: MDB

SHEET TITLE:
143RD STREET IMPROVEMENTS TRAFFIC CONTROL PHASE 5

SHEET NO.
116