

Note:  
All 12" waterline shall be restrained joint pipe  
It is the Contractors responsibility to contact & coordinate with the utility companies prior to the installation of the water lines to locate any existing utilities that have not been previously located or new utilities that have been relocated.

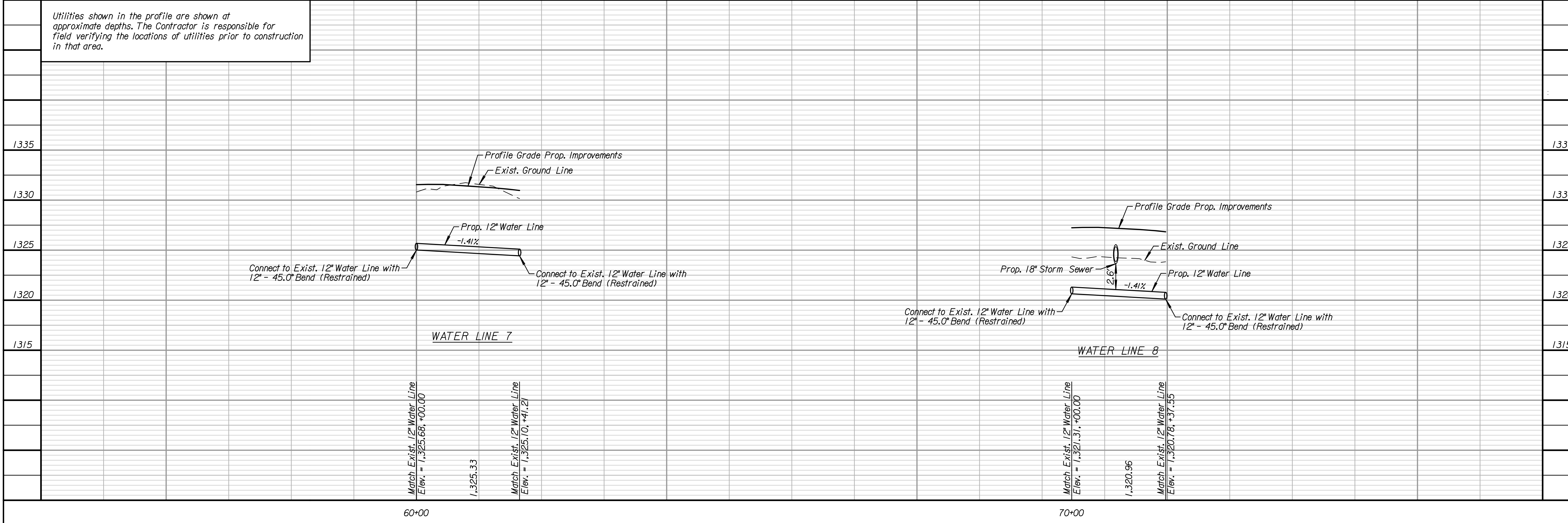
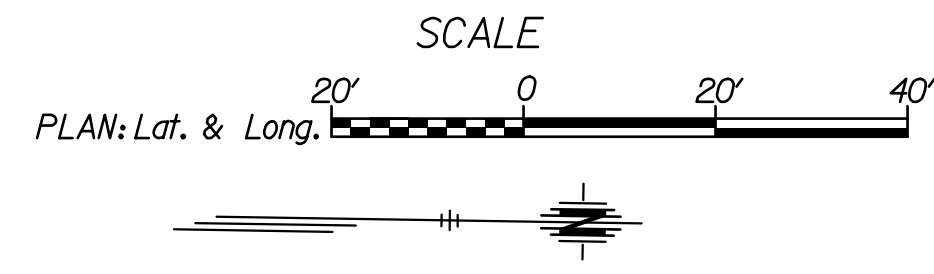

Utilities shown in the profile are shown at approximate depths. The Contractor is responsible for field verifying the locations of utilities prior to construction in that area.

**Tran Systems**  
245 NORTH WACO  
SUITE 222  
WICHITA, KANSAS 67202  
PHONE: 316-303-3000  
FAX: 316-303-0166

CONSULTANTS:

143RD STREET IMPROVEMENTS  
WICHITA, KANSAS  
**CITY OF WICHITA**

REVISIONS:	MARK	DATE	DESCRIPTION

PROJ NO: 87 N-0614-01  
SCALE: 1" = 20'  
DATE: 5/26/2017  
DESIGNED BY: TAU  
DRAWN BY: TAU  
CHECKED BY: MDB

SHEET TITLE:  
**143RD STREET WATER LINES 7 & 8**

SHEET NO.  
**175**

SHEET 175 OF 236