

CONSULTANTS:
 Lonnie E Stout & Jerry D Iseman
 247 Cardinal
 Wichita, KS 67230-7106

Note:
 There is minimal clearance between the aggregate base and top of proposed storm sewer pipe. Use caution whenever construction activity takes place in those areas.

The Contractor shall coordinate with the utility companies to locate any existing utilities that have not been previously located.

Any storm sewer adjacent to the curb & gutter or under any proposed pavement on mainline, side roads or entrances shall be backfilled in accordance with the City of Wichita Specifications unless otherwise noted on the plans or by the Engineer.

For storm sewer located on the west side of 143rd Street, See Sheet 20-28

143RD STREET IMPROVEMENTS



All utilities shown in the profile are shown at approximate depths. The Contractor is responsible for field verifying the locations of utilities prior to construction in that area.

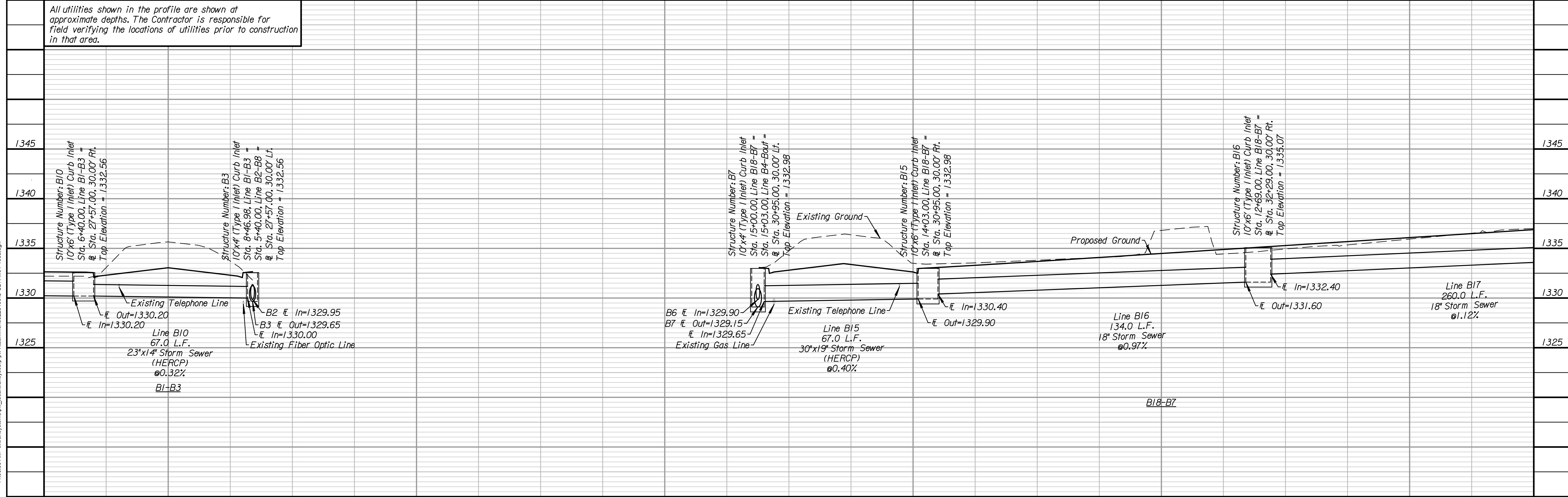

REVISIONS:	MARK	DATE	DESCRIPTION

PROJ NO: 87 N-0614-01
 SCALE: 1" = 20'
 DATE: 5/26/2017
 DESIGNED BY: TAU
 DRAWN BY: TAU
 CHECKED BY: MDB

SHEET TITLE:
143RD STREET STORM SEWER STA. 27+40.00 TO STA. 33+40.00

SHEET NO.
31
 SHEET 31 OF 236