

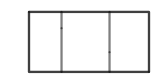





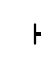

LEGEND

-  Phase 3
-  Temporary Asphalt Widening
-  Single Post/Skid Mounted Sign
-  Channelizer
-  Tubular Marker (36")
-  Type III Barricade
-  Type III Barricade w/ Sign
-  Portable Changeable Message Board
-  Pavement Marking Removal

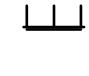

Note:
Concrete Safety Barrier shall be anchored according to KDOT Standard RD622b.
See Sheet 138

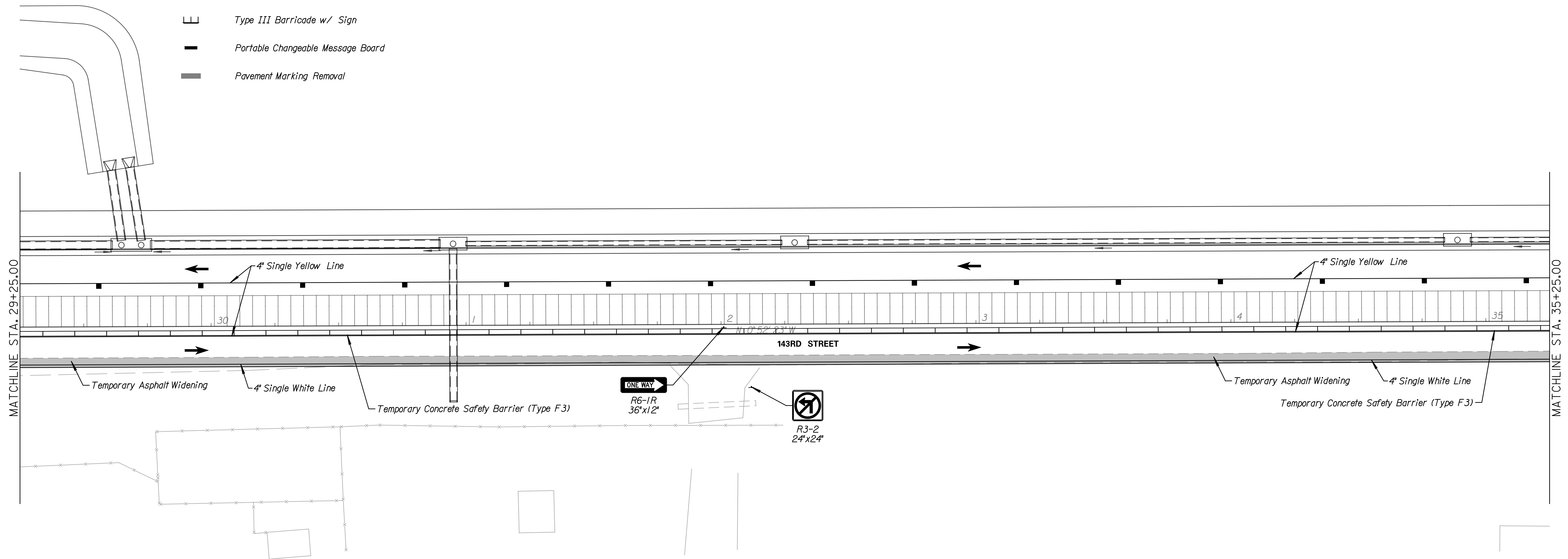
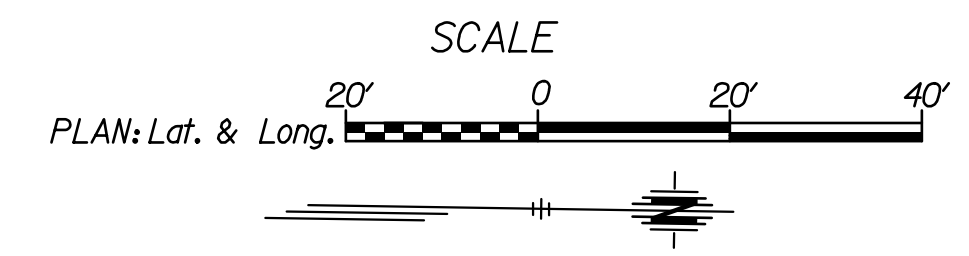
Tran Systems
245 NORTH WACO
SUITE 222
WICHITA, KANSAS 67202
PHONE: 316-303-3000
FAX: 316-462-5629

CONSULTANTS:

143RD STREET IMPROVEMENTS



REVISIONS:	MARK	DATE	DESCRIPTION

PROJ NO: 87 N-0614-01
SCALE: 1"=20'
DATE: 5/26/2017
DESIGNED BY: TAU
DRAWN BY: TAU
CHECKED BY: MDB

SHEET TITLE:
143RD STREET IMPROVEMENTS TRAFFIC CONTROL PHASE 3

SHEET NO.
96
SHEET 96 OF 236