







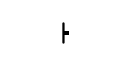

LEGEND

-  Phase 3
-  Temporary Asphalt Widening
-  Single Post/Skid Mounted Sign
-  Channelizer
-  Tubular Marker (36")
-  Type III Barricade
-  Type III Barricade w/ Sign
-  Portable Changeable Message Board
-  Pavement Marking Removal

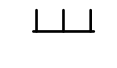

Note:  
Concrete Safety Barrier shall be anchored according to KDOT Standard RD622b,  
See Sheet 138

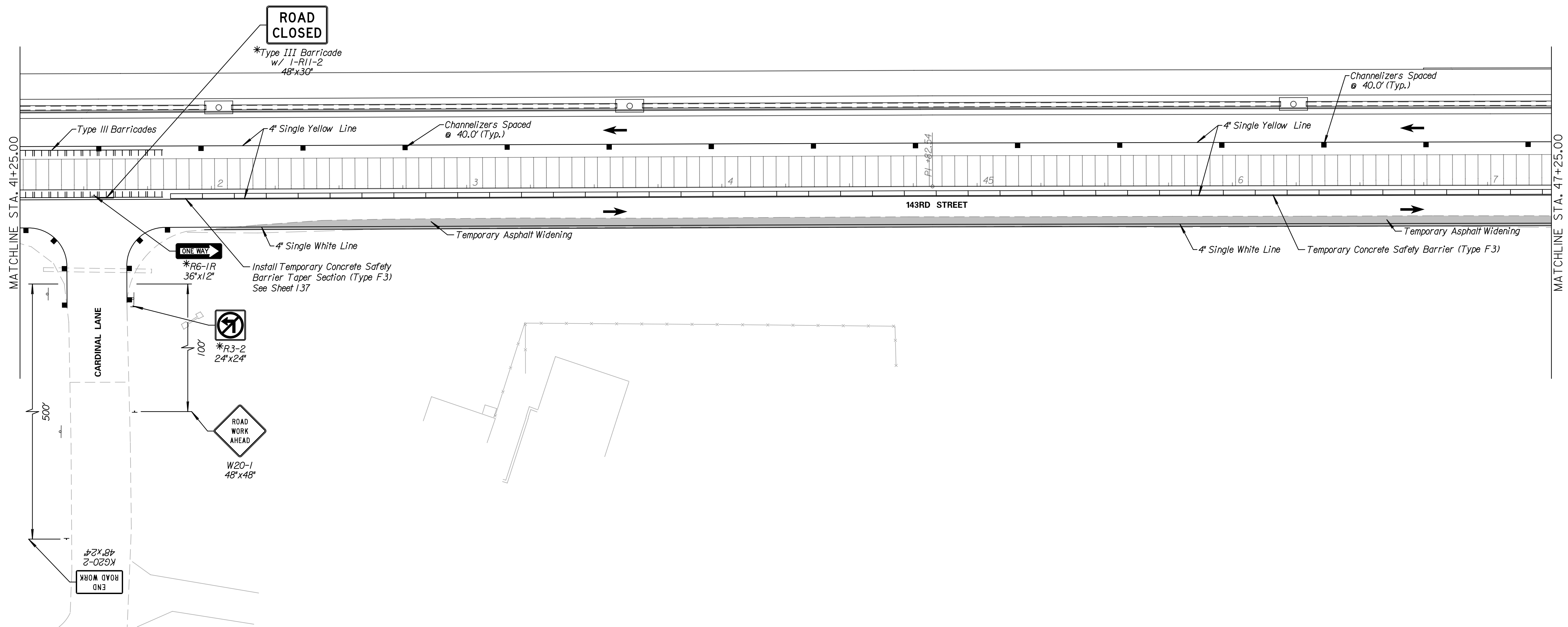
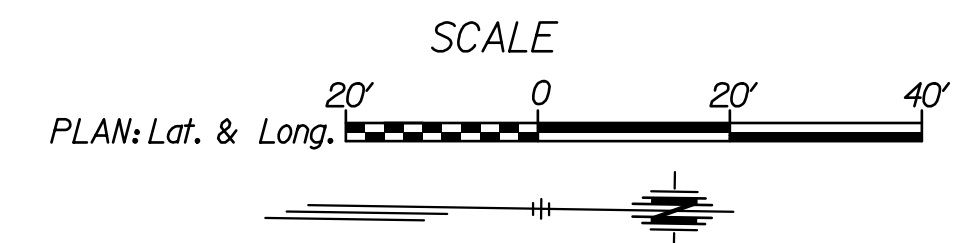
\*Type III Barricades and signs are to only be placed  
during construction through private drive or side street.

**Tran Systems**  
245 NORTH WACO  
SUITE 222  
WICHITA, KANSAS 67202  
PHONE: 316-303-3000  
FAX: 316-462-5629

CONSULTANTS:

143RD STREET IMPROVEMENTS  
WICHITA, KANSAS  
**CITY OF WICHITA**

REVISIONS:	MARK	DATE	DESCRIPTION

PROJ NO: 87 N-0614-01  
SCALE: 1"=20'  
DATE: 5/26/2017  
DESIGNED BY: TAU  
DRAWN BY: TAU  
CHECKED BY: MDB

SHEET TITLE:  
**143RD STREET IMPROVEMENTS TRAFFIC CONTROL PHASE 3**

SHEET NO.  
**98**  
SHEET 98 OF 236

taumdel 5/26/2017 11:12:47 AM c:\tran\systems\paw\_ba\alltrans\paw\_ba\taumdel\0228400C-CPP-M01-605.dgn