

BENCHMARKS:
BM #1: Disc of Top of Curb
 between Lot 8 and Lot 9, Block
 B on West Side of Cimarron,
 Edge Water Addition
 Elev. = 1335.14 NGVD29

BM #2: "□" on Top of Curb
 East Side of Ridge Port at End
 of Curb, North Corner of Lot 30,
 Block B, Edge Water Addition
 Elev. = 1338.17 NGVD29

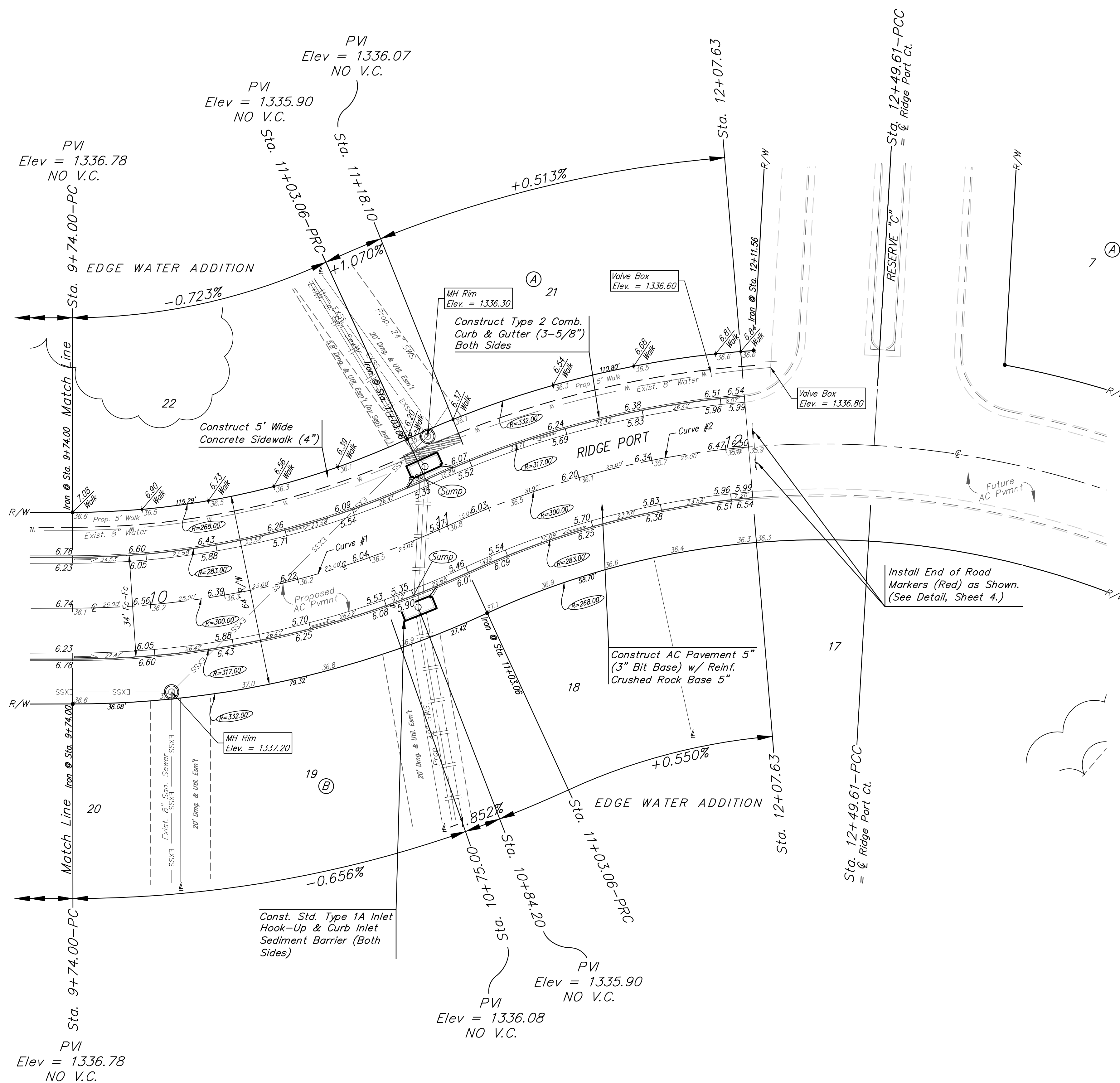
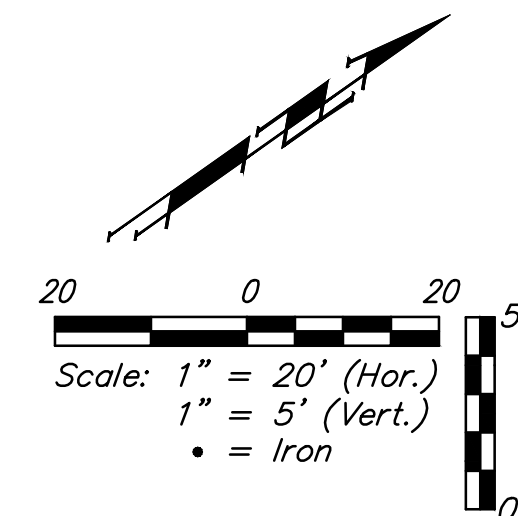

Curve #1
 Curve Data Based on Centerline
 Rad. = 300.00' Delta = 24°38'52" Tangent = 65.54'
 Arc = 129.06' L.C. = 128.06' Def./Ft. = 5.72938 Min.

Station	Arc	Chord		Defl.	Total Defl.
		8' Left	8' Right		
9+74.00	-	-	-	0°00'00"	0°00'00"
9+75.00	1.00'	0.92'	1.08'	0°05'44"	0°05'44"
10+00.00	25.00'	22.91'	27.07'	2°23'14"	2°28'58"
10+25.00	25.00'	22.91'	27.07'	2°23'14"	4°52'12"
10+50.00	25.00'	22.91'	27.07'	2°23'14"	7°15'26"
10+75.00	25.00'	22.91'	27.07'	2°23'14"	9°38'40"
11+00.00	25.00'	22.91'	27.07'	2°23'14"	12°01'54"
11+03.06	3.06'	2.80'	27.07'	0°17'32"	12°19'26"

Curve #2
 Curve Data Based on Centerline
 Rad. = 300.00' Delta = 97°42'39" Tangent = 343.36'
 Arc = 511.61' L.C. = 451.83' Def./Ft. = 5.72961 Min.

Station	Arc	Chord		Defl.	Total Defl.
		8' Left	8' Right		
11+03.06	-	-	-	0°00'00"	0°00'00"
11+25.00	21.94'	23.76'	20.11'	2°05'42"	2°05'42"
11+50.00	25.00'	27.08'	22.91'	2°23'15"	4°28'57"
11+75.00	25.00'	27.08'	22.91'	2°23'14"	6°52'11"
12+00.00	25.00'	27.08'	22.91'	2°23'15"	9°15'26"
12+07.63	7.63'	8.27'	6.99'	0°43'43"	9°59'09"

Install End of Road
 Markers (Red) as Shown.
 (See Detail, Sheet 4.)

Roll type curb & gutter to
 be constructed on the pavement
 on this sheet.
 Top of curb elevation are given
 for full height curb.

	Edge Water Addition Phase 6A	
	RIDGE PORT Sta. 9+74.00 to Sta. 12+07.63	
<small>Baughman Company, P.A. 315 Ellis St. Wichita, KS 67211 P 316.262.0149 F 316.262.0149 ENGINEERING SURVEYING PLANNING LANDSCAPE ARCHITECTURE</small>		
PROJECT NUMBER 472-84703	DESIGN AEG	DRAWN DJL
REVISIONS:	APPROVED	DATE 6/17
	SCALE Noted	SHEET
	8 OF 30	