

STATE	PROJECT NO.	YEAR	SHEET NO	TOTAL SHEETS
KANSAS	87 N-0203-01	2003	38.001	48

DATE	
BY	
REFERENCES NOTED	
REFERENCES CHECKED	

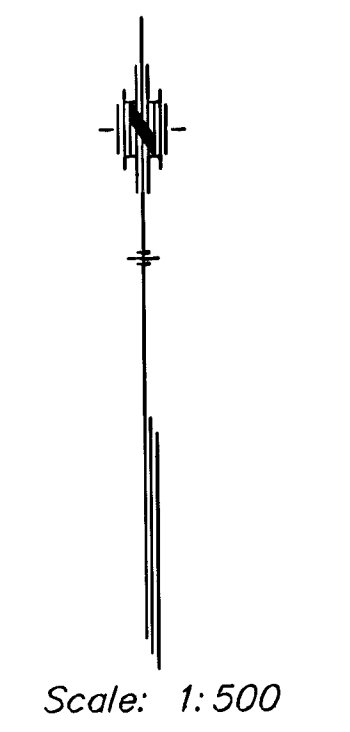
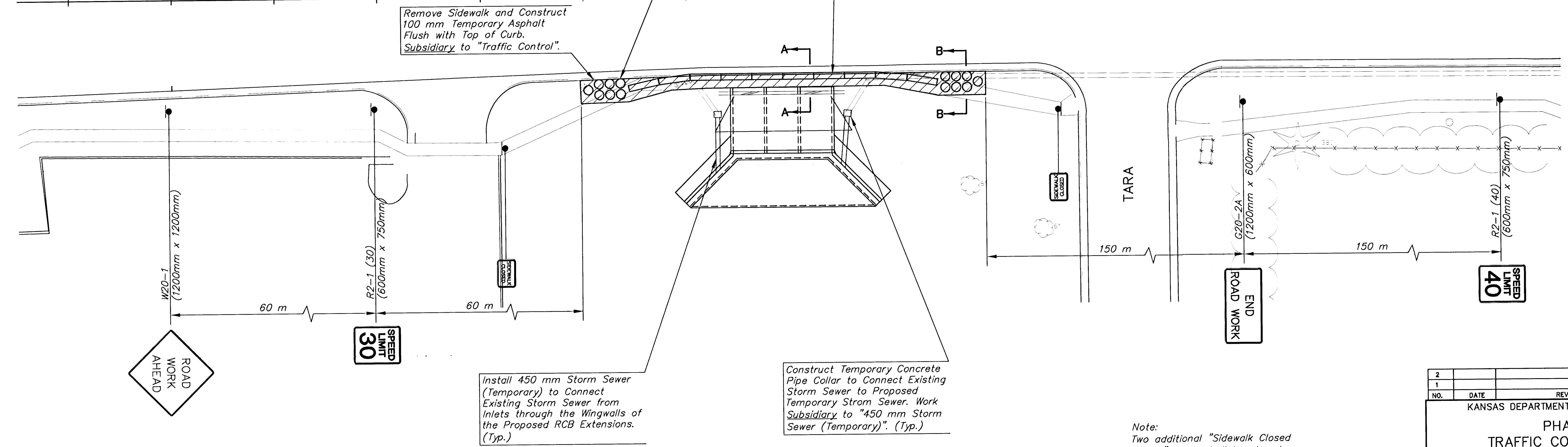
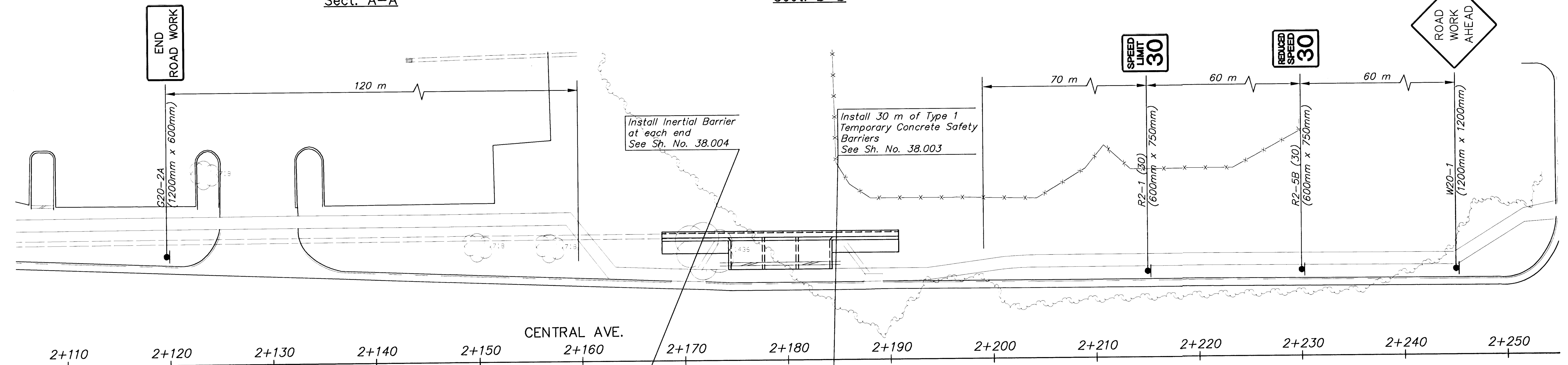
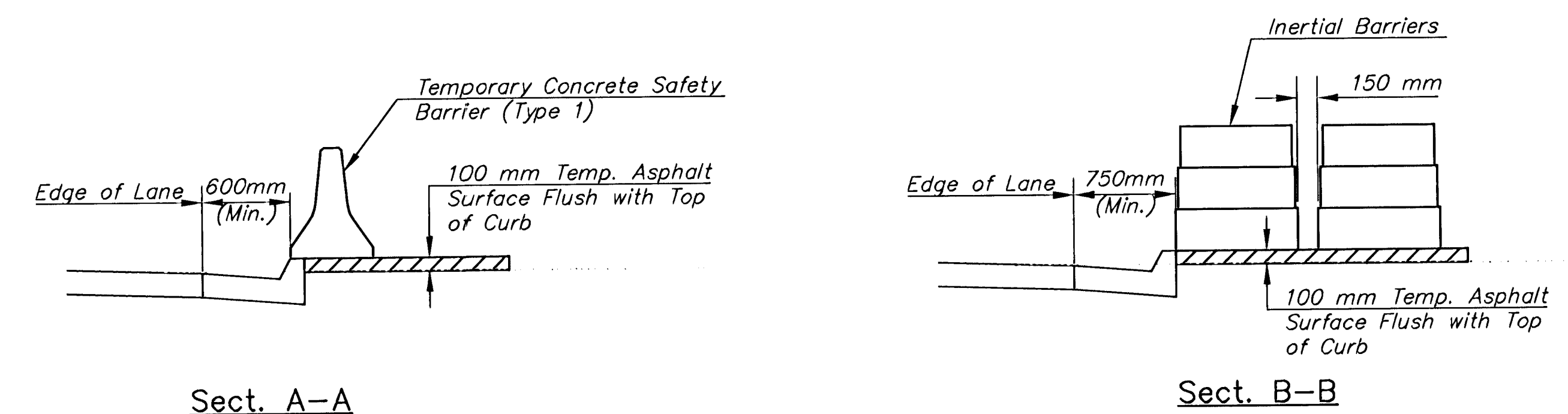

Install 450 mm Storm Sewer (Temporary) to Connect Existing Storm Sewer from Inlets through the Wingwalls of the Proposed RCB Extensions. (Typ.)

Construct Temporary Concrete Pipe Collar to Connect Existing Storm Sewer to Proposed Temporary Storm Sewer. Work Subsidiary to "450 mm Storm Sewer (Temporary)". (Typ.)

Note:
Two additional "Sidewalk Closed Ahead" signs shall be placed as directed by the Engineer.

NO.	DATE	REVISIONS	BY	APP'D
2				
1				

KANSAS DEPARTMENT OF TRANSPORTATION

PHASE I
TRAFFIC CONTROL PLAN

PROJ. NO. 87 N-0203-01 SEDGWICK CO.

MID-KANSAS ENGINEERING CONSULTANTS, INC.
WICHITA, KANSAS

DESIGNED BY: JRA CHECKED BY: KJS
DRAWN BY: WNU DATE: 09/2003 SHEET 38.001 of 48