

CP #104 53.89' Lt. @ Sta. 104+09.57  
 1/2" rebar  
 N 1,686,443.438 E 1,617,742.549  
 1. 2.10' E to west edge sidewalk, west side Tyler Road  
 2. 36.50' NE to SW Cor. Black Mailbox Post  
 3. 29.00' SE to center crosswalk post

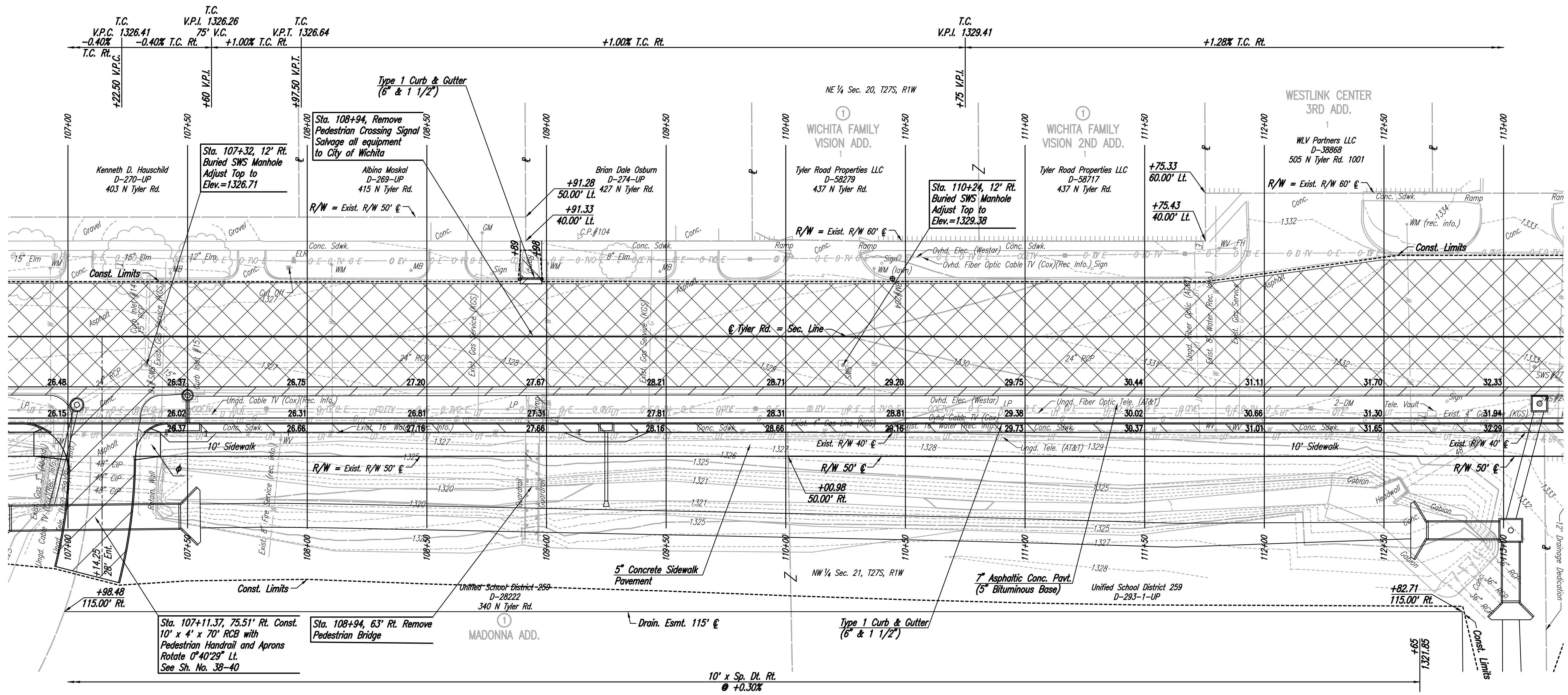
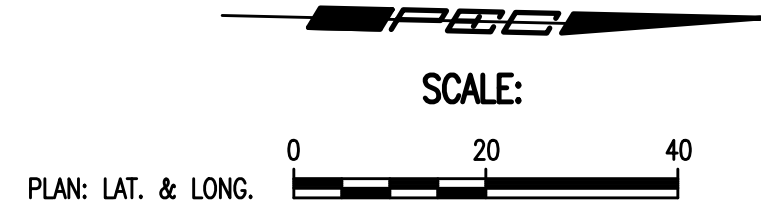

REMOVAL OF EXISTING STRUCTURES *		
STATION	SIDE	ITEM
107+15	Rt.	3-48" x 49" CIP
107+38	Rt.	Headwall
107+51	Rt.	Curb Inlet
108+94	Rt.	Pedestrian Bridge
112+58	Rt.	67.0 L.F. 48" RCP w/Headwall
112+76	Rt.	Sign
112+93	Rt.	3-36" x 19" RCP w/End Sections

\* For Information Only

Note: Elevations shown along Curb and Gutter are to High Edge and Top of Curb.

- UTILITIES**
- Cable TV
  - Communications
  - Gas
  - Power
  - Storm Water Sewer
  - Telephone
  - Water
  - Cox Communications
  - Wichita Public Schools
  - Kansas Gas Service
  - Westar Energy
  - City of Wichita
  - AT&T
  - City of Wichita

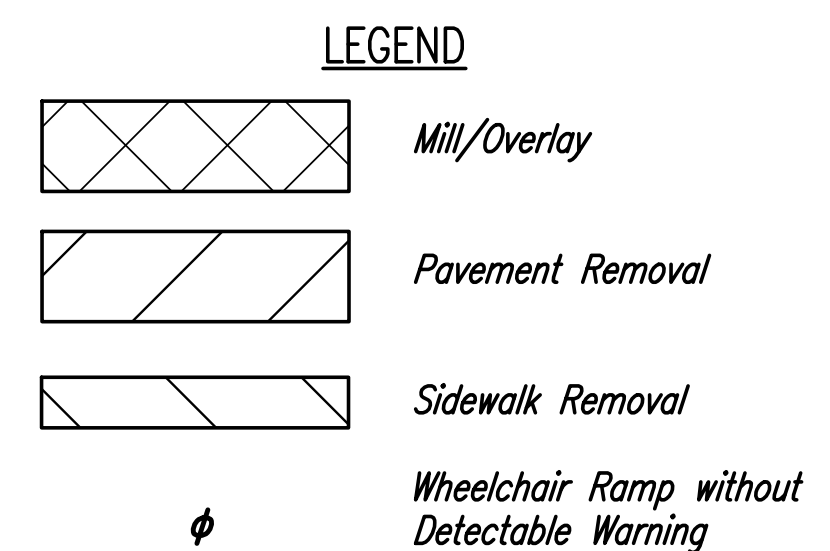

BM #204-Chiseled square on west top of curb Tyler Road at north end of return (437 N. Tyler Road).  
 24.30' Lt. @ Sta. 110+44.56 Elev.=1328.66 (NAVD88)

No.	Revision	By	Date
TYLER ROAD BETWEEN MAPLE AND CENTRAL PAVING AND INCIDENTAL DRAINAGE IMPROVEMENTS <b>PLAN</b> <b>STA. 107+00 TO STA. 113+00</b> GARY JANZEN, P.E. - CITY ENGINEER CITY OF WICHITA PROJECT NO. 472-85282			
Designed by	CKC	Job No. 31-15956-000	Sht. 06 of 96
Drawn by	CP	Date JULY 2017	

Sowed: 07-27-2017 8:58:18 AM by CP  
 Plot Scale: 1" = 40'-0" (1:480)  
 U:\Projects\Civil\2015\15956\Drawings\15956-000-06C-Plan 107