

BY	DATE
CHECKED	CHECKED

BY	DATE
CHECKED	CHECKED

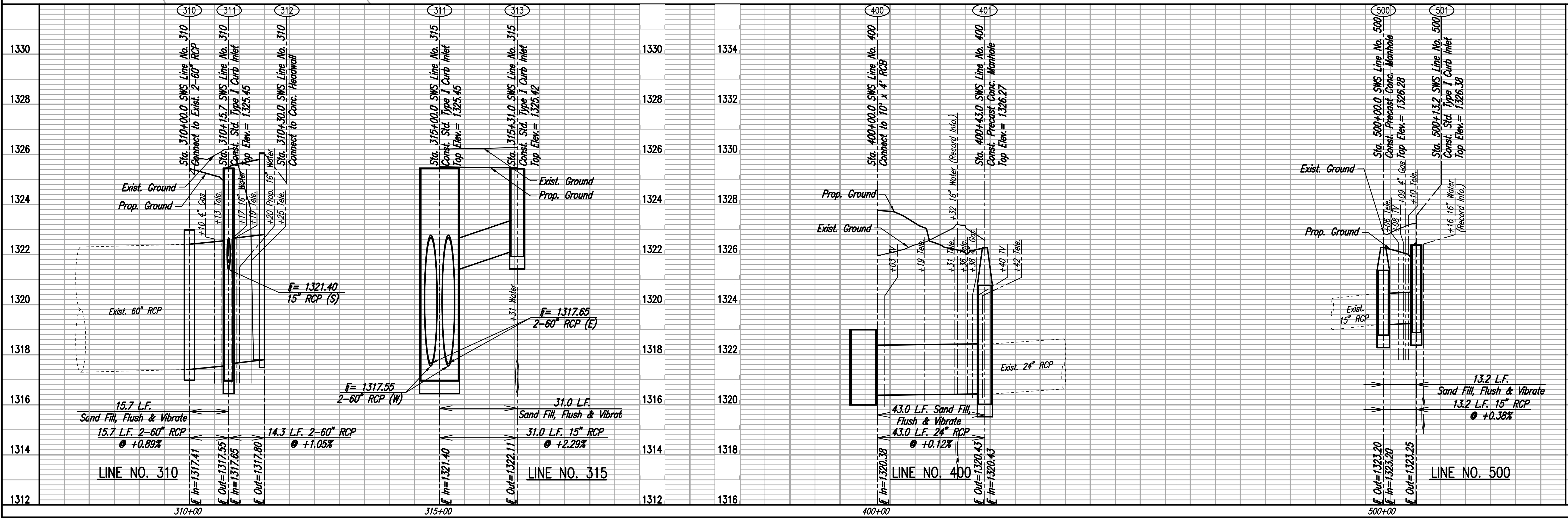
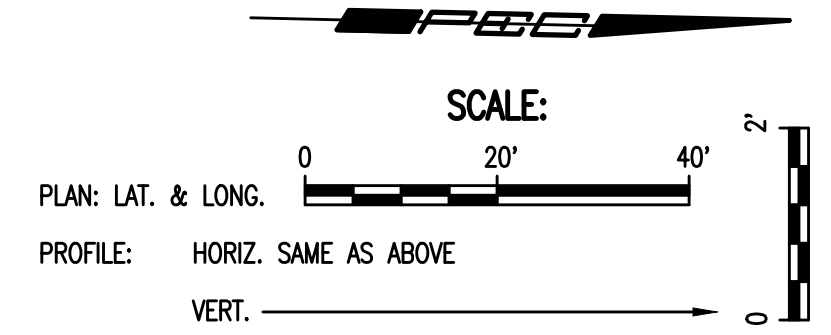
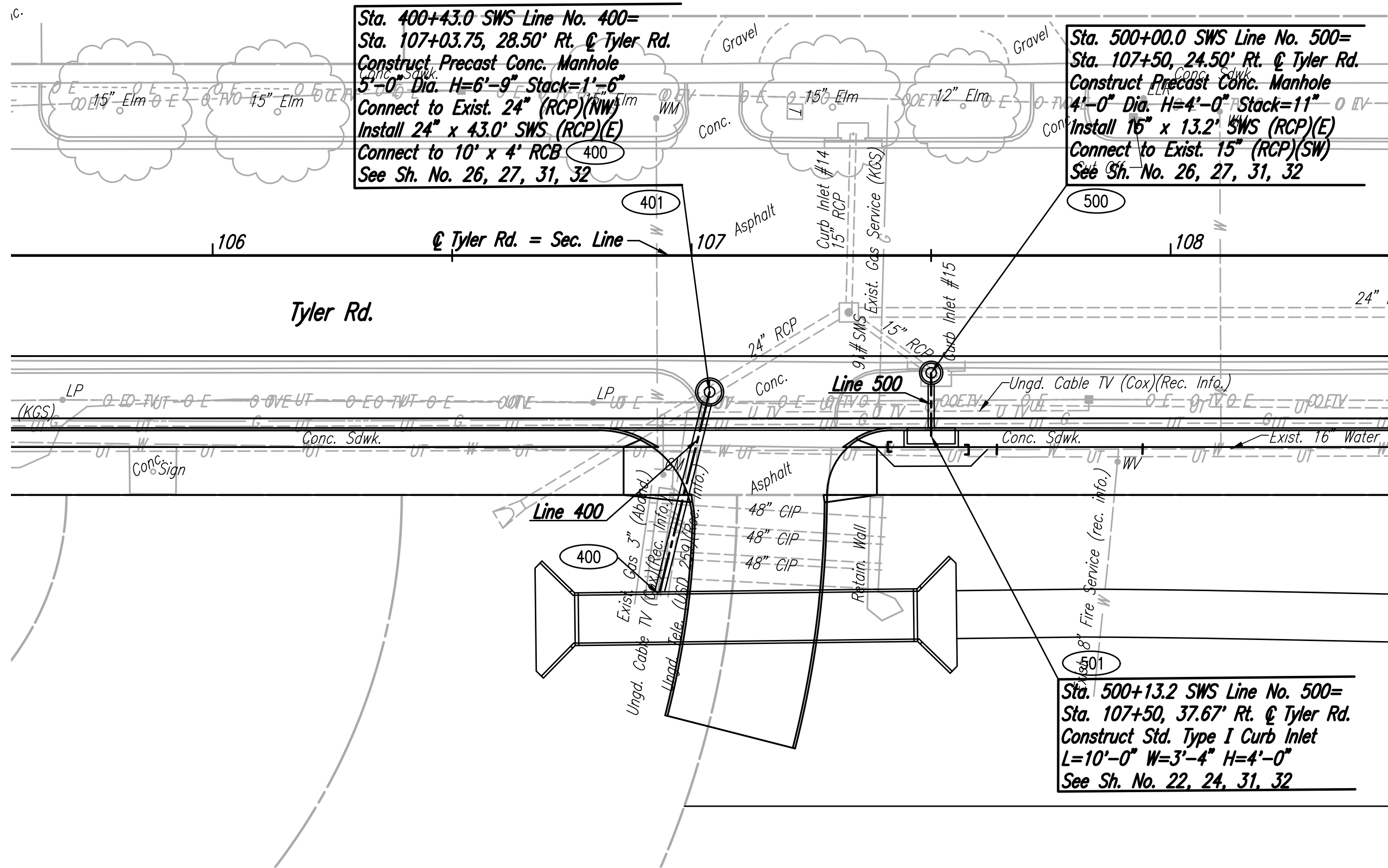
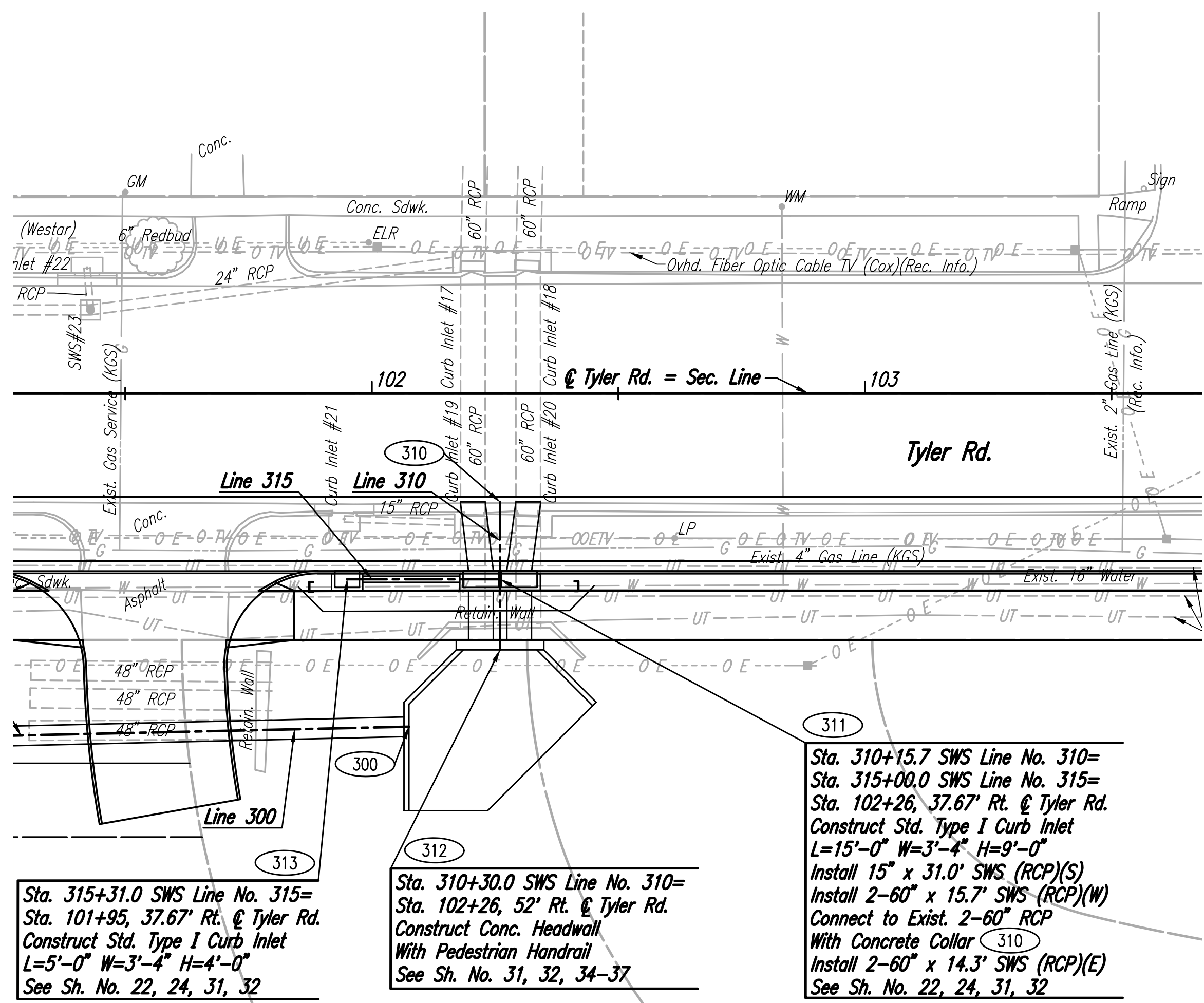

**PEC**  
PROFESSIONAL ENGINEERING CONSULTANTS, P.A.  
303 SOUTH TOPEKA WICHITA, KS 67202  
316-262-2691 www.pec.com

**STORM SEWER PLAN**  
TYLER ROAD BETWEEN MAPLE AND CENTRAL  
PAVING AND INCIDENTAL DRAINAGE IMPROVEMENTS  
LINE NO. 310, 315, 400, 500  
GARY JANZEN, P.E. - CITY ENGINEER  
CITY OF WICHITA PROJECT NO. 472-85292

Job No. 31-15956-000  
Date JULY 2017

Designed By BMM  
Drawn By BUS