

| FHWA REGION NO. | STATE | PROJECT NUMBER | FISCAL YEAR | SHEET NUMBER | TOTAL SHEETS |
|-----------------|--------|----------------|-------------|--------------|--------------|
| 7 | KANSAS | 87N-0191-01 | 2002 | 8 | 92 |

| BY | DATE |
|----|------|
| | |
| | |
| | |
| | |

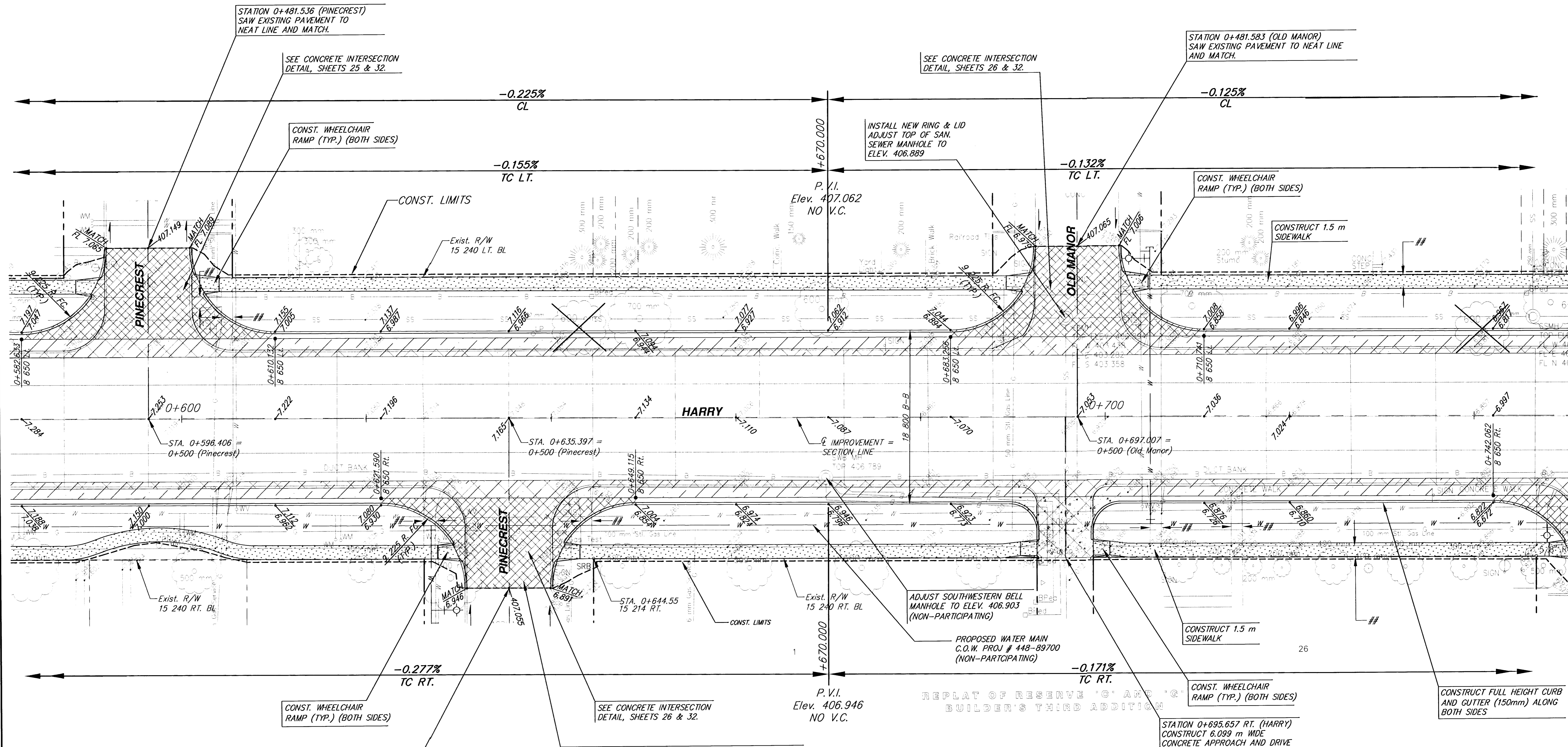

REMOVE EXISTING WALK



SCALE
5 0 5 10
PLAN: Lat. & Long. (meters)

HARRY
STATION 0+582.633 TO STATION 0+742.062
WICHITA, KANSAS

Ruggles & Bohm, P.A.
Engineering, Surveying, Land Planning

924 North Main (316) 264-8008
Wichita, Kansas 67203 (316) 264-4621 fax
www.rbkansas.com E-mail: info@rbkansas.com

| | |
|---------------------|-----------------------------|
| DESIGN MWS | SHEET 8 OF 92 |
| DRAWN TEB | |
| REVIEW | |
| UTILITY | DATE Jan. 30, 2003 |
| DRAWING FILE P03 | PROJECT NUMBER 472-83685 |