

**WATERLINE ADJUSTMENT NO. 2**  
See sheet no. B10

**FH RELOCATION NO. 2**  
See sheet no. B12.

At Tyler Rd. St., Sta. 104+91, 38' Rt.  
Existing Air Release (#10840)  
Remove and Salvage to City.  
Install 1- 2" Air Release Assembly  
Top Elevation= 1326.7

At Tyler Rd. St., Sta. 107+31, 41' Rt.  
**STORM SEWER CROSSING NO. 1**  
Exist. 16" WL Top Elev.= 1319.78 \*  
Prop. 24" RCP SWS E= 1320.45  
Distance Clear= 0.42'

At Tyler Rd. St., Sta. 103+98, 37' Rt.  
Adjust Existing Water Valve Box (#10841)  
Existing Top of Box Elev.= 1327.0  
Proposed Top of Box Elev.= 1326.2  
Difference = -0.8'

At Tyler Rd. St., Sta. Sta. 99+64, 29' Rt.  
Remove Existing Fire Hydrant.  
Close Existing Valve and Remove Valve Box  
(Salvage to City)  
Install 1- 6" CI RJ Plug (or MJ Plug with Blocking)  
This work shall be included in the bid item "Fire Hydrant Relocation".

\* PRIOR TO BEGINNING CONSTRUCTION, THE CONTRACTOR SHALL EXCAVATE THE EXISTING 16" WATERLINE TO VERIFY PIPE SIZE, TYPE, FITTINGS, AND HORIZONTAL AND VERTICAL LOCATION. THE CONTRACTOR SHALL REPORT HIS FINDINGS TO THE ENGINEER SO THAT ANY NECESSARY PLAN MODIFICATIONS CAN BE MADE. ANY ADDITIONAL LABOR OR MATERIALS NECESSARY TO COMPLETE THE CONNECTION SHALL BE CONSIDERED SUBSIDIARY TO THE PROJECT.

X = Denotes Pipe to be abandoned in place.  
⌈ = Denotes Cap/Plug by the contractor  
(Includes removal of existing pavement and replacement with temporary pavement.)

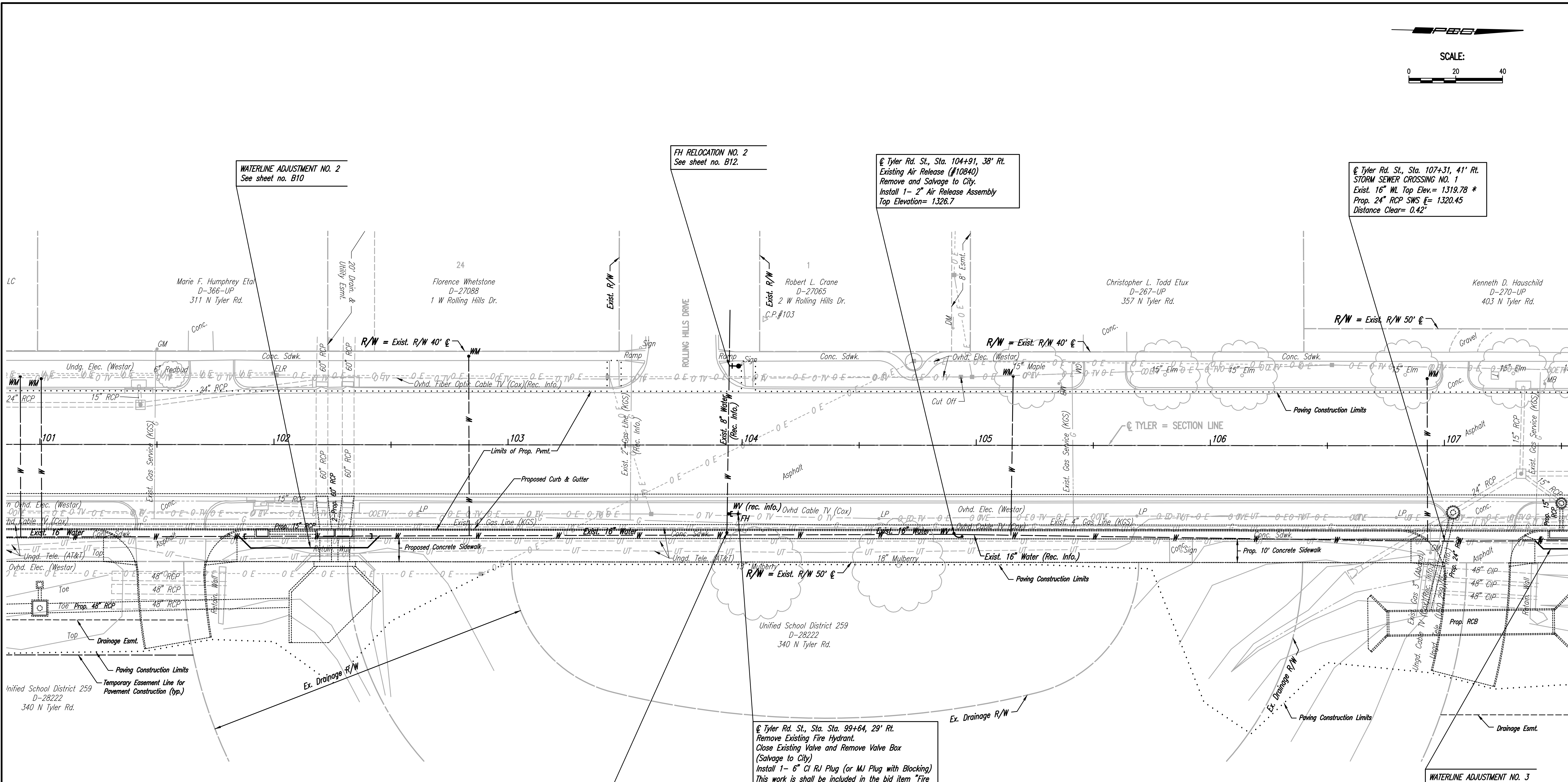

Scaled: 08-01-2017 3:08:53 PM by: CSL  
 Plot Scale: 1" = 40'-0" (1:480)  
 U:\Projects\159565-001\Miscellaneous\Drawings\159565-001-MISCELLANEOUS ADJUSTMENT PLAN

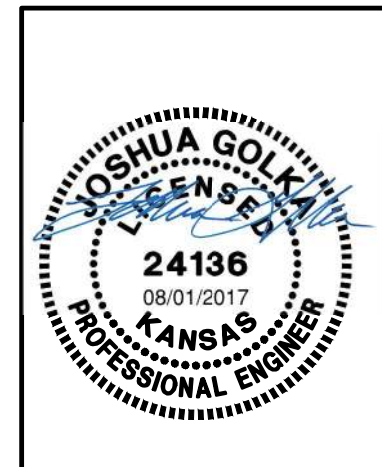

No.	Revision	By	Date
TYLER ROAD BETWEEN MAPLE AND CENTRAL WATERLINE ADJUSTMENTS <b>MISCELLANEOUS ADJUSTMENT PLAN</b> <b>STA. 101+00 TO STA. 107+00</b> GARY JANZEN, P.E. - CITY ENGINEER CITY OF WICHITA PROJECT NO. 448-90829			
		PROFESSIONAL ENGINEERING CONSULTANTS, P.A. 303 SOUTH TOPEKA WICHITA, KS 67202 316-262-2691 www.pec1.com	
Designed by	JAC, TBK	Job No.	35-15956-001
Drawn by	CSL, GAS	Date	MARCH 2017
			Sht. B5 of 20