

Tyler Rd. St., Sta. 113+23, 35' Rt.
Adjust Existing Water Valve Box (#10839)
Existing Top of Box Elev. = 1333.6
Proposed Top of Box Elev. = 1332.1
Difference = -1.5'

Tyler Rd. St., Sta. 113+74, 38' Rt.
Existing Air Release (#10838)
Remove and Salvage to City.
Install 1-2" Air Release Assembly
Top Elevation = 1332.4

Tyler Rd. St., Sta. 114+32, 39' Rt.
Adjust Existing Water Meter Box
Existing Top of Box Elev. = 1332.7
Proposed Top of Box Elev. = 1332.3
Difference = -0.4'

WATERLINE ADJUSTMENT NO. 5
See sheet no. B12

Tyler Rd. St., Sta. 116+30.47, 38' Rt.
Reconnect Existing Water Service Line to
new 16" Water Main. "SharkBite"
Couplings adapters as required.

Tyler Rd. St., Sta. 117+06.00, 36' Rt.
Existing 16" Waterline *
Install 1-16" Anchored Valve Assembly, Special
(Butterfly Valve) on Existing 16" Waterline.
Top Valve Box El. = 1326.9
This work shall be completed during night hours.
Contractor shall coordinate with the City of Wichita
and McDonalds.

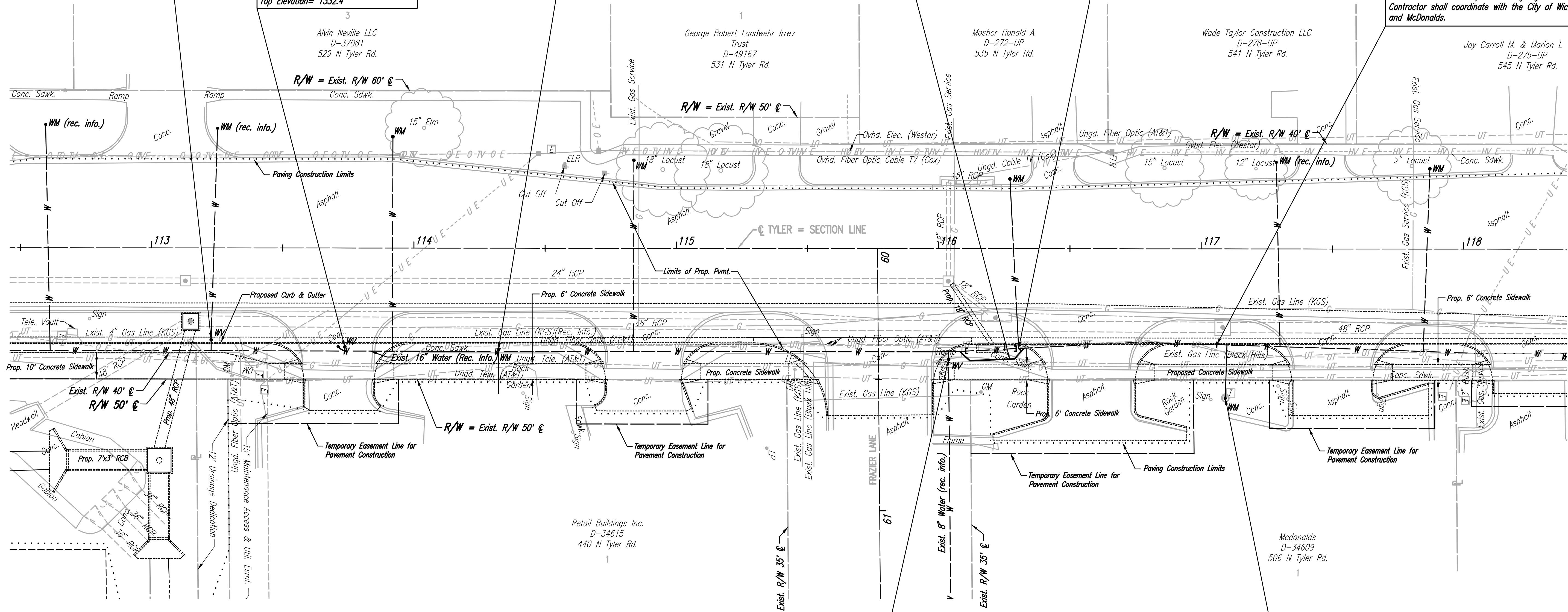

Tyler Rd. St., Sta. 116+04, 42' Rt.
Adjust Existing Water Valve Box (#18560)
Existing Top of Box Elev. = 1331.0
Proposed Top of Box Elev. = 1330.3
Difference = -0.7'

NO ADJUSTMENT NEEDED.

* PRIOR TO BEGINNING CONSTRUCTION, THE CONTRACTOR SHALL EXCAVATE THE EXISTING 16" WATERLINE TO VERIFY PIPE SIZE, TYPE, FITTINGS, AND HORIZONTAL AND VERTICAL LOCATION. THE CONTRACTOR SHALL REPORT HIS FINDINGS TO THE ENGINEER SO THAT ANY NECESSARY PLAN MODIFICATIONS CAN BE MADE. ANY ADDITIONAL LABOR OR MATERIALS NECESSARY TO COMPLETE THE CONNECTION SHALL BE CONSIDERED SUBSIDIARY TO THE PROJECT.

X = Denotes Pipe to be abandoned in place.
[] = Denotes Cap/Plug by the contractor
(Includes removal of existing pavement and replacement with temporary pavement.)

Scaled 07-28-2017 1:46:02 PM by CSI
 Plot Scale 1:1 08-01-2017 3:57:37 PM by CSI
 U:\Wichita-Civil\2015\15956\001\Drawings\15956-001-B07-MISCELLANEOUS ADJUSTMENT PLAN

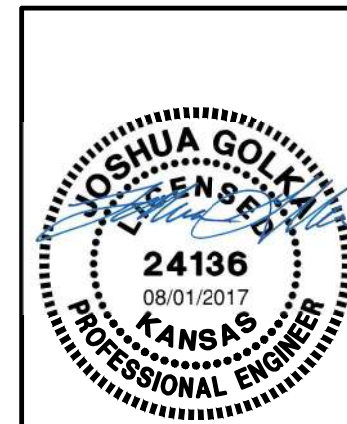

No.	Revision	By	Date
TYLER ROAD BETWEEN MAPLE AND CENTRAL WATERLINE ADJUSTMENTS MISCELLANEOUS ADJUSTMENT PLAN STA. 113+00 TO STA. 118+00 GARY JANZEN, P.E. - CITY ENGINEER CITY OF WICHITA PROJECT NO. 448-90829			
		PROFESSIONAL ENGINEERING CONSULTANTS, P.A. 303 SOUTH TOPEKA WICHITA, KS 67202 316-262-2691 www.pec1.com	
Designed by	JAC, TBK	Job No.	35-15956-001
Drawn by	CSL, GAS	Date	MARCH 2017
			Sht. B7 of 20