

| FHWA REGION NO. | STATE  | PROJECT NUMBER | FISCAL YEAR | SHEET NUMBER | TOTAL SHEETS |
|-----------------|--------|----------------|-------------|--------------|--------------|
| 7               | KANSAS | 87N-0191-01    | 2002        | 17           | 92           |

| REFERENCES NOTED | DATE |
|------------------|------|
|                  |      |
|                  |      |
|                  |      |
|                  |      |

SEE SHEET 5 FOR  
JOINT REPAIR DETAILS.

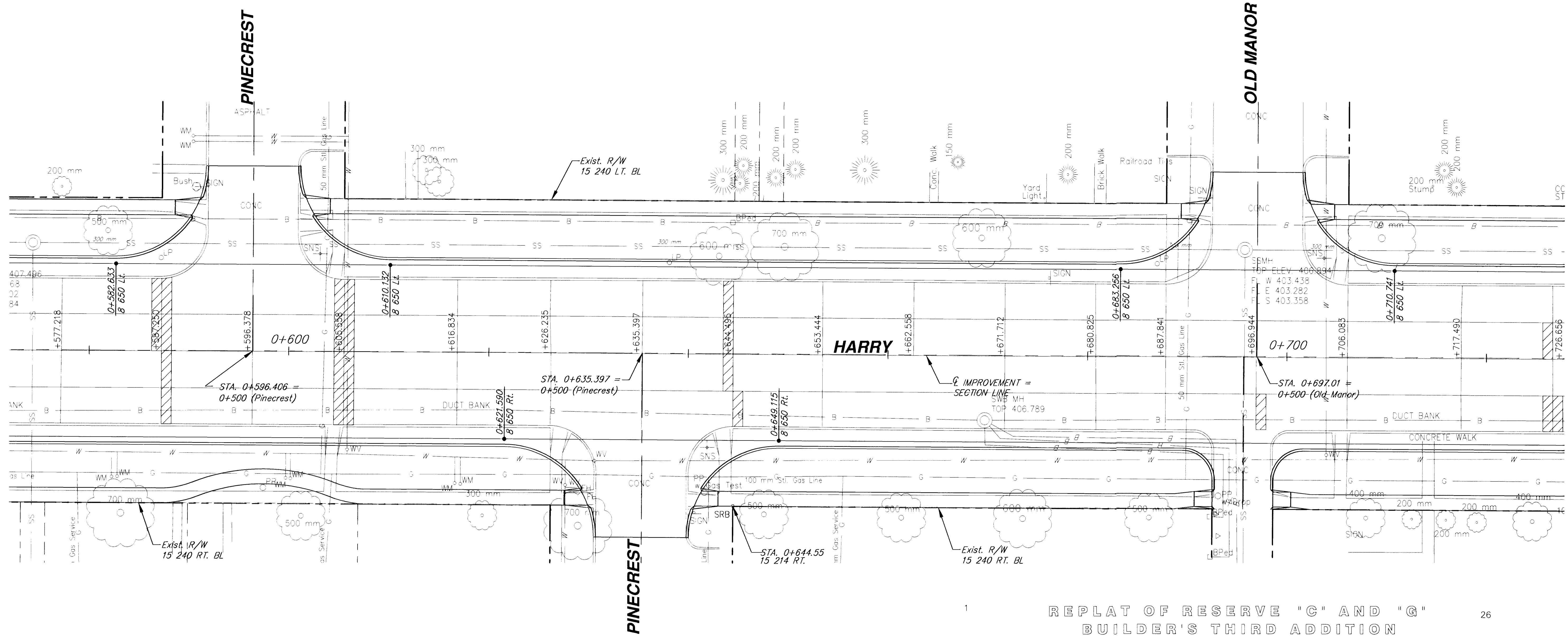

REPLAT OF RESERVE "C" AND "G"  
BUILDER'S THIRD ADDITION

26

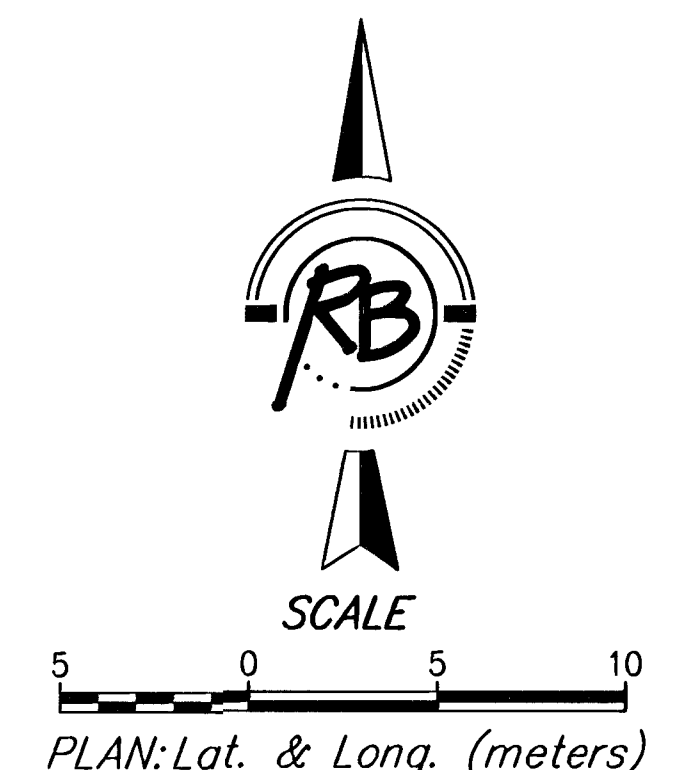

**HARRY PAVEMENT REPAIR**  
STATION 0+582.633 TO STATION 0+742.062  
WICHITA, KANSAS

|   |  |                                 |               |
|---|--|---------------------------------|---------------|
|   | <b>Ruggles &amp; Bohm, P.A.</b><br>Engineering, Surveying, Land Planning |                                 | DESIGN<br>MWS |
|   | 924 North Main<br>Wichita, Kansas 67203<br>www.rbkansas.com              |                                 | DRAWN<br>TEB  |
| (316) 284-8008<br>(316) 284-4621 fax<br>E-mail: info@rbkansas.com |  | REVIEW<br>TEB                   | SHEET<br>17   |
| PROJECT NUMBER<br>472-83685                                       |  | UTILITY<br>DATE<br>Feb. 3, 2003 | OF<br>92      |