

FHWA REGION NO.	STATE	PROJECT NUMBER	FISCAL YEAR	SHEET NUMBER	TOTAL SHEETS
7	KANSAS	87 N-0191-01	2002	49	92

BY	DATE
REFERENCES NOTED	
REFERENCES CHECKED	

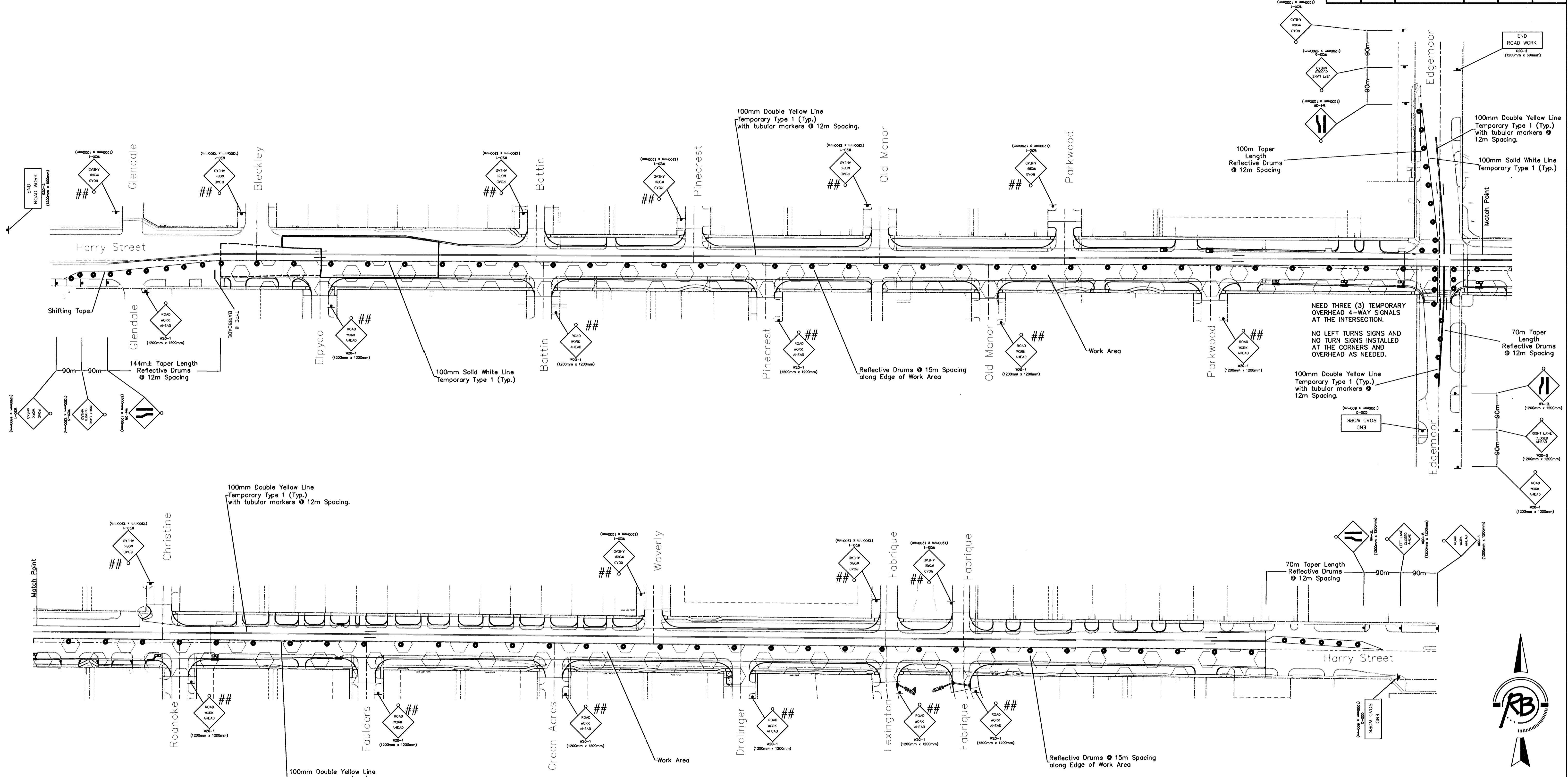

NEED THREE (3) TEMPORARY OVERHEAD 4-WAY SIGNALS AT THE INTERSECTION.
NO LEFT TURNS SIGNS AND NO TURN SIGNS INSTALLED AT THE CORNERS AND OVERHEAD AS NEEDED.

Taper Formula

$L = (SW)/1.6$ for speeds of 70 km/h or more
 $L = (WS^2)/157$ for speed of 60 km/h or less
 Where:
 L = minimum length of taper
 S = numerical value of posted speed prior to work
 W = width of offset

Legend

- Type III Barricade
- o Type B Warning Light
- Reflective Barrels/Drums
- ▲ Sign
- Traffic Flow

ADVANCE WARNING SIGNS PLACED AT FIRST INTERSECTION FROM HARRY (NORTH OR SOUTH). INSTALL W20-3 AS APPLICABLE.

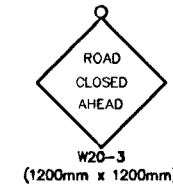

**Traffic Control – Phase 1
Harry Street – Oliver to Woodlawn
WICHITA, KANSAS**

Ruggles & Bohm, P.A.
 Engineering, Surveying, Land Planning
 924 North Main
 Wichita, Kansas 67203
 www.rbkansas.com
 (316) 264-8008
 (316) 264-4621 fax
 E-mail: info@rbkansas.com

DRAWING FILE	PROJECT NUMBER	DATE	SHEET
traffic-control.dwg	475-83685	Feb. 3, 2003	49 OF 92

