

MEDIAN LOCATION				
Pt. No.	Station	Offset	Elevation High Edge	Elevation Top Curb
1	25+99.99	8.50' Lt.	111.29	111.98
2	25+99.99	0.00' Rt.	111.46	112.13
3	25+99.99	8.50' Rt.	111.29	111.98
4	26+11.99	8.50' Lt.	111.32	112.01
5	26+11.99	0.00' Rt.	111.49	112.16
6	26+11.99	8.50' Rt.	111.32	112.01
7	27+42.75	8.50' Lt.	111.36	112.05
8	27+92.52	0.00' Rt.	111.45	112.12
9	27+95.94	8.50' Rt.	111.30	111.99
10	27+97.21	1.74' Rt.	111.44	112.09
11	27+99.38	5.65' Rt.	111.38	112.05
12	27+95.94	5.00' Rt.		Radius Point

Sta. 30+02.94 Seneca Const.  
Curb Inlet (Type II), 32.18' Lt.  
L=6'-1/2", W=3'-3/8"  
Dia.=5'-0"  
Inlet Top=112.15  
Install 15" x 23.68' Storm Swr. (RCP)(W)

Sta. 30+04.32 Seneca Const.  
Manhole (Type II)(Precast), 8.50' Lt.  
Dia.=4'-0"  
Manhole Top=112.23  
Install 18" x 154.17' Storm Swr. (RCP)(S)

Sta. 31+18.77 Seneca Install  
2-6" x 7.50' PVC Pipes with  
Curb Castings, 32.50' Lt. See  
Detail.  
US FI=112.05  
DS FI=112.01

Const. 8" Reinf. Conc. Alley  
Entrance. See Detail.

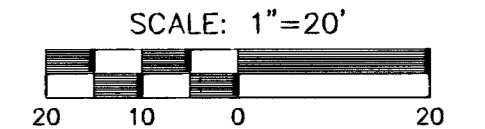

Sta. 27+82.23 Seneca Const.  
Manhole (Type II)(Precast), 8.50' Lt.  
Dia.=5'-0"  
Manhole Top=111.21  
Install 30" x 67.92' Storm Swr. (RCP)(N)

Sta. 28+39.52 Seneca Const.  
8" Reinf. Conc. Valley Gutter

Sta. 49+34.23 Texas, Install  
Temporary Plug, 10.31' Lt.

Sta. 49+34.28 Texas Remove at  
Joint & Match Exist. Pavement

Sta. 49+40.23 Texas Const.  
Std. Manhole (Type P), 10.34' Lt.  
Dia.=5'-0"  
Manhole Top=111.19  
Install 30" x 6.00' Stub (RCP)(W)

Sta. 49+37.34 Texas Const.  
Curb Inlet (Type I), 22.00' Lt.  
L=6'-4", W=4'-4"  
Inlet Top=111.39  
Install 15" x 12.09' Storm Swr. (RCP)(S)

Sta. 28+50.15 Seneca Const.  
Manhole (Type II)(Precast), 8.50' Lt.  
Dia.=5'-0"  
Manhole Top=111.68  
Install 30" x 51.22' Storm Swr. (RCP)(W)

Remove and Install  
7 S.Y. of 4" Conc.  
Sidewalk

Remove and Install  
15 S.Y. of 8" Conc.  
Pavement

Const. 8" Reinf. Conc. Drive  
Entrance (Full Ramp)

Adjust Exist. SWB MH  
Exist. MH Top=  
Prop. MH Top=112.06

Adjust Exist. SWB MH  
Exist. MH Top=  
Prop. MH Top=111.89

Sta. 30+04.32 Seneca Const.  
Driveway Grated Inlet (Single), 31.75' Rt.  
L=5'-1", W=3'-5"  
Inlet Top=111.80 (High Edge)  
Install 15" x 40.25' Storm Swr. (RCP)(W)

Sta. 50+45.87 Texas Const.  
Std. Manhole (Type "P"), 45.86' Rt.  
Dia.=4'-0"  
Manhole Top=111.89  
Install 18" x 55.30' Storm Swr. (RCP)(SW)  
Plug 15" RCP (S) Connect Exist. 15" RCP (E)

Sta. 50+68.85 Texas Const.  
Curb Inlet (Type II), 19.40' Rt.  
L=6'-2-1/2", W=3'-4-3/8"  
Inlet Top=111.17  
Install 15" x 34.57' Storm Swr. (RCP)(SW)

Sta. 50+90.90 Texas, Saw  
Cut & Match Exist. Pavement

Sta. 28+39.52 Seneca, Const.  
8" Reinf. Conc. Valley Gutter

Remove Drive Entrance and Install  
28.4 L.F. of 6" Combined Curb  
& Gutter

Const. Std. Wheelchair  
Ramp (Typ).

Const. Std. Wheelchair  
Ramp (Type D) (Typ).

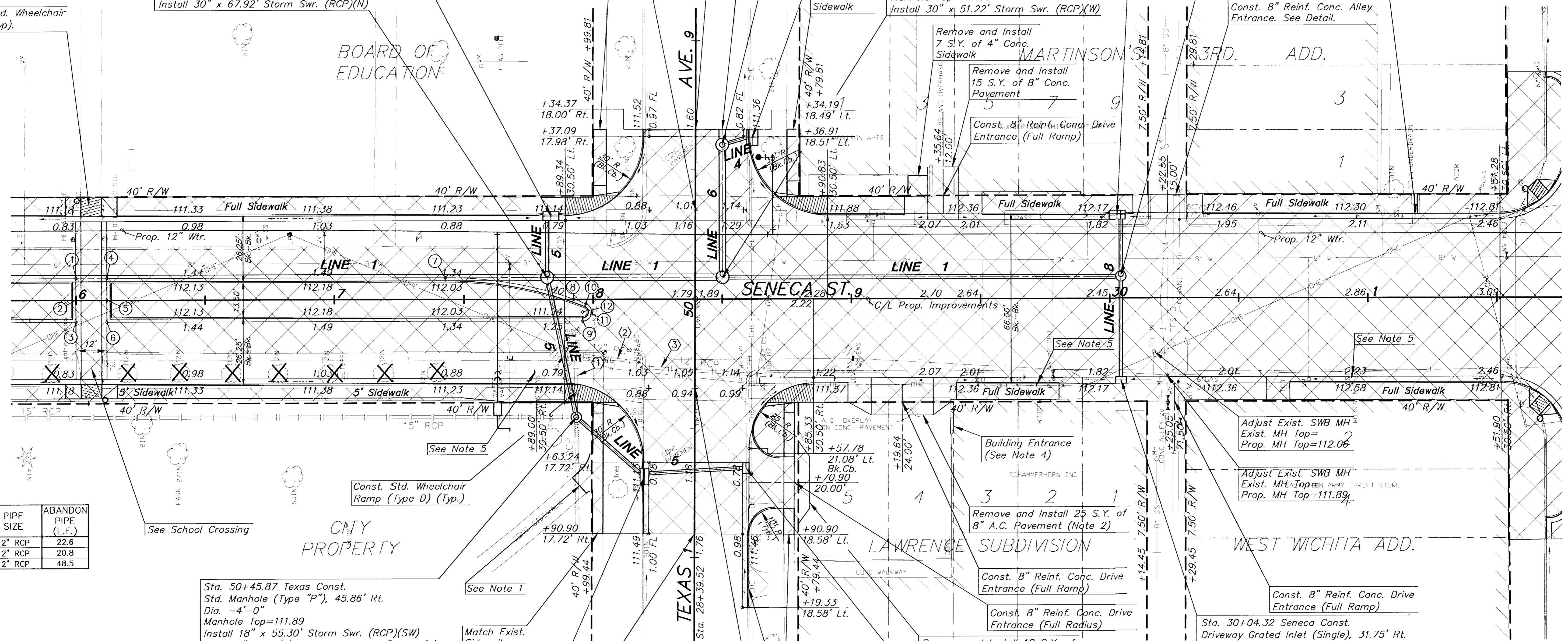

PIPE NO.	PIPE SIZE	ABANDON PIPE (L.F.)
①	12" RCP	22.6
②	12" RCP	20.8
③	12" RCP	48.5

CENTERLINE VERTICAL CONTROL			
Station	P.V.I.	P.V.I. Elevation	Vertical Curve
26+83.09	H.P.	111.71	No
27+86.02	L.P.	111.40	No
28+39.52		111.79	No
29+35.64	H.P.	112.70	No
30+04.32	L.P.	112.43	No
31+51.28		113.09	No

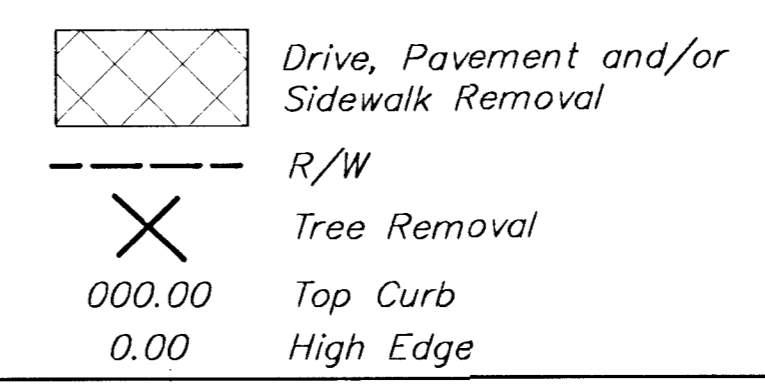

**MKEC**  
ENGINEERING CONSULTANTS  
411 N. WEBB ROAD  
WICHITA, KS. 67208  
316-684-9600

**SENECA STREET**  
PROJECT NAME

**PAVING PLANS**  
SHEET TITLE

DESIGN BY: **DCH, ASH**      DRAWN BY: **WNJ**      CHECKED BY: **GJA**

DATE: **OCT. 2001**      DRAWING NAME: **98092\_E2**      SHEET OF: **6 / 87**

- Notes:
1. Remove and Install Sidewalk 3' Min. beyond Right-of-Way to match Existing.
  2. Coordinate drive entrance closure and construction with Kendall Wendt, 268-8659.
  3. Remove or abandon storm water sewer structures as required (Typ.). Payment Subsidiary to other bid items.
  4. Existing ADA accessibility shall be maintained on pavement at entrance. Provide 5'x5' landing area with slope no greater than 2.0%. Paved access to landing area shall not exceed 5.0%.
  5. See Pavement Marking and Signing Plan.

6: \\CIVIL\98092\PAVE\98092\_E2.dwg Thu Oct 25 11:39:56 2001