

**RECOMMENDED CONSTRUCTION SEQUENCE AND TRAFFIC HANDLING**

PHASE	HANDLING OF TRAFFIC	MAJOR CONSTRUCTION ITEMS	REMARKS
I	Traffic to be 2 - 10' minimum width lanes, two way on the West half of Seneca between Maple Street and McLean. Maintain two way East-West traffic on Douglas and on 2nd Street.	The contractor will install the storm system to the extent possible between 2nd Street and McLean. Upon completion of the storm system, 7" temporary asphalt pavement to be constructed to limits of removal as shown on paving plans. At the intersection of 2nd Street and Seneca Street, the contractor will install temporary traffic signal system. Existing traffic detection loops will not be utilized. The contractor will complete the construction of the proposed 24" water line to the extent possible. At the intersection of Douglas and Seneca Street, the contractor will complete construction of the proposed 12" water line to the extent possible. Temporary asphalt surfacing (7" thickness) will be used where existing pavement was removed for construction of the water lines. The contractor will construct 1 1/2" temporary asphalt overlay 12' width along the East side (North bound outside lane) of Seneca. The overlay will extend to the face of the existing East curb. (See schedule for length of temporary asphalt.)	Contractor will maintain access to properties. The contractor must insure that adequate protection is maintained for all open excavations. Temporary closures at driveways will be permitted with prior notification to owner. Temporary closures at minor side streets will be permitted with proper advanced traffic control, otherwise side streets shall remain open to the extent possible. Flaggers will be utilized as needed to control asphalt delivery trucks in and out of the work zone. Temporary flagging of traffic may be used where utility construction abuts traffic lanes.
II	South bound Traffic to be 1 - 10' minimum width lane, on the West side of Seneca between Maple Street and McLean. North bound traffic to be 1 - 10' minimum width lane on the East side of Seneca between Maple Street and McLean.	The contractor will complete 1 1/2" temporary asphalt overlay along North bound inside lane of Seneca to the centerline of existing roadway. (See schedule for length of temporary asphalt.)	Contractor will maintain access to properties. Temporary closures at driveways will be permitted with prior notification to owner. Temporary closures at minor side streets will be permitted with proper advanced traffic control, otherwise side streets shall remain open to the extent possible. Flaggers will be utilized as needed to control asphalt delivery trucks in and out of the work zone.
III	Traffic to be 2 - 10' minimum width lanes, two way on the East half of Seneca between Maple Street and McLean. East-West traffic at 2nd Street and Douglas will be phased to accommodate construction while maintaining traffic through construction.	The contractor will complete all items of construction to the extent possible on the West half of Seneca. Construction will be phased at 2nd Street and Douglas to complete West half of the intersection. Traffic control items will be used to maintain traffic through construction.	Contractor will maintain access to properties. The contractor must insure that adequate protection is maintained for all open excavations. Construction operations will be phased at side streets and entrances to allow continued use of the points of access. Flaggers will be utilized as needed to control construction equipment in and out of the work zone.
IV	Traffic to be 2 - 10' minimum width lanes, two way on the West half of Seneca between Maple Street and McLean. East-West traffic at 2nd Street and Douglas will be phased to accommodate construction while maintaining traffic through construction.	The contractor will complete all items of construction to the extent possible on the East half of Seneca. Construction will be phased at 2nd Street and Douglas to complete East half of the intersection. Traffic control items will be used to maintain traffic through construction.	Contractor will maintain access to properties. The contractor must insure that adequate protection is maintained for all open excavations. Construction operations will be phased at side streets and entrances to allow continued use of the points of access. Flaggers will be utilized as needed to control construction equipment in and out of the work zone.

**GENERAL NOTES**

Contractor shall be responsible for changes to all traffic signals including controlling of loop detectors.

All signs and pavement markings conflicting with this traffic control shall be covered or removed as directed by the engineer and replaced according to the pavement marking and signing plan.

Temporary pavement markings shall be paint except at intersections, and except where permanent pavement has been constructed. Type I or II tape shall be used otherwise.

As the various construction activities progress, certain situations may arise which will preclude adhering to the original construction sequence or which in the opinion of the contractor, would readily adapt themselves to a more efficient phasing operation. Should this occur, the contractor may submit to the engineer an alternative plan for approval.

Contractor shall maintain existing drainage system nearly as possible during construction, or supplement the existing system with ditches and temporary pipes. Temporary pipes shall be removed or filled with grout before final construction.

NOTE: All work required for traffic control shall be bid as "Traffic Control" lump sum

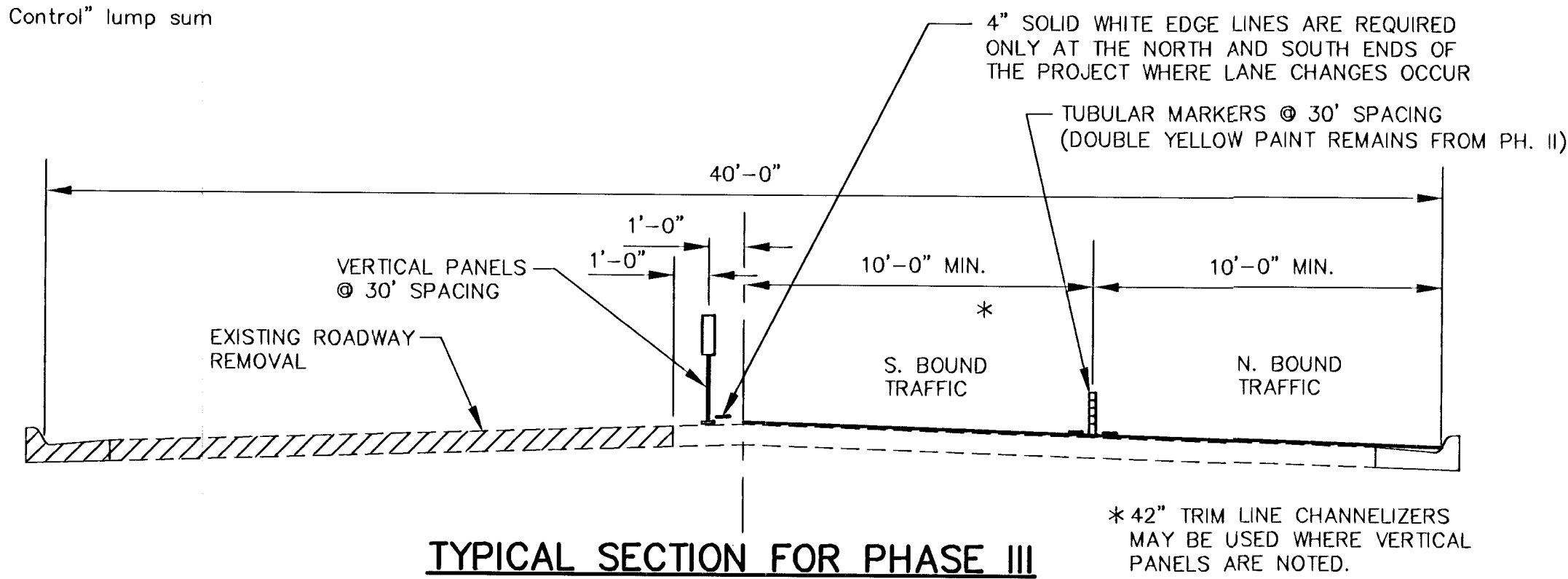
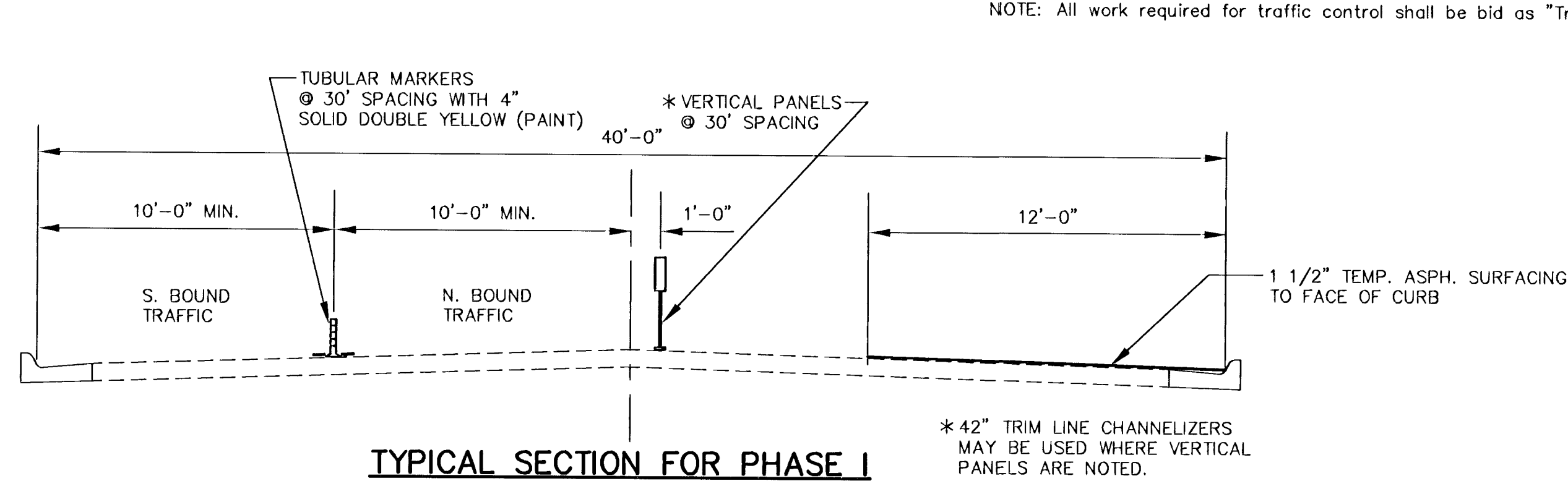

**LENGTH OF 1 1/2" TEMP. ASPHALT**

BEGINNING STATION	ENDING STATION
22+06	31+50
35+98	45+50
46+38	52+55

For Information only. See street recap sheet for quantities.

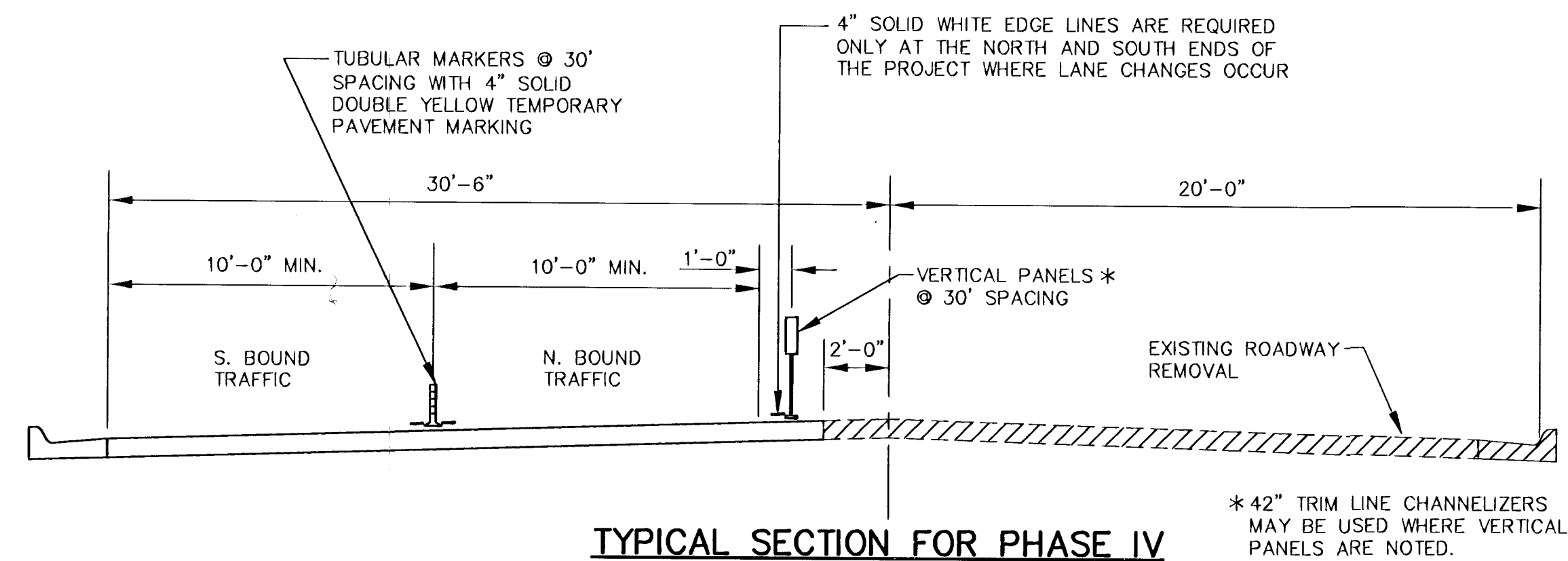
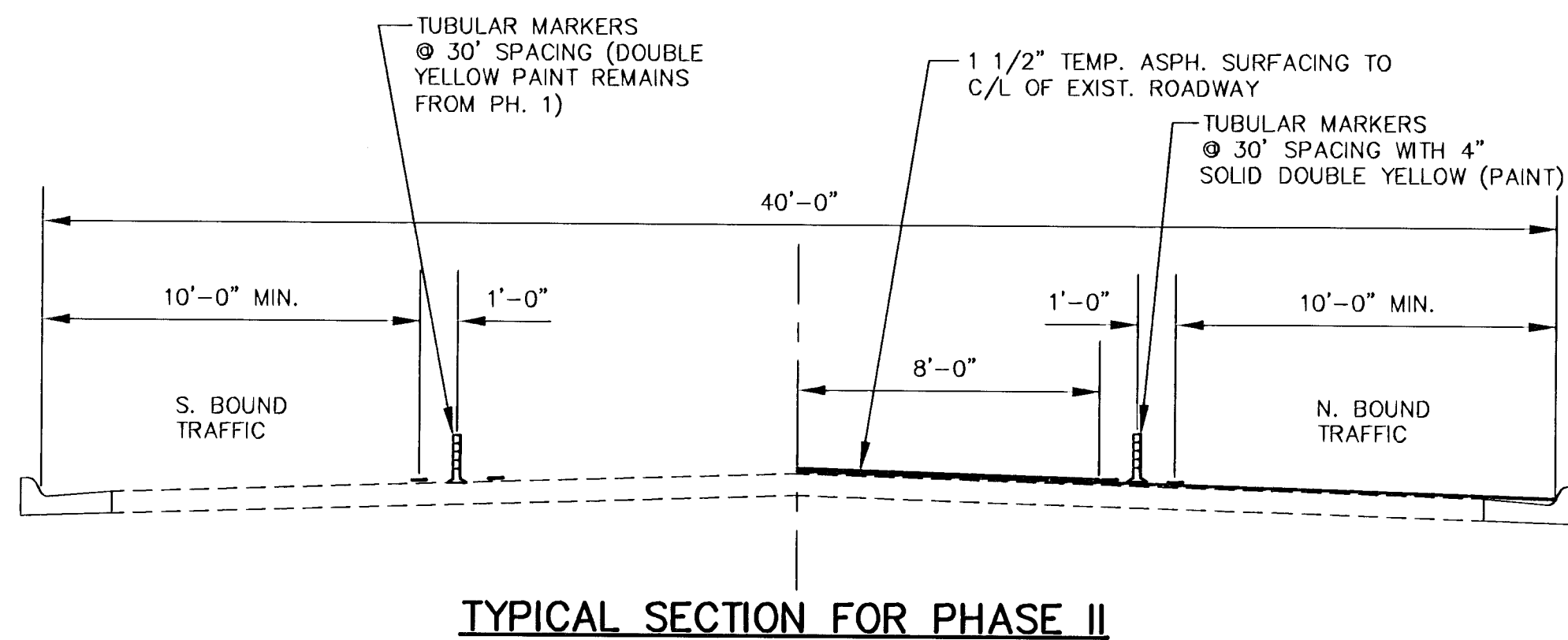

G:\CIVIL\98092\TRAFCONT\1\AGSUMM.dwg



**SENECA STREET**  
PROJECT NAME

**CONSTRUCTION SEQUENCE AND TRAFFIC HANDLING**  
SHEET TITLE

DESIGN BY: MJV DRAWN BY: GJR CHECKED BY: GJA

DATE: OCTOBER 2001 JOB NO.: 98092 SHEET/OF: 63 / 87

G:\CIVIL\98092\TRAFCONT\1\AGSUMM.dwg Mod Oct 24 17:30:57 2001