

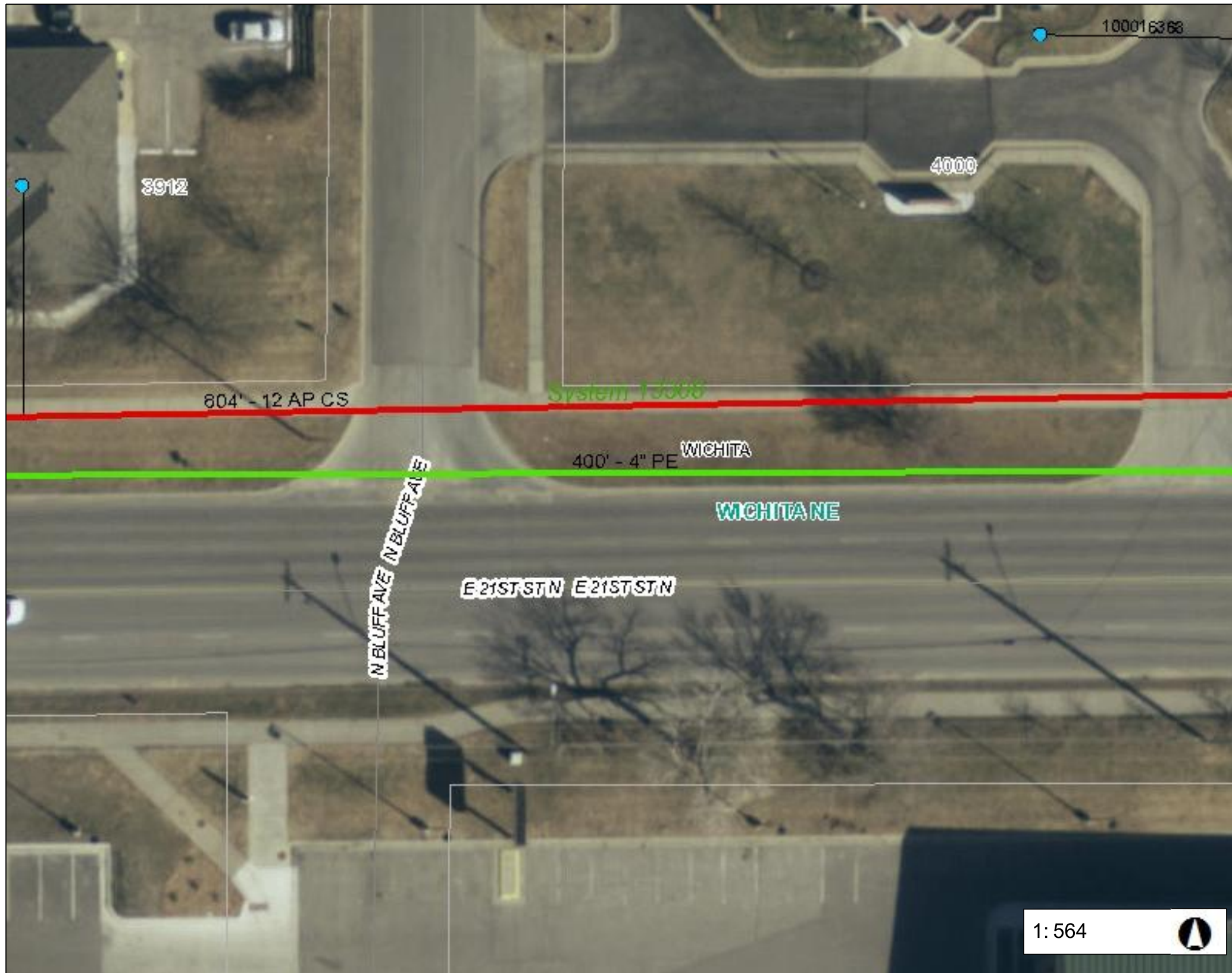

# 21st and Bluff Map



## Legend

- Pinch Point
- Pipe Line Marker
- In Active Well Head
- Placard
- Marker Ball
- Cast Iron Sample
- Exceptionally Deep Main
- CP Bond Junction
- CP Cable
- Bond Wire
- Rectifier Cable
- CP Ground Bed
- CP Rectifier
- CP Anode
- CP Test Station
- CP System Label
- Controllable Fitting
- Short Stop
- 3-Way Tee
- Tapping Tee
- Meter Setting
- Gas Valve
- Critical/Inspection Not Required
- Critical/Inspection Required
- Non-Critical
- Regulator Station
- Town Border Station
- Drip
- Non Controllable Fitting
- Other Non Controllable Fittings
- Insulated Coupling
- Service Point
- Gas Main
  - Steel
  - Wrapped Steel
  - PE
  - PVC
  - Cast Iron
  - Ductile Iron
  - Copper
  - Wrought Iron
  - ABS
  - Extruded Tubing
  - Plastic
- Gas Pipe Casing
- Service Line
  - Operating
  - Pending
  - Decommissioned
- Abandoned Gas Main
- Location Notes
- Pipe Exposure (from Maximo)
- Service Line (New Assets)
- Service Line - Pending Decommission
  - Potentially Active, Pending Decommission
  - Offset - Potentially Active, Pending Decommission
- Valve

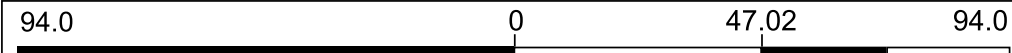

WGS\_1984\_Web\_Mercator\_Auxiliary\_Sphere  
© Latitude Geographics Group Ltd.

DISCLAIMER: This document and information herein is a visual representation and approximation of ONE Gas facilities and is subject to revision at any time without notice. It is an informational tool and is not guaranteed, warranted, or represented to be to scale, complete, accurate, or depicting depth. ONE Gas disclaims any and all liability for same. Call 811 by dialing 811 prior to and excavation.

Notes