

FHWA REGION NO.	STATE	PROJECT NUMBER	FISCAL YEAR	SHEET NUMBER	TOTAL SHEETS
7	KANSAS	CMQ-N022 (901)	2002	36	62

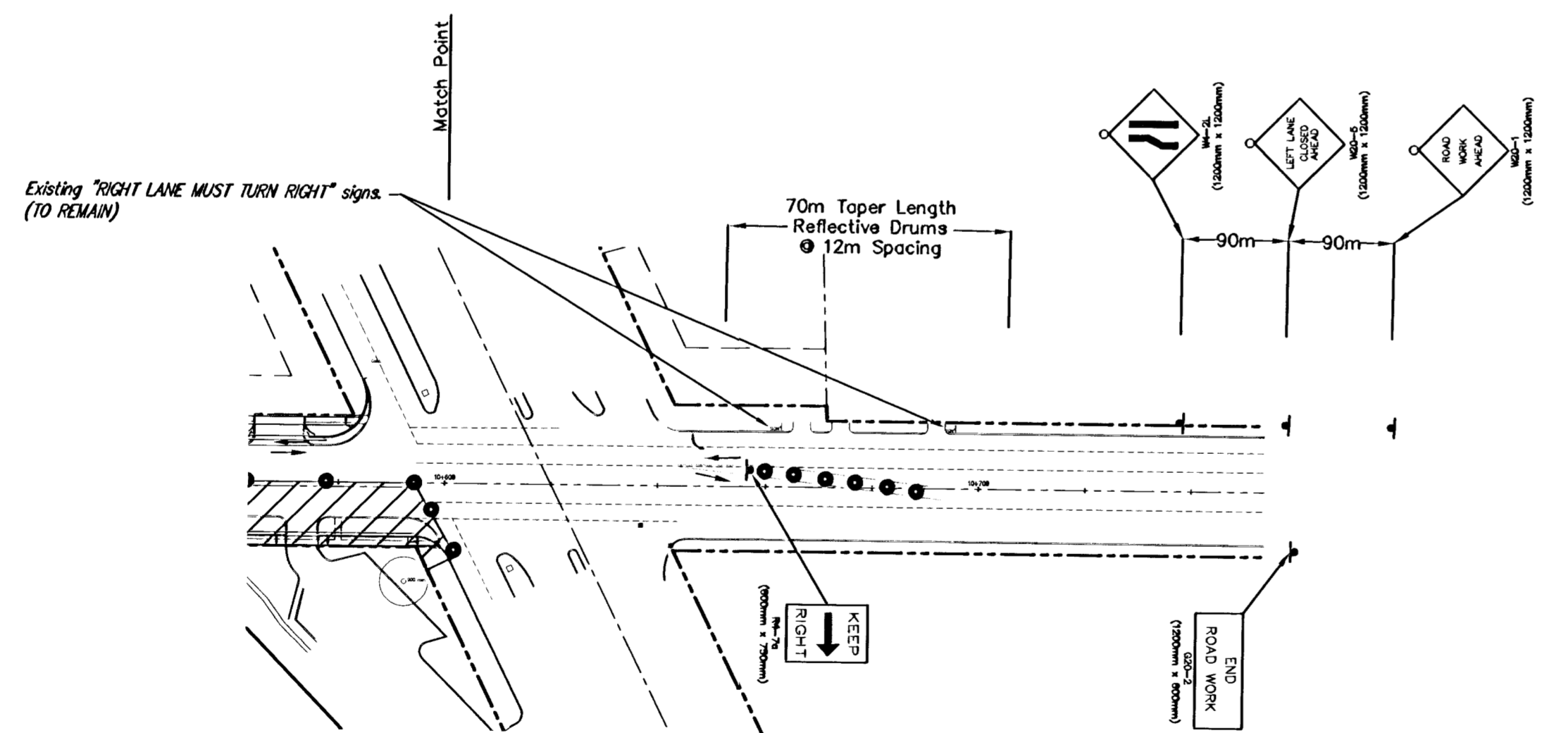
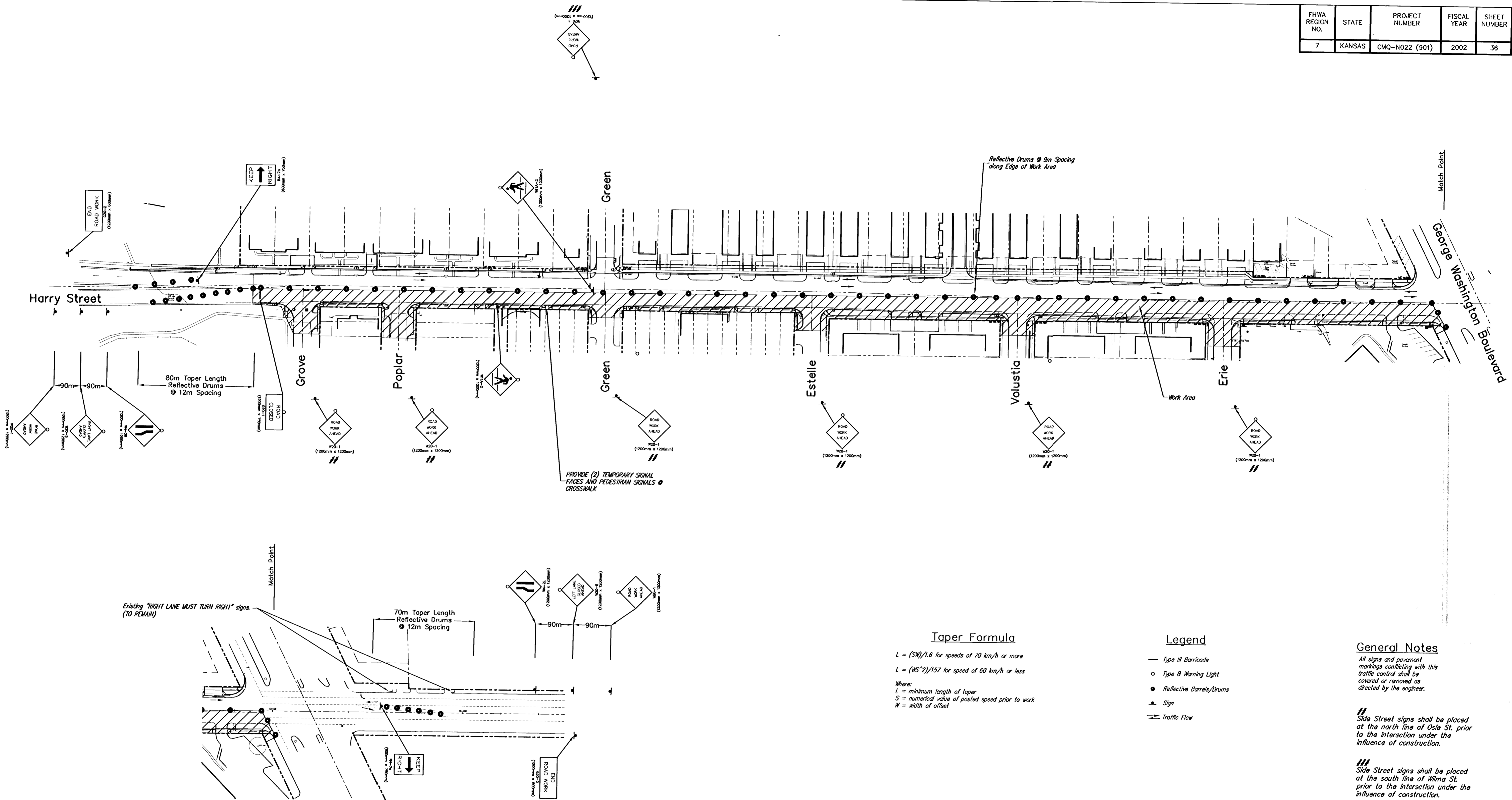

Taper Formula

$L = (SW)/1.6$ for speeds of 70 km/h or more
 $L = (WS^2)/157$ for speed of 60 km/h or less
 where:
 L = minimum length of taper
 S = numerical value of posted speed prior to work
 W = width of offset

Legend

- Type III Barricade
- Type B Warning Light
- Reflective Barrels/Drums
- ▲ Sign
- ⇒ Traffic Flow

General Notes

All signs and pavement markings conflicting with this traffic control shall be covered or removed as directed by the engineer.

Side Street signs shall be placed at the north line of Osie St. prior to the intersection under the influence of construction.

Side Street signs shall be placed at the south line of Wilma St. prior to the intersection under the influence of construction.



Traffic Control – Phase 2 Harry Street – I-135 to George Washington Blvd. WICHITA, KANSAS			
	Ruggles & Bohm, P.A. Engineering, Surveying, Land Planning		DESIGN MWS DRAWN MWS REVIEW MWS
	924 North Main Wichita, Kansas 67203 www.rbkansas.com		(316) 264-8008 (316) 264-4621 fax E-mail: info@rbkansas.com
DRAWING FILE BASE-traffic: traffic-control2		PROJECT NUMBER 472-83686	
		SHEET 36 OF 62	DATE May 4, 2004