

FHWA REGION NO.	STATE	PROJECT NUMBER	FISCAL YEAR	SHEET NUMBER	TOTAL SHEETS
7	KANSAS	87N-0080-01	1997	21	162

DATE	
BY	
REFERENCES NOTED	
REFERENCES CHECKED	

STATION 1+080.000 LT., CONSTRUCT INLET (TYPE II) (CURB).
INSTALL 450 mm x 1.943 m STORM SEWER (RCP) (E.).
SEE SHEETS 34, 62

STATION 1+080.000, 2.744 LT., CONSTRUCT MANHOLE (TYPE P) (1.525 m DIA.).
INSTALL 900 mm x 58.818 m STORM SEWER (RCP) (N.).
SEE SHEETS 22, 66

STATION 1+140.344, 2.744 LT., CONSTRUCT MANHOLE (TYPE P) (1.525 m DIA.).
INSTALL 450 mm x 17.940 m STORM SEWER (RCP) (E.).
INSTALL 900 mm x 104.958 m STORM SEWER (RCP) (N.).
SEE SHEETS 37, 62

REMOVE (1) MANHOLE AND (5) CURB INLETS THIS INTERSECTION
REMOVE 600 mm STORM SEWER PIPE (N). ABANDON REMAINING PIPE.

STATION 1+140.344 LT., CONSTRUCT INLET (TYPE II) (CURB).
INSTALL 450 mm x 1.943 m STORM SEWER (RCP) (E.).
SEE SHEETS 22, 66

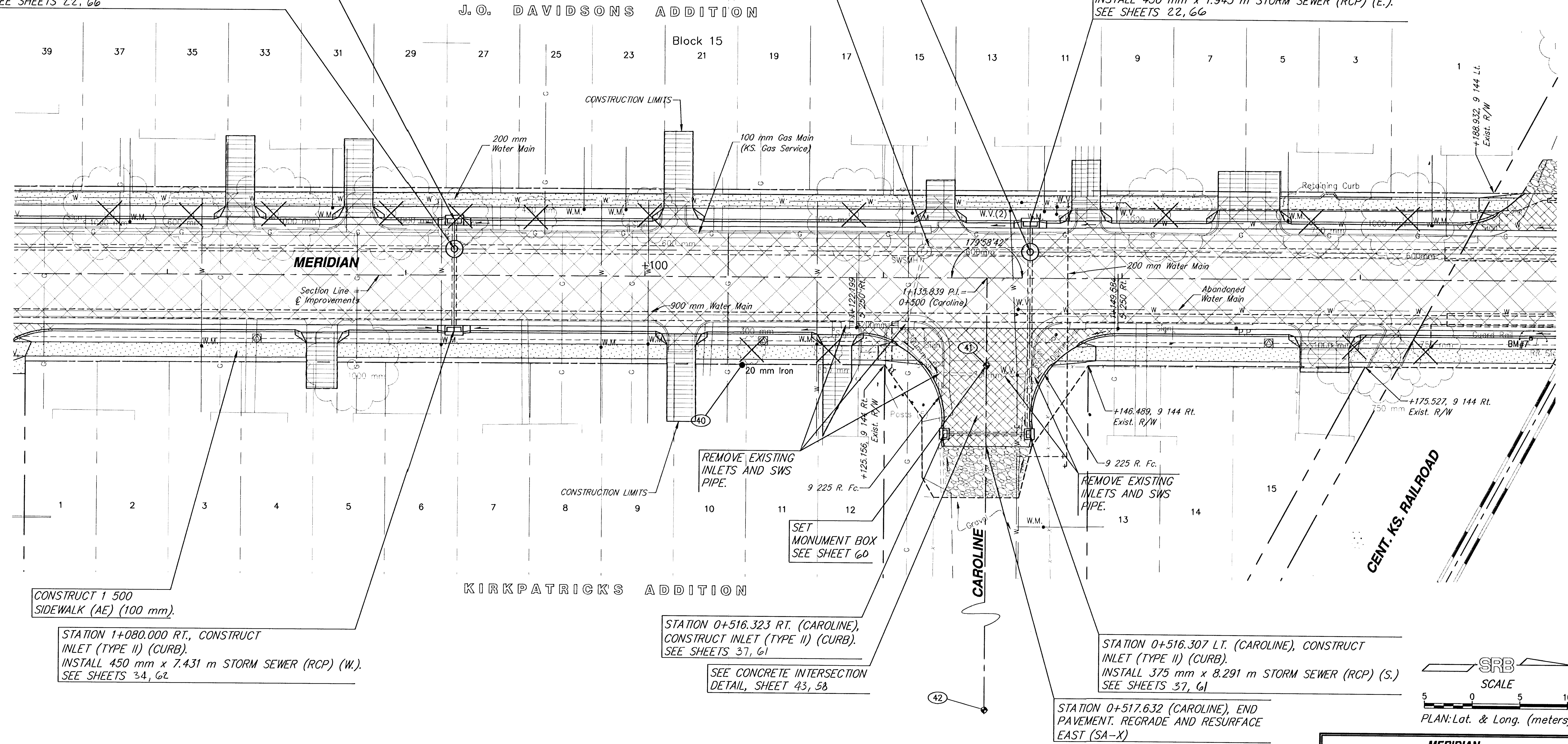

CONSTRUCT 1 500 SIDEWALK (AE) (100 mm).

STATION 1+080.000 RT., CONSTRUCT INLET (TYPE II) (CURB).
INSTALL 450 mm x 7.431 m STORM SEWER (RCP) (W.).
SEE SHEETS 34, 62

STATION 0+516.323 RT. (CAROLINE), CONSTRUCT INLET (TYPE II) (CURB).
SEE SHEETS 37, 61

SEE CONCRETE INTERSECTION DETAIL, SHEET 43, 58

STATION 0+516.307 LT. (CAROLINE), CONSTRUCT INLET (TYPE II) (CURB).
INSTALL 375 mm x 8.291 m STORM SEWER (RCP) (S).
SEE SHEETS 37, 61

STATION 0+517.632 (CAROLINE), END PAVEMENT. REGRADE AND RESURFACE EAST (SA-X)

BM #7 TOP SW BOLT AT BASE OF RAILROAD SIGNAL LIGHT EAST SIDE OF MERIDIAN.
ELEV. 397.882

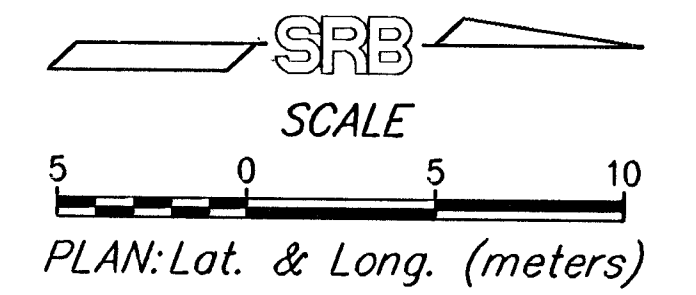

MERIDIAN STATION 1+035 TO STATION 1+180				
SRB	924 NORTH MAIN WICHITA, KANSAS 67203 http://www.srb.com/~srb	316-264-8008 FAX: 316-264-8021 E-Mail: srb@srb.com	REVISED	
SAVOY, RUGGLES & BOHM, P.A. ENGINEERING & SURVEYING				
PROJECT NUMBER 472-76-245-82740-000-000-001				
DRAWN J. Long/TEB	DESIGN T.C.R.	DATE Jan. 8, 1999	UTILITY SRB JOB 539T	21 162