

BENCHMARKS:
BM #1: City of Wichita Benchmark Disk at South End of Hubguard on the SW Cor. of R.C.B.C., West Side of Rock Road, 706' North-Northwest of the Northwest corner of Lot 44, Block A, Rocky Ford Addition Elev. = 1367.92 NAVD88

BM #2: "□" on Fence Footing under warning US Airforce Installation Sign West of Rock Road, 400' N. of W₁/4 Cor. Elev. = 1377.45 NAVD88

BM #3: "□" on Northeast Cor. Headwall RCP. East of Rock Road and South of Arnold Blvd. Elev. = 1376.10 NAVD88

BM #4: "□" on Top of Curb by Fire Hydrant. South of Concrete Drive at 2800 S. Rock Road. Elev. = 1379.84 NAVD88

NOTE:
 Contractor to minimize service outage of existing 12" Line extending west to serve McConnell Air Force Base.

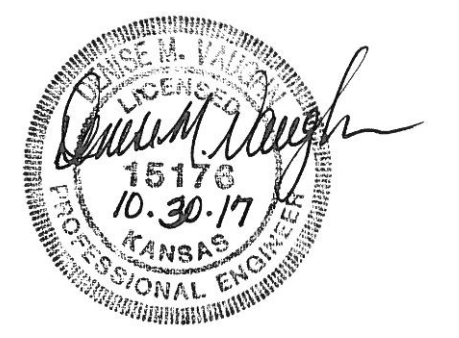
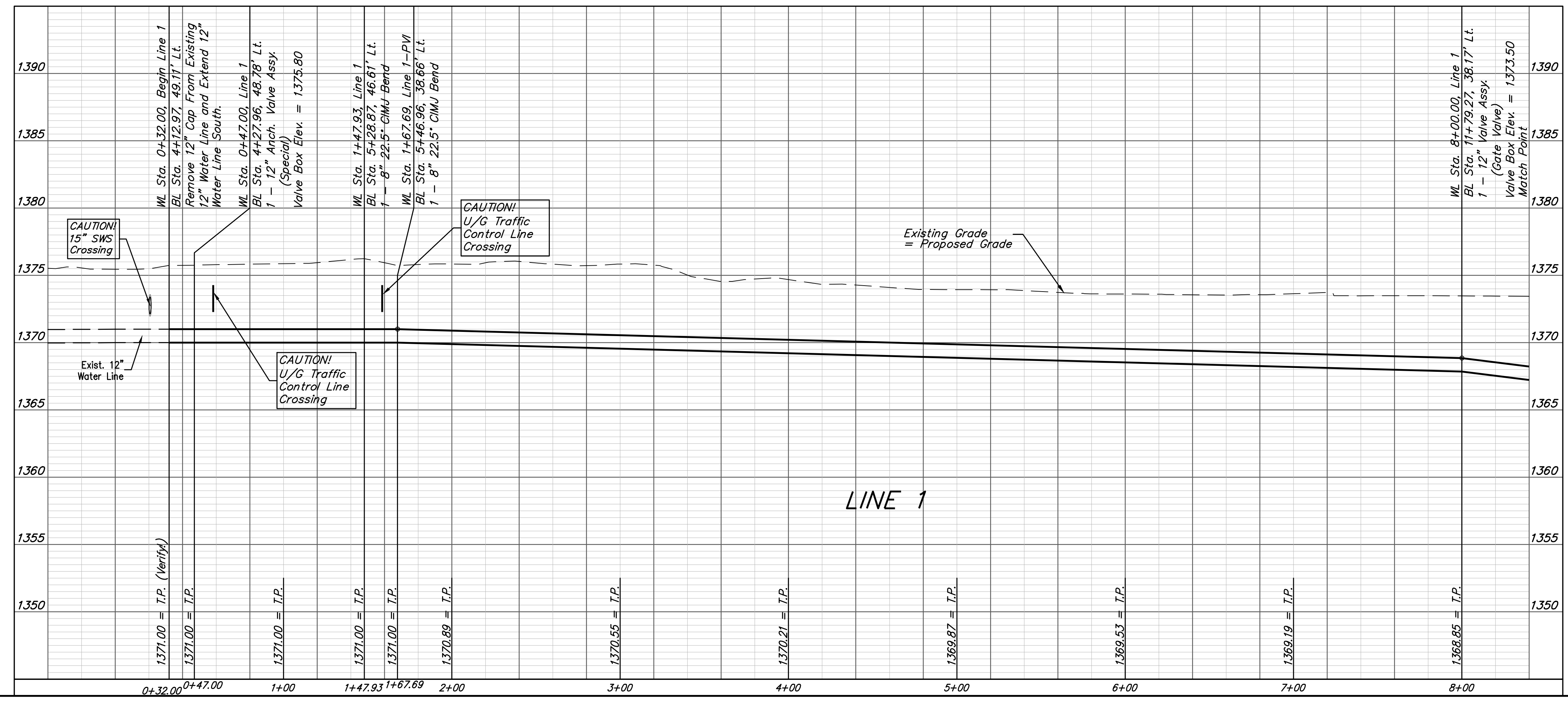
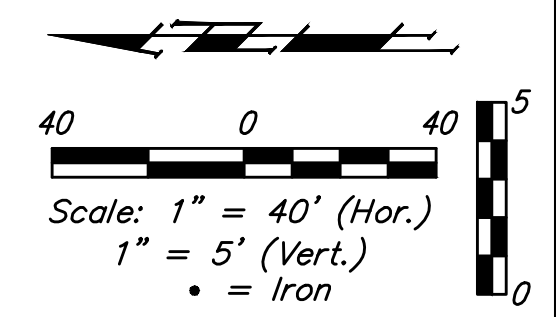

		Rocky Ford Addition	
		LINE 1	
Baughman Company, P.A. 315 Ellis St. Wichita, KS 67211 P 316-262-7271 F 316-262-0149		ENGINEERING SURVEYING PLANNING LANDSCAPE ARCHITECTURE	
PROJECT NUMBER 448-90350	DESIGN DMV	DRAWN DHL	DATE 10/29/17
REVISIONS:	APPROVED	SCALE Noted	SHEET
		4 OF 17	