

ADJUST VALVE BOX, FIRE HYDRANT & WTR. METER					
STATION	OFFSET (m)	DESCRIPTION	EXIST. ELEV.	PROP. ELEV.	REMARKS
3+415.9	12.6 LT.	SSMH	52.10	52.20	

FHWA REG. NO.	STATE	PROJECT NO.	YEAR	SHEET NO.	TOTAL SHEETS
7	KANSAS	STP-N012(901)	1999	5	131

DATE	BY

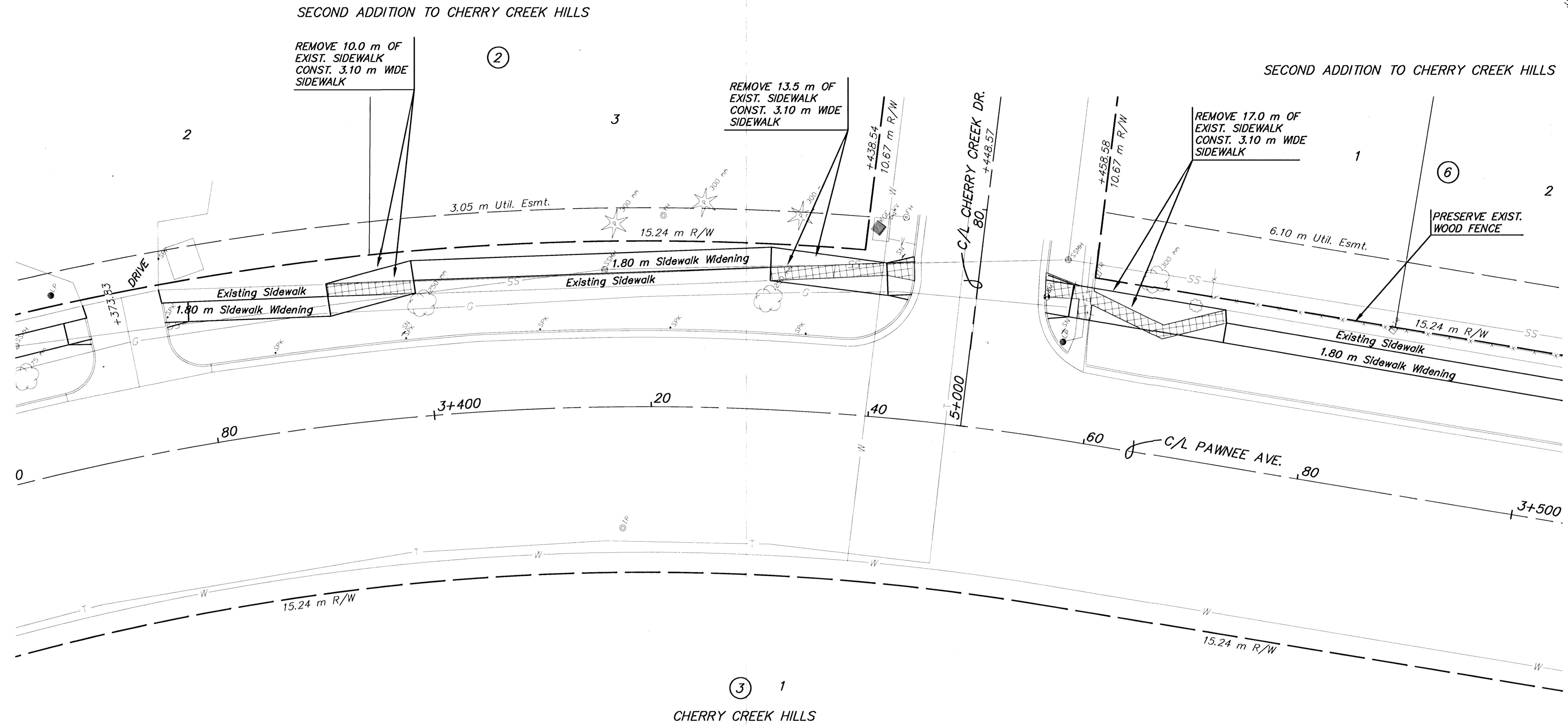

BM #8 Square Cut on TC @ Easterly end of SE curb return @ Pawnee & Cherry Creek. 12.82 m Lt. of Pawnee C/L. Sta. 3+454.67 Elev.=52.429

- UTILITY OWNERS**
- TV - Cox Communications (316)262-4270
  - P1 - 12" Williams Natural Gas 1-800-324-9696
  - P2 - 20" Williams Natural Gas 1-800-324-9696
  - P3 - 4" Raytheon Aircraft (316)676-6867
  - P4 - 4" Raytheon Aircraft (316)676-6867
  - P5 - 18" Williams Natural Gas 1-800-324-9696
  - P6 - 6" Conoco Pipe Line Co. 1-800-231-2551
  - G - 6" Kansas Gas Service (316)832-3168
  - E - KCE (316)261-6944
  - SS - City of Wichita Water & Sewer Dept. (316)262-6000
  - SWS - City of Wichita Water & Sewer Dept. (316)262-6000
  - T - Southwestern Bell Telephone Co. 1-800-734-7590
  - W - 16" City of Wichita Water & Sewer Dept. (316)262-6000

**Legend**  
 Pavement, Median, Driveway and/or Sidewalk Removal

NO.	DATE	REVISIONS	BY	APP'D
2				
1				

KANSAS DEPARTMENT OF TRANSPORTATION

**PAWNEE AVE.**  
**STA. 3+380 TO STA. 3+500**  
 PROJ. NO. 87 STP-N-0129-01

**MKEC ENGINEERING CONSULTANTS, INC.**  
 WICHITA, KANSAS

DESIGNED BY: JTC	CHECKED BY: GJA
DRAWN BY: GJR,MLW	DATE: JUNE 1999 SHEET 5 OF 131

G:\CIVIL\PAW-NEBB\98171\PAW\98171E3.DWG

6: \CIVIL\PAW-NEBB\98171\PAW\98171E3.DWG Thu Jul 13 14:45:07 2000