

FHWA REG NO.	STATE	PROJECT NO.	YEAR	SHEET NO	TOTAL SHEETS
7	KANSAS	STP-N012(901)	1999	6	131

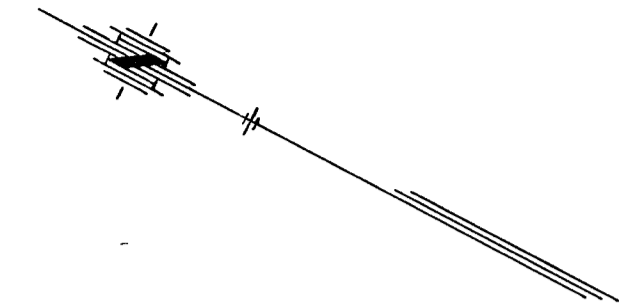

DATE	
BY	
REFERENCES NOTED	
REFERENCES CHECKED	

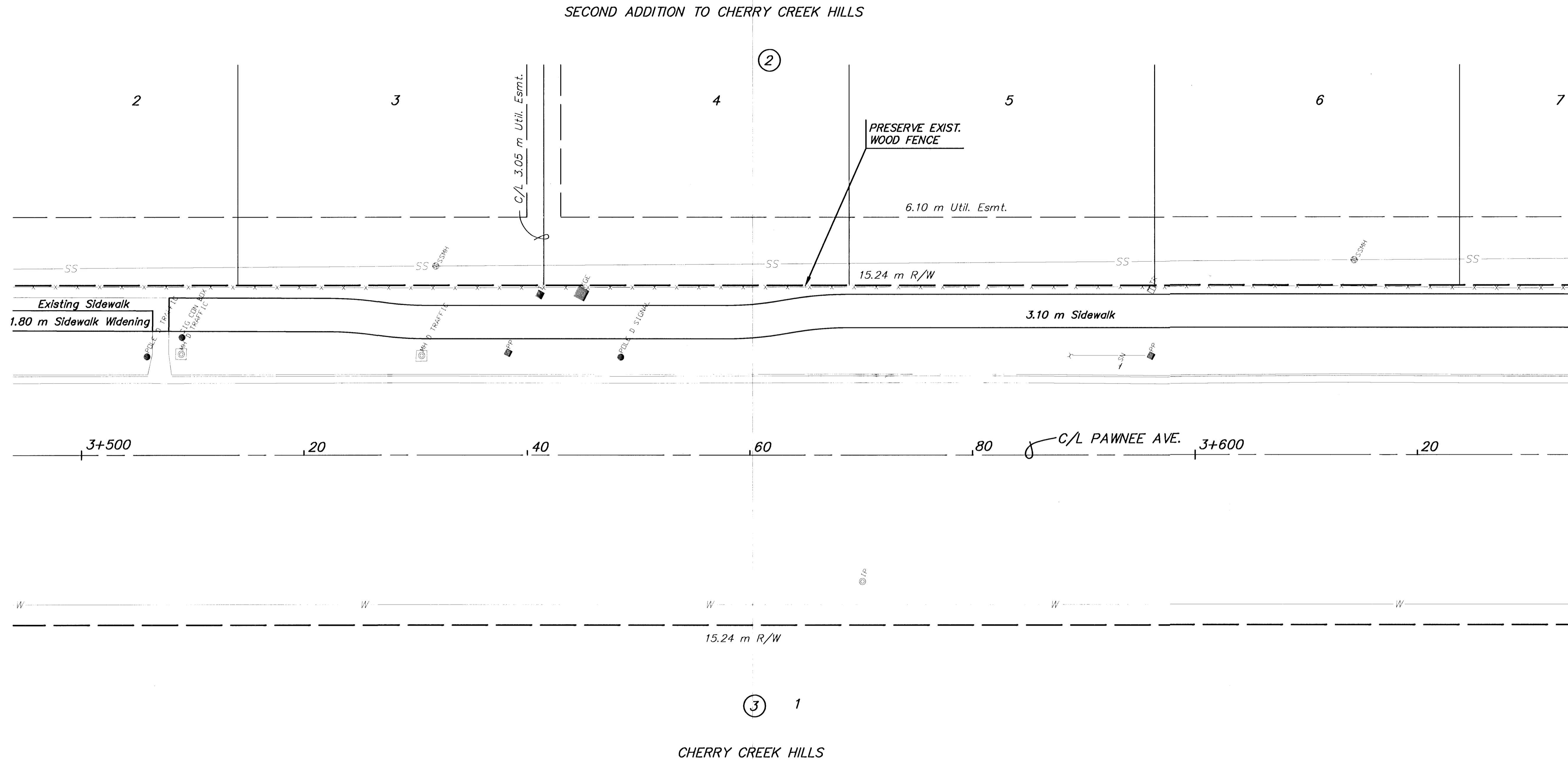

Legend

Pavement, Median, Driveway and/or Sidewalk Removal

UTILITY OWNERS

- TV - Cox Communications (316)262-4270
- P1 - 12" Williams Natural Gas 1-800-324-9696
- P2 - 20" Williams Natural Gas 1-800-324-9696
- P3 - 4" Raytheon Aircraft (316)676-6867
- P4 - 4" Raytheon Aircraft (316)676-6867
- P5 - 18" Williams Natural Gas 1-800-324-9696
- P6 - 6" Conoco Pipe Line Co. 1-800-231-2551
- G - 6" Kansas Gas Service (316)832-3168
- E - KGE (316)261-6944
- SS - City of Wichita Water & Sewer Dept. (316)262-6000
- SWS - City of Wichita Water & Sewer Dept. (316)262-6000
- T - Southwestern Bell Telephone Co. 1-800-734-7590
- W - 16" City of Wichita Water & Sewer Dept. (316)262-6000

2				
1				
NO.	DATE	REVISIONS	BY	APP'D
KANSAS DEPARTMENT OF TRANSPORTATION				
PAWNEE AVE.				
STA. 3+500 TO STA. 3+620				
PROJ. NO. 87 STP-N-0129-01				
MKEC ENGINEERING CONSULTANTS, INC.				
WICHITA, KANSAS				
DESIGNED BY:	JTC	CHECKED BY:	GJA	
DRAWN BY:	GJR,MLW	DATE:	JUNE 1999	SHEET 6 OF 131

G:\CIVIL\PAW-KEBB\98171\PAW\98171E4.DWG Thu Jul 13 14:52:52 2000

G:\CIVIL\PAW-WEBB\98171\PAW\98171E4.DWG