

**ADJUST VALVE BOX, FIRE HYDRANT & WTR. METER**

STATION	OFFSET (m)	DESCRIPTION	EXIST. ELEV.	PROP. ELEV.	REMARKS
4+83	15.4 m LT.	FH	62.22	62.22	

FHWA REG. NO.	STATE	PROJECT NO.	YEAR	SHEET NO.	TOTAL SHEETS
7	KANSAS	STP-N012(901)	1999	32	131

REFERENCES NOTED	DATE

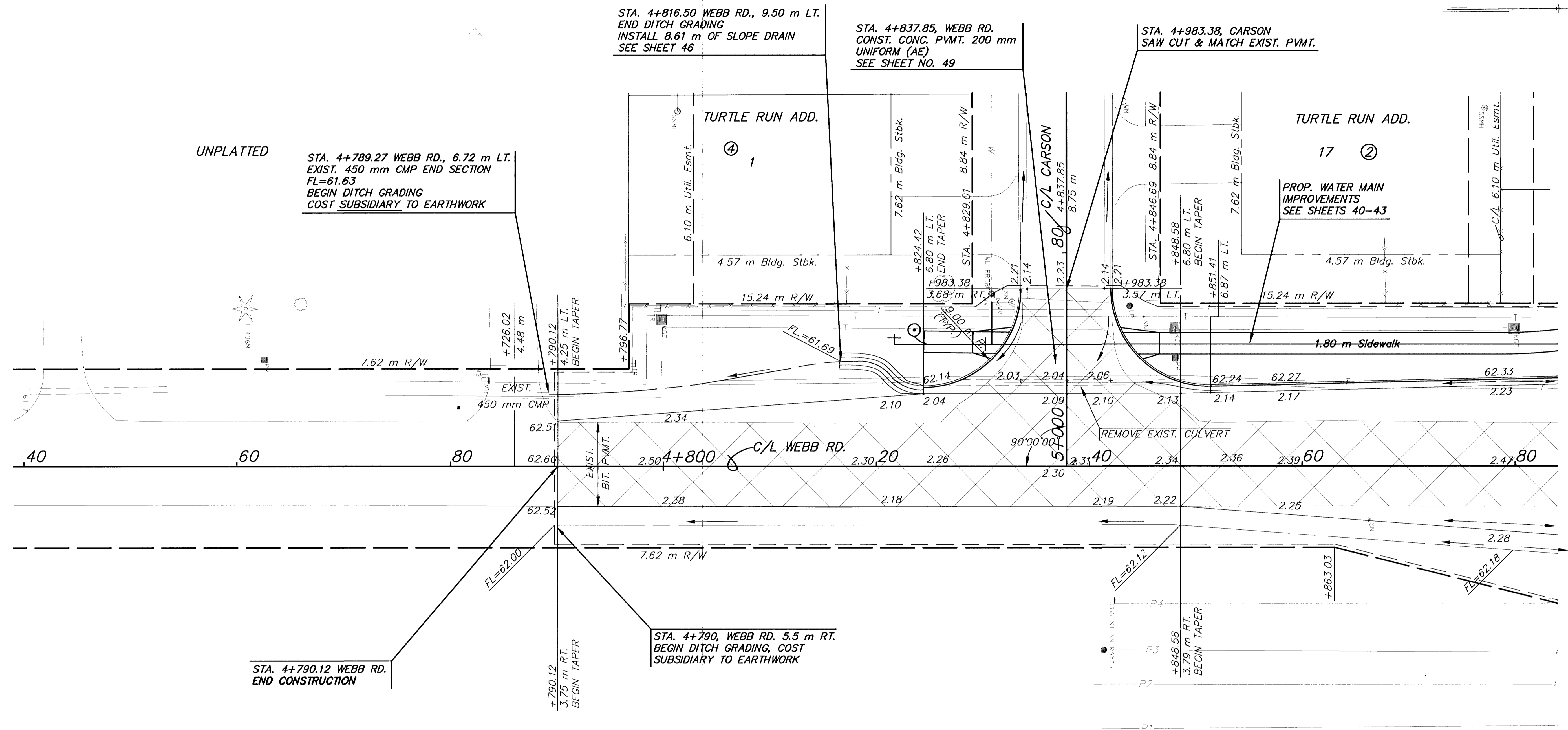

BM #15 Square Cut on TC @ SE cor. of 1st drive W. of Webb Rd. on N. side of Carson St. @ house #9518. Sta. 4+842.14 Elev.=62.158

- UTILITY OWNERS**
- TV - Cox Communications (316)262-4270
  - P1 - 12" Williams Natural Gas 1-800-324-9696
  - P2 - 20" Williams Natural Gas 1-800-324-9696
  - P3 - 4" Raytheon Aircraft (316)676-6867
  - P4 - 4" Raytheon Aircraft (316)676-6867
  - P5 - 18" Williams Natural Gas 1-800-324-9696
  - P6 - 6" Conoco Pipe Line Co. 1-800-231-2551
  - G - 6" Kansas Gas Service (316)832-3168
  - E - KGE (316)261-6944
  - SS - City of Wichita Water & Sewer Dept. (316)262-6000
  - SWS - City of Wichita Water & Sewer Dept. (316)262-6000
  - T - Southwestern Bell Telephone Co. 1-800-734-7590
  - W - 16" City of Wichita Water & Sewer Dept. (316)262-6000

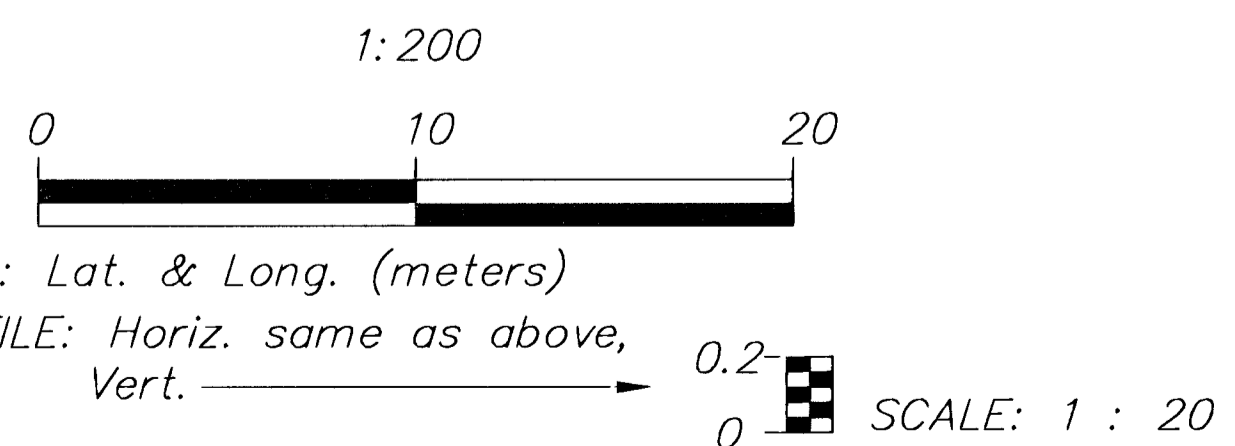

**Legend**

Pavement, Median, Driveway and/or Sidewalk Removal

2				
1				
NO.	DATE	REVISIONS	BY	APP'D

KANSAS DEPARTMENT OF TRANSPORTATION

**WEBB RD.**  
**STA. 4+740 TO STA. 4+880**  
 PROJ. NO. STP-N012(901)

**MKEC ENGINEERING CONSULTANTS, INC.**  
 WICHITA, KANSAS

DESIGNED BY: JTC	CHECKED BY: GJA
DRAWN BY: GJR,MLW	DATE: JUNE 1999 SHEET 32 OF 131

6: CIVIL\PAW-WEBB\98171\PAW\98171E18.DWG Mon Sep 18 10:34:16 2000