

DATE	
BY	
REFERENCES NOTED	
REFERENCES CHECKED	

STA. 5+060.00 WEBB RD. CONSTRUCT CURB INLET (TYPE 1A) 10.52 m LT. L=1.93 m, W=1.63 m INLET TOP=61.91 INSTALL 750 mm x 68.98 m STORM SWR. (RCP)(S) SEE SHEET NO. 51 & 57

STA. 5+151.15 WEBB RD, MATCH LINE END CONSTRUCTION NO. STP-N012(901) PAWNEE AVE., FROM ROCK RD. TO WEBB BEGIN PROJ. NO. STP-N012(601) WEBB RD., FROM PAWNEE AVE. TO HARRY

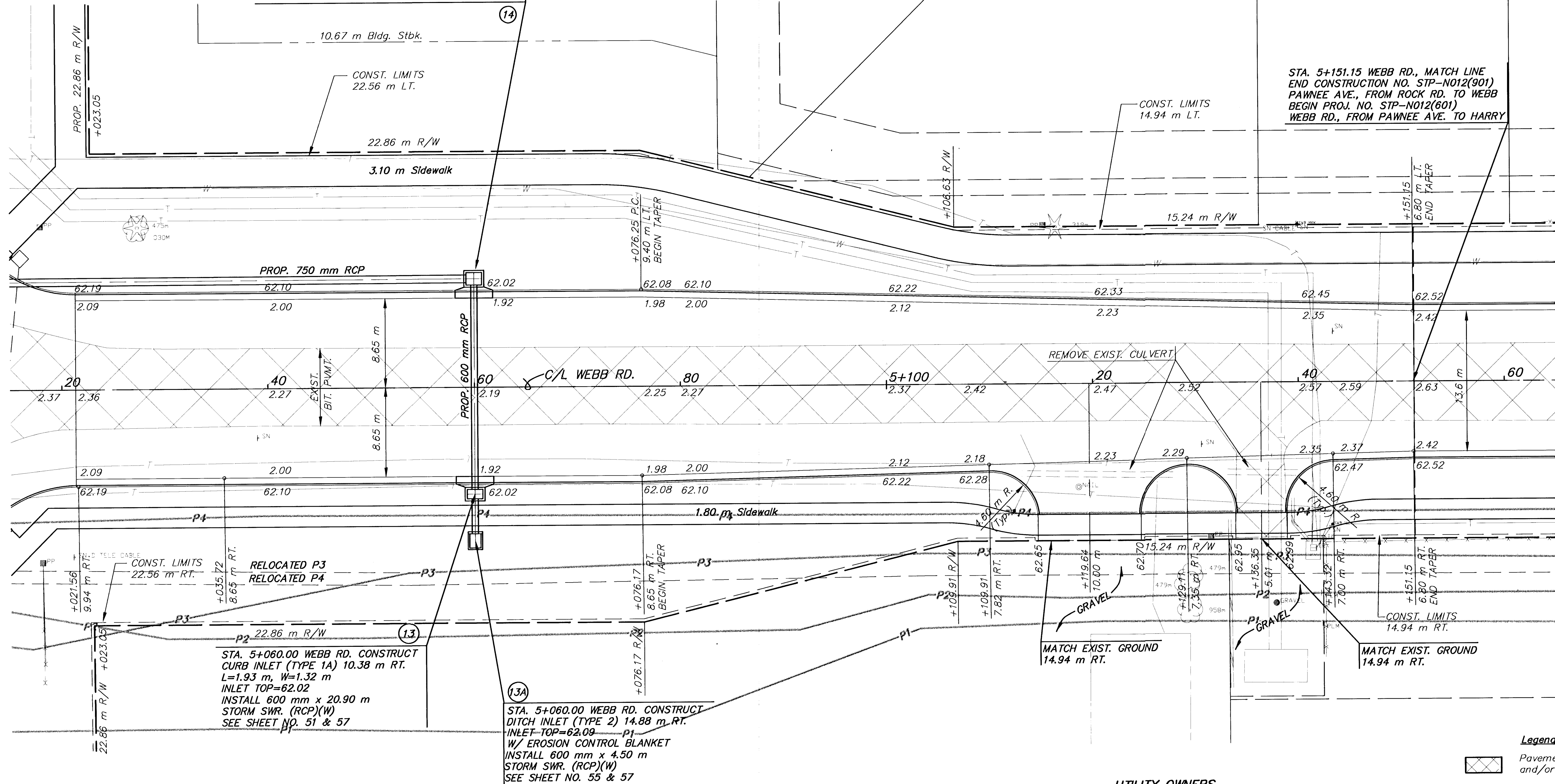

STA. 5+060.00 WEBB RD. CONSTRUCT CURB INLET (TYPE 1A) 10.38 m RT. L=1.93 m, W=1.32 m INLET TOP=62.02 INSTALL 600 mm x 20.90 m STORM SWR. (RCP)(W) SEE SHEET NO. 51 & 57

STA. 5+060.00 WEBB RD. CONSTRUCT DITCH INLET (TYPE 2) 14.88 m RT. INLET TOP=62.09 W/ EROSION CONTROL BLANKET INSTALL 600 mm x 4.50 m STORM SWR. (RCP)(W) SEE SHEET NO. 55 & 57

Legend
 Pavement, Median, Driveway and/or Sidewalk Removal

- UTILITY OWNERS**
- TV - Cox Communications (316)262-4270
 - P1 - 12" Williams Natural Gas 1-800-324-9696
 - P2 - 20" Williams Natural Gas 1-800-324-9696
 - P3 - 4" Raytheon Aircraft (316)676-6867
 - P4 - 4" Raytheon Aircraft (316)676-6867
 - P5 - 18" Williams Natural Gas 1-800-324-9696
 - P6 - 6" Conoco Pipe Line Co. 1-800-231-2551
 - G - 6" Kansas Gas Service (316)832-3168
 - E - KGE (316)261-6944
 - SS - City of Wichita Water & Sewer Dept. (316)262-6000
 - SWS - City of Wichita Water & Sewer Dept. (316)262-6000
 - T - Southwestern Bell Telephone Co. 1-800-734-7590
 - W - 16" City of Wichita Water & Sewer Dept. (316)262-6000

NO.	DATE	REVISIONS	BY	APP'D

KANSAS DEPARTMENT OF TRANSPORTATION

WEBB RD.
STA. 5+020 TO STA. 5+160

PROJ. NO. 87 STP-N-0129-01

MKEC ENGINEERING CONSULTANTS, INC.
WICHITA, KANSAS

DESIGNED BY: JTC	CHECKED BY: GJA
DRAWN BY: GJRM/LW	DATE: JUNE 1999

SHEET 36 OF 131

C:\V\1\1\PAW-WEBB\98171\PAW\98171E20.DWG

6: V:\1\1\PAW-WEBB\98171\PAW\98171E20.DWG Thu Jun 27 09:39:27 2000