

FHWA REG. NO.	STATE	PROJECT NO.	YEAR	SHEET NO.	TOTAL SHEETS
7	KANSAS	STP-N012(901)	1999	42	131

Added Waterline Correction
@ Sta. 4+723.57, 14.0'm Rt
(to accommodate SWS Revision)

PAWNEE BL STA. 4+974.4, RT. 7.62m
REMOVE EXIST. FIRE HYDT.
BRANCH & VALVE. ROTATE HYDT.
TEE 180° TO THE SOUTH &
REINSTALL VALVE & FIRE HYDT.
USING 150mm MJ ANCHOR COUPLINGS,
SET TO GRADE & BLOCK

H#B225
V#27084

STA. 0+007.001, MAIN 4=
WEBB BL STA. 4+991.77, LT. 19.81m
TO
STA. 0+007.92, MAIN 4=
WEBB BL STA. 4+992.68, LT. 19.81m
1.29m OF 500mm DICL PIPE
2-500mm CIMJ 45° BENDS

STA. 0+009.45, MAIN 4=
WEBB BL STA. 4+994.21, LT. 19.81m
1.52m OF 500mm DICL PIPE
1-500mm SLEEVE

STA. 0+003.04, MAIN 4=
EBB BL STA. 4+987.81, LT. 19.81m
TO
STA. 0+003.96, MAIN 4=
WEBB BL STA. 4+988.72, LT. 19.81m
1.29m OF 500mm DICL PIPE
2-500mm CIMJ 45° BENDS

3.05m OF 500mm DICL PIPE

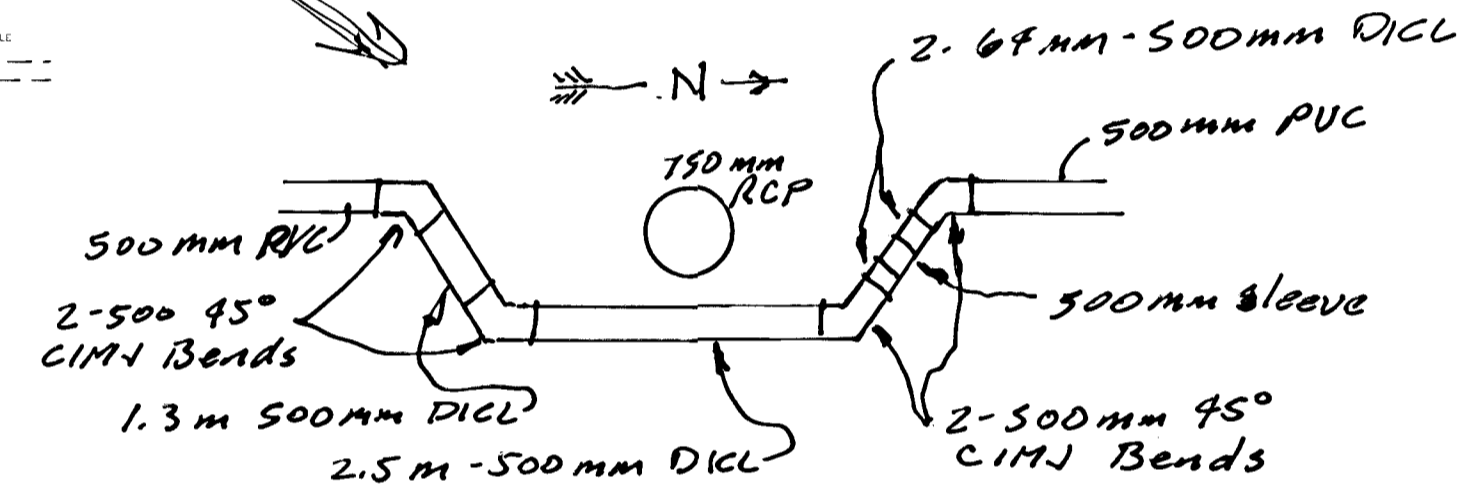
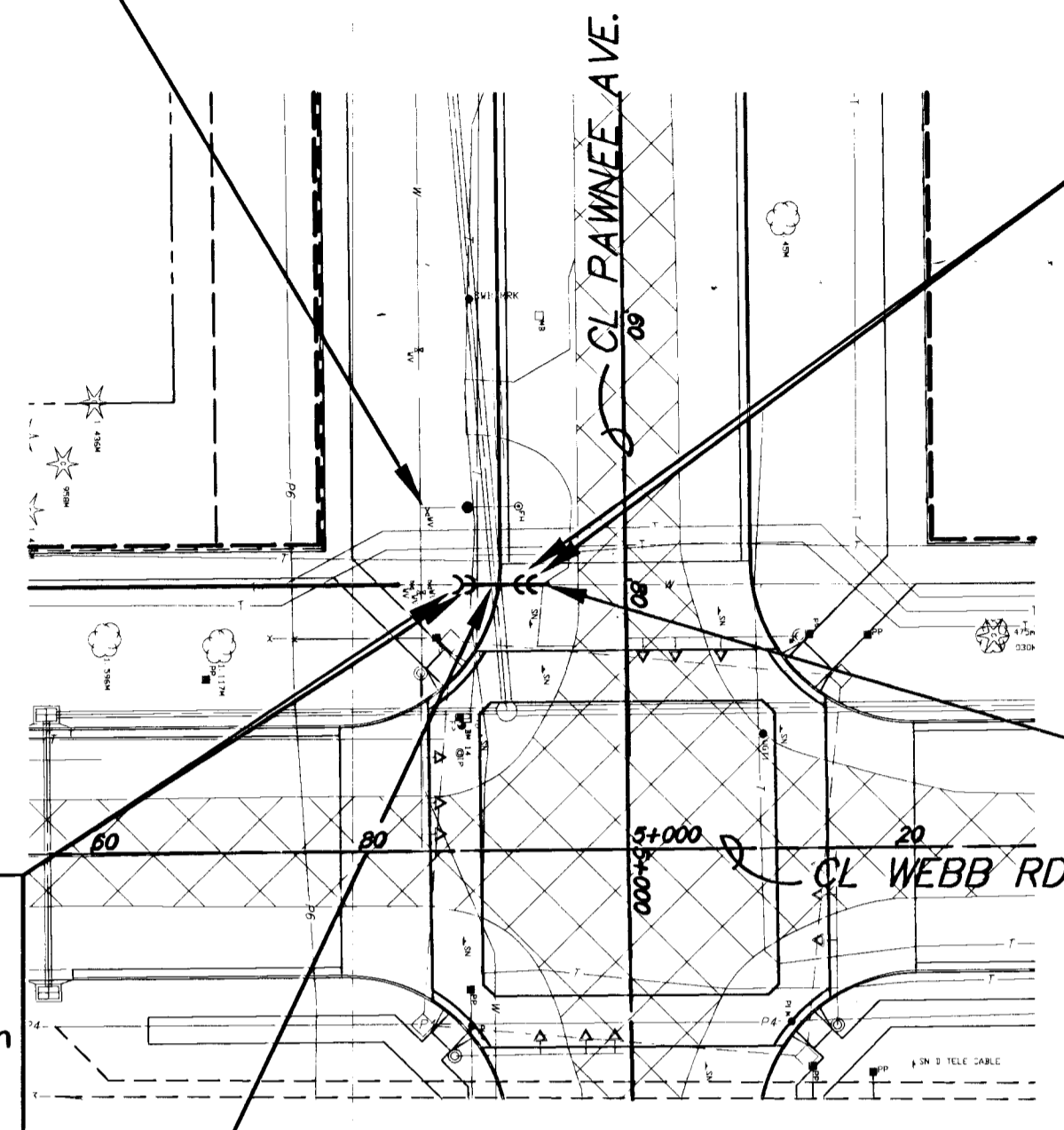
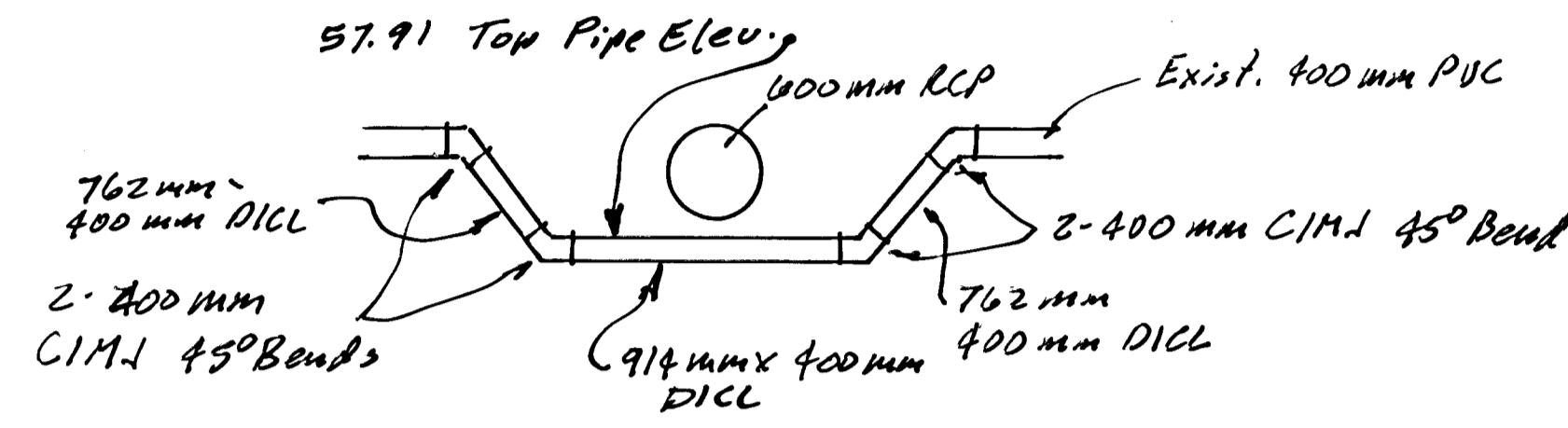

PLAN - MAIN 4
SCALE: 1 : 500

PROFILE - MAIN 4
HORIZONTAL SCALE: 1 : 500
VERTICAL SCALE: 1 : 50

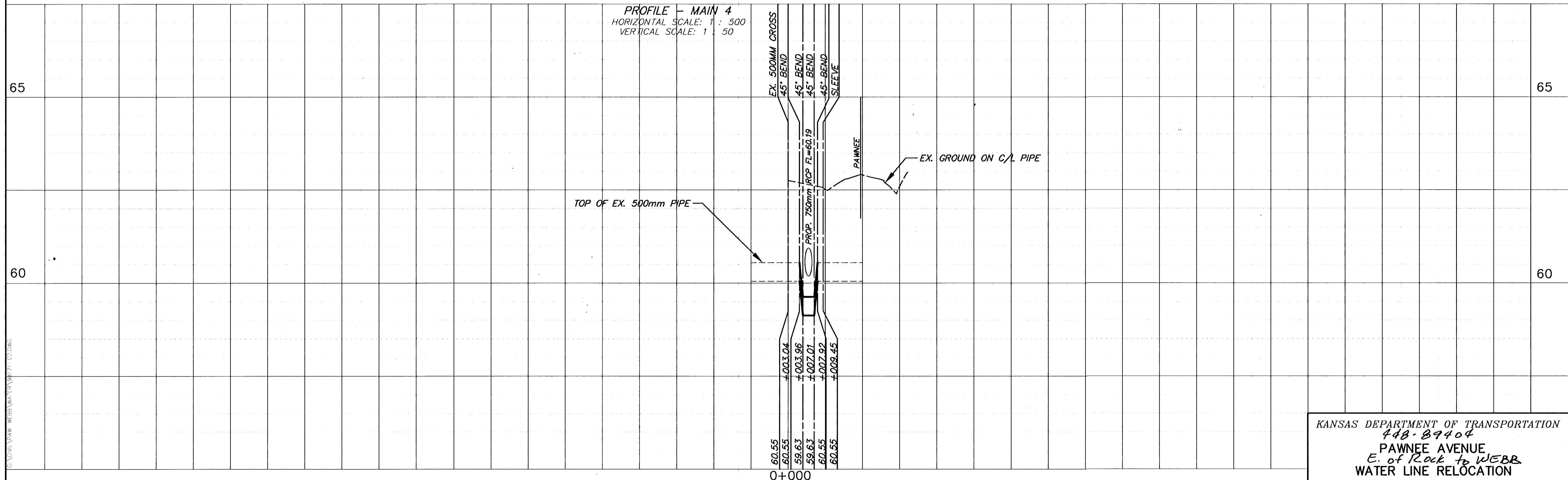

KANSAS DEPARTMENT OF TRANSPORTATION
448-89404
PAWNEE AVENUE
E. of Rock to WEBB
WATER LINE RELOCATION

6:ACTIVL\PAW-WEBB\WATER\99171-C2.DWG Thu Sep 14 10:05:50 2000

CA:\001\PAW-WEBB\WATER\99171-C2.DWG