

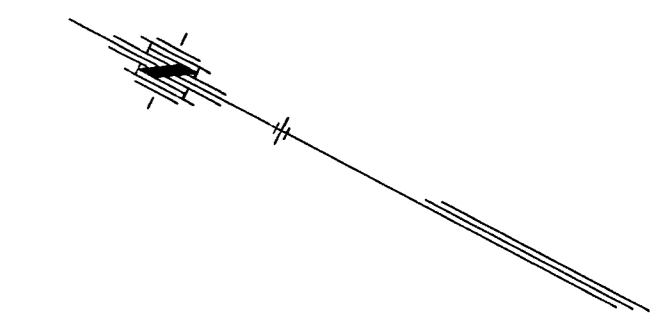

FHWA REG NO.	STATE	PROJECT NO.	YEAR	SHEET NO	TOTAL SHEETS
7	KANSAS	STP-N012(901)	1999	74	131

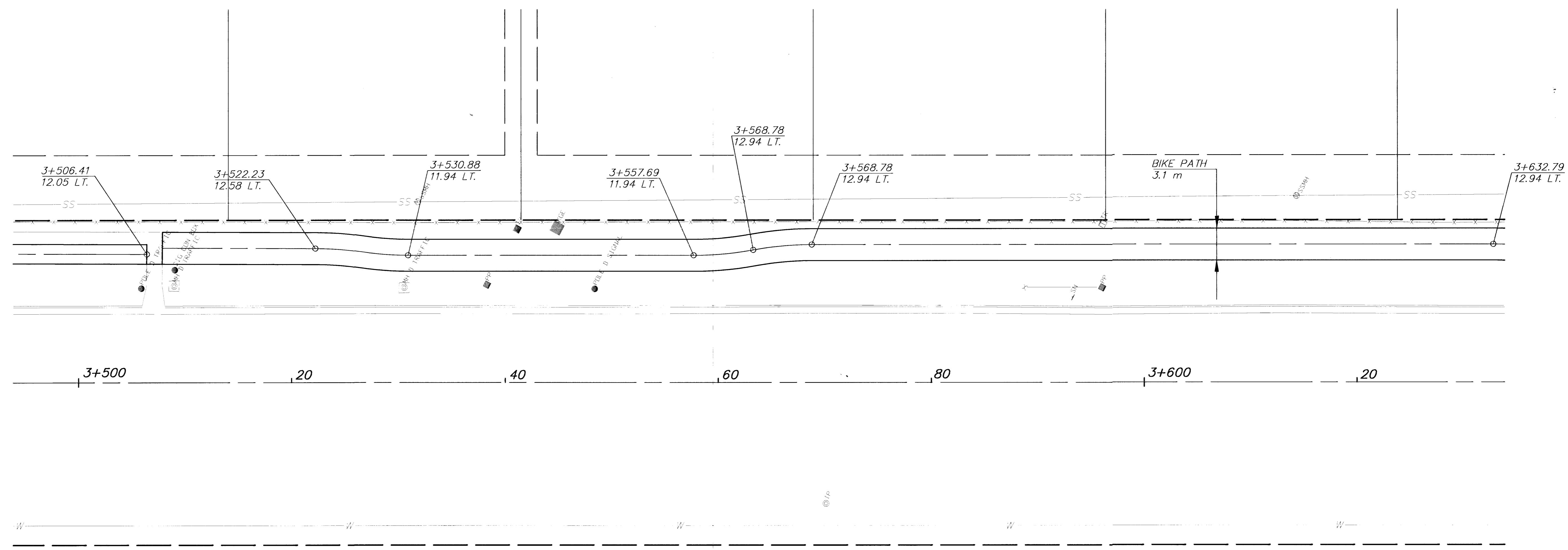

REFERENCES NOTED	BY	DATE
REFERENCES CHECKED		



 Pavement, Median, Driveway and/or Sidewalk Removal

2				
1				
NO.	DATE	REVISIONS	BY	APP'D
KANSAS DEPARTMENT OF TRANSPORTATION ROAD SIDE IMPROVEMENTS PAWNEE AVE. STA. 3+500 TO STA. 3+620 PROJ. NO. 87 STP-N-0129-01 SEDGWICK COUNTY				
MID-KANSAS ENGINEERING CONSULTANTS, INC. WICHITA, KANSAS				
DESIGNED BY:	JTC	CHECKED BY:	GJA	
DRAWN BY:	GJR,MLW	DATE:	JUNE 1999	SHEET 74 OF 131

G:\CIVIL\PAW-NEBB\98171\ROADSIDE\14.DWG

6: \CIVIL\PAW-NEBB\98171\ROADSIDE\14.DWG FRI, JUN 14 15: 18: 28 2000