

STATE	PROJECT NO.	YEAR	SHEET NO.	TOTAL SHEETS
KANSAS	87 N-0616-01	2017	1	166
F.A. NO. CMQ-N061(601)				

KDOT PROJ. NO. 87 N-0616-01

GRADING
SURFACING
CONCRETE PAVEMENT
PAVEMENT MARKING
SIGNING
TRAFFIC SIGNALIZATION
SEEDING

STATE OF KANSAS
DEPARTMENT OF TRANSPORTATION
PLAN AND PROFILE OF PROPOSED
45TH STREET & HILLSIDE AVENUE
INTERSECTION IMPROVEMENTS

FEDERAL AID PROJECT
SEDGWICK COUNTY
CITY OF WICHITA
C.O.W. PROJ. NO. 472-85160
OCA NO. 707067
WATER LINE PROJ. NO. 448-90775
OCA NO. 636362

INDEX OF SHEETS

1	Title Sheet
2	General Notes
3	Coordinate Control Data
4 - 8	Hillside Avenue Typical Sections
9 - 13	45th Street Typical Sections
14 - 16	Hillside Avenue Plan & Profile Sheets
17 - 20	45th Street Plan & Profile Sheets
21 - 23	Intersection Details
24 - 32	Storm Sewer Plan & Profile Sheets
33	Schedule of Storm Sewer
34	Slope Protection Detail Sheet
35 - 39	Inlet Standards
40 - 42	Manhole Details
43 - 44	Drainage Details
45 - 55	Jointing Layout Sheets
56 - 57	Driveway Details
58 - 60	Curb & Gutter, Concrete Barrier, and Median Details
61 - 62	Concrete Pavement Details
63 - 66	Erosion Control Details
67	Summary of Quantities
68 - 83	Construction Phasing
84 - 92	Traffic Control Standards
93 - 99	Pavement Marking and Signing Plans
100 - 102	Pavement Marking Standards
103 - 106	Traffic Signal Plans 45th Street & Hillside Avenue
107 - 112	Traffic Signal Details
113 - 116	Water System Details
117	Water System Plan & Profile Sheet
118 - 144	Hillside Avenue Cross Sections
145 - 166	45th Street Cross Sections

DATE	BY	SURVEY	CADD TECHNICIAN	DESIGNERS	SQUAD

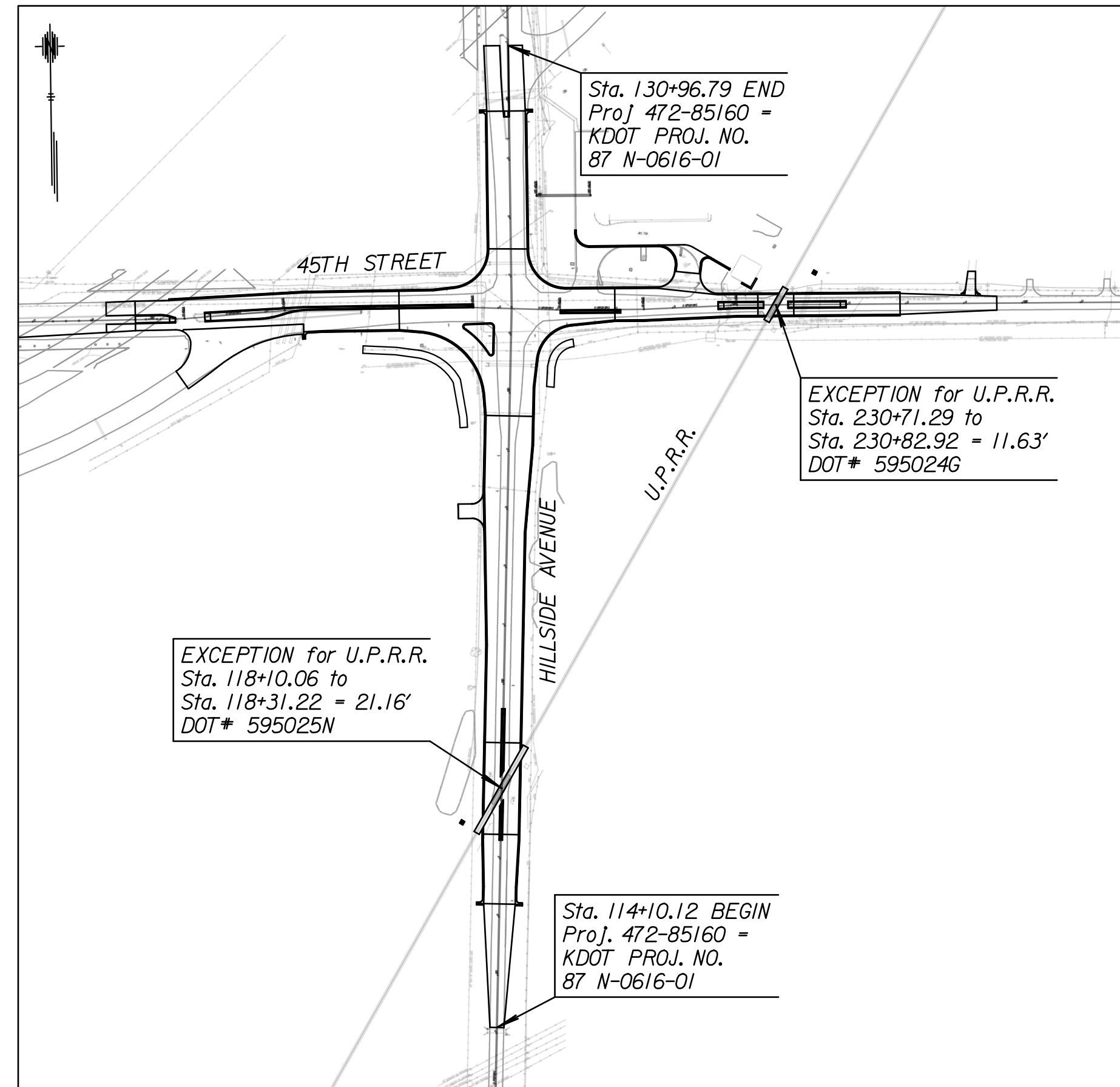
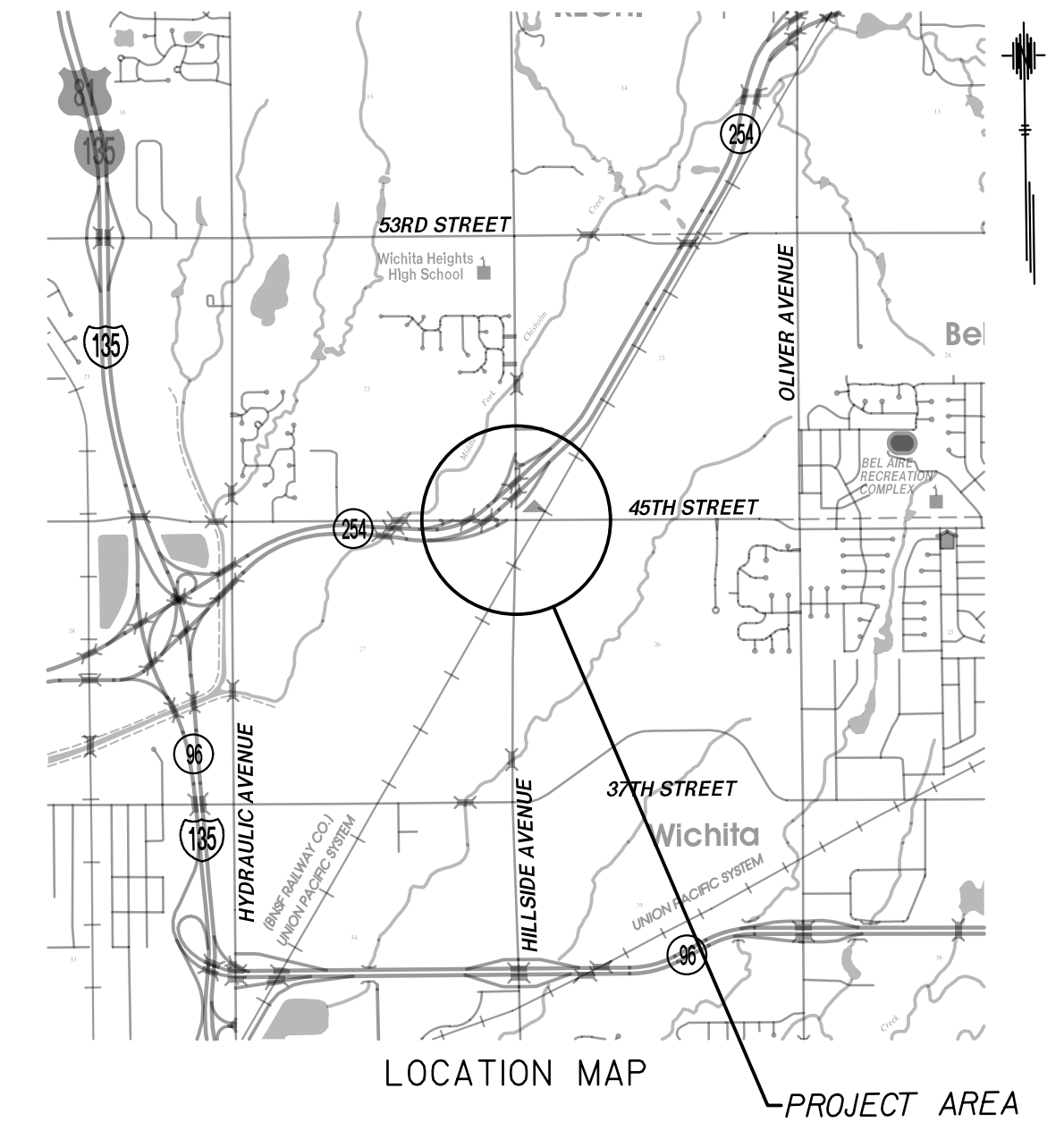

DESIGN DESIGNATION

AADT (45th- 2015) = 7,300
 AADT (45th- 2045) = 16,900
 DHV = 13%
 D = 5% (WB)
 T = 2%
 V = 40 M.P.H.
 C of A = NONE
 LATERAL OFFSET = 6.0 FT.

CONVENTIONAL SIGNS

COUNTY LINE	=====	CENTER LINE OF PROJECT	----- 50 -----
CITY LIMITS	//////	TERRACE	-----
STATE OR NATIONAL LINE	=====	CULVERTS	-----
TOWNSHIP, SECTION or GRANT LINE	-----	DROP INLET & STORM SEWER	-----
PROPERTY LINE	-----	ACCESS CONTROL	-----
HIGHWAY FENCE	-----	POWER POLE	-----
EXISTING FENCE	-----	TELEPHONE POLE	-----
GUARDRAIL	-----	MARSH	-----
CONSTRUCTION LIMITS	-----	HEDGE	-----
RIGHT OF WAY LINE	-----	TREES	-----
TRAVELED WAY	-----	PROFILE ELEVATION	-----
RAILROADS	-----	STREAM or CREEK	-----

GROSS LENGTH OF PROJECT 1,686.67 FT.
 EXCEPTIONS 21.16 FT.

NET LENGTH OF PROJECT 1,665.51 FT. 0.32 MILES
 NET LENGTH OF BRIDGES 0.00 FT. 0.00 MILES
 NET LENGTH OF ROAD 1,665.51 FT. 0.32 MILES



THE PROJECT LIMITS SHALL BE CLOSED TO THROUGH TRAFFIC AT ALL TIMES DURING CONSTRUCTION
 THROUGH TRAFFIC SHALL BE CARRIED THROUGH CONSTRUCTION ON DETOURS
 DETOURS SHALL BE SIGNED AND MAINTAINED BY THE CONTRACTOR



245 N. Waco, Suite 222
 Wichita, KS 67202
 Main: 316-303-3000
 Fax: 316-462-5629

RECOM. FOR APPROVAL-DATE

Gary Janzen 09/12/17
 Gary L. Janzen, P.E.
 City Engineer
 City of Wichita, KS