

FHWA REGION NO.	STATE	PROJECT NUMBER	FISCAL YEAR	SHEET NUMBER	TOTAL SHEETS
7	KANSAS	87N-0128-01		9	118

DATE	
BY	
REFERENCES NOTED	
REFERENCES CHECKED	

PARK BENCH TO BE REMOVED BY W.M.T.A. BEFORE CONSTRUCTION. W.M.T.A. TO RESET BENCH AFTER CONSTRUCTION.

CONSTRUCT FULL HEIGHT CURB AND GUTTER (150 mm) (TYPE I) ACROSS DRIVE OPENING. TRANSITION TO MATCH EXISTING CURB.

REMOVE SIDEWALK TO NEAREST JOINT (W) TO FACILITATE CONSTRUCTION OF WHEELCHAIR RAMP.

CONSTRUCT 1 800 SIDEWALK (AE) (100 mm). SEE TYPICAL SECTION SHEET 3

TRAFFIC SIGNAL BOX TO BE RELOCATED

BPED TO BE RELOCATED BY SWBT

TRAFFIC SIGNAL BOX TO BE RELOCATED

POWER POLE TO BE RELOCATED BY K.G.E.

CONSTRUCT FULL HEIGHT CURB AND GUTTER (150 mm) (TYPE I) ALONG BOTH SIDES

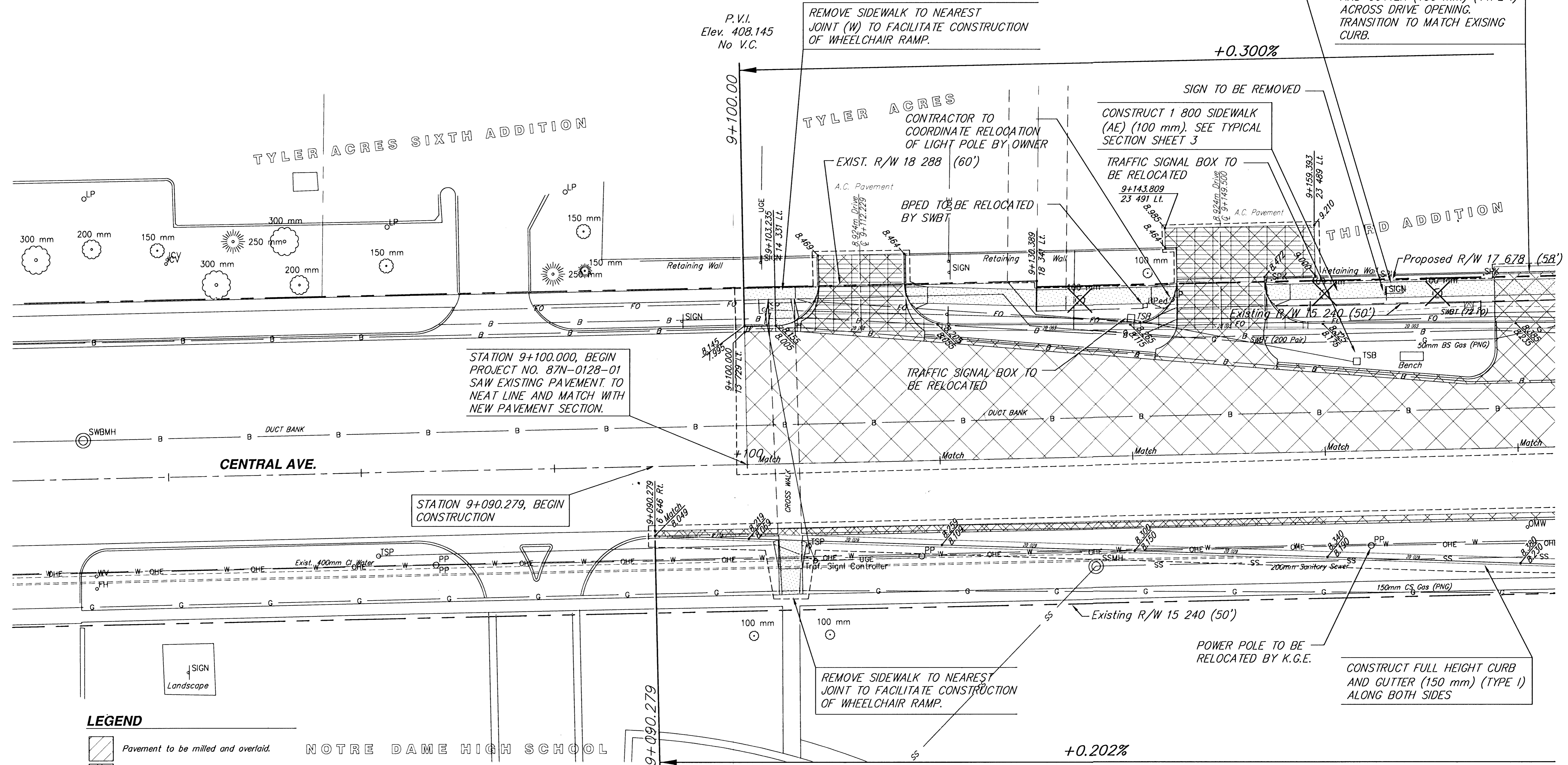

LEGEND

- Pavement to be milled and overlaid.
- Pavement to be overlaid.
- Pavement to be removed.
- Concrete Construction 200 mm
- Concrete Sidewalk Construction 100 mm
- Concrete Pavement (250 mm)(AE)(Plain)
- Crushed Stone Subgrade (150 mm) - Geogrid Reinforcement (for base)
- Concrete Pavement (200 mm)(AE)(Plain)
- Brick Paver Surfacing (60mm)
- 125mm Unrein. Concrete
- 150mm Reinf. Rock Base

CENTRAL AVE.			
STATION 9+025 TO STATION 9+175			
SRB		SAVOY, RUGGLES & BOHM, P.A.	
ENGINEERING & SURVEYING		PROJECT NUMBER	
472-76-245-83057-000-001		DATE	
Dec. 13, 2000		SRB JOB	
1218T		118	

