

| FHWA REGION NO. | STATE | PROJECT NUMBER | FISCAL YEAR | SHEET NUMBER | TOTAL SHEETS |
|-----------------|--------|----------------|-------------|--------------|--------------|
| 7 | KANSAS | 87N-0195-01 | 2001 | 20 | 127 |

| REFERENCES NOTED | DATE |
|------------------|------|
| | |
| | |
| | |
| | |

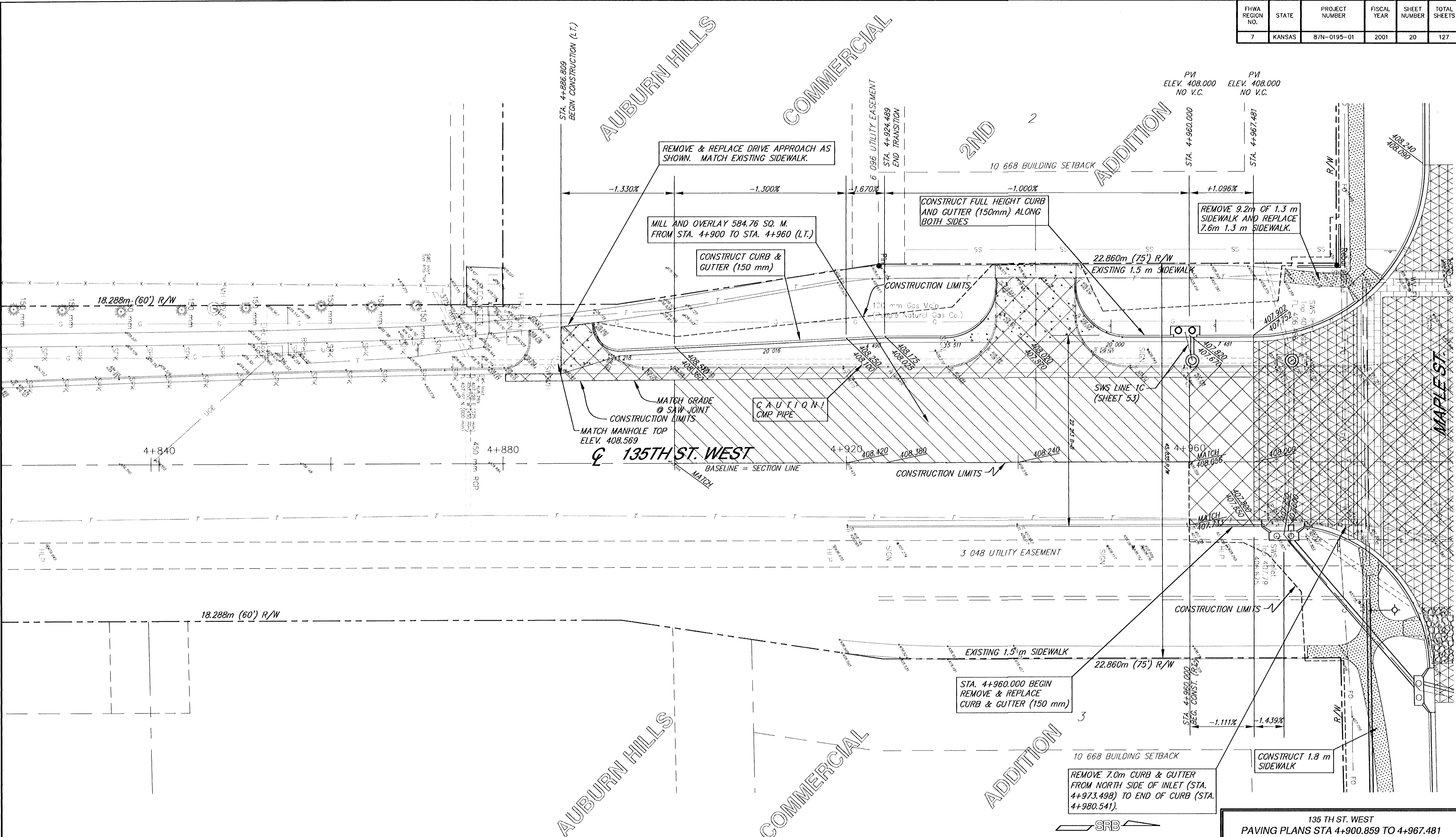

NOTE: SEE INTERSECTION SIGNAGE SHEET FOR RELOCATION OF EXISTING SIGNS SHEET 92

NOTE: SEE INTERSECTION DETAIL SHEET FOR WHEELCHAIR RAMP LAYOUT AND SIZE SHEET 22

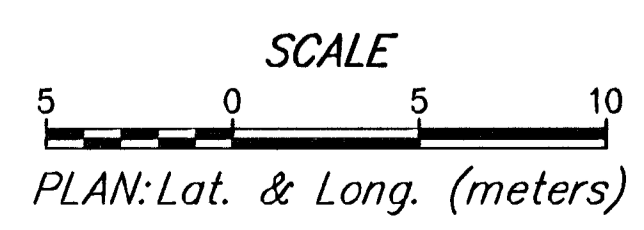

135 TH ST. WEST
PAVING PLANS STA 4+900.859 TO 4+967.481

| | | | |
|---|---------------|--|--|
| SRB | | 224 NORTH MAIN P.O. BOX 100 WICHITA, KANSAS 67203 www.srb.com | 318-284-8008 FAX: 284-1921 E-Mail: urb@srb.com |
| SAVOY, RUGGLES & BOHM, P.A. ENGINEERING & SURVEYING | | | |
| PROJECT NUMBER 472-76-245-83262-000-000-001 | | | |
| DRAWN JDS | DESIGN JDS | REVIEW JDS | DATE Sept. 27, 2001 |
| UTILITY | | DATE 12/17/01 | SCALE 12/17/01 |

20
127