

GENERAL NOTES

Special Concrete Bridge Approach shall be paid for as sq. m of Concrete Pavement (260 mm Unif.)(AE) and includes all work and materials required to construct the approach slab as shown on this sheet.

All work and materials required for installation of expansion joints shall be *subsidiary* to Concrete Pavement (260 mm Unif.)(AE).

Transition Approach Rail shall be paid as "Concrete Safety Barrier (Special)(AE)."

All preformed joint material shall be installed perpendicular to pavement surface. Formed joints shall be edged with 6 mm radius tool for length of joint.

At the Contractor's option #13 x900 mm tie bars @ 380 mm centers may be substituted for the #19 e bars at 750 mm centers.

Clearance from the face of concrete for all reinforcing steel shall be 50 mm.

Standard reinforcing bar hooks in accordance with the latest ACI specifications shall be used throughout.

W Expansion Joint. See Bridge Construction Layout Sheet for width, Standard Drawing RD662SI for details.

F Contractor has the option of substituting a Tied Keyed Construction Joint.

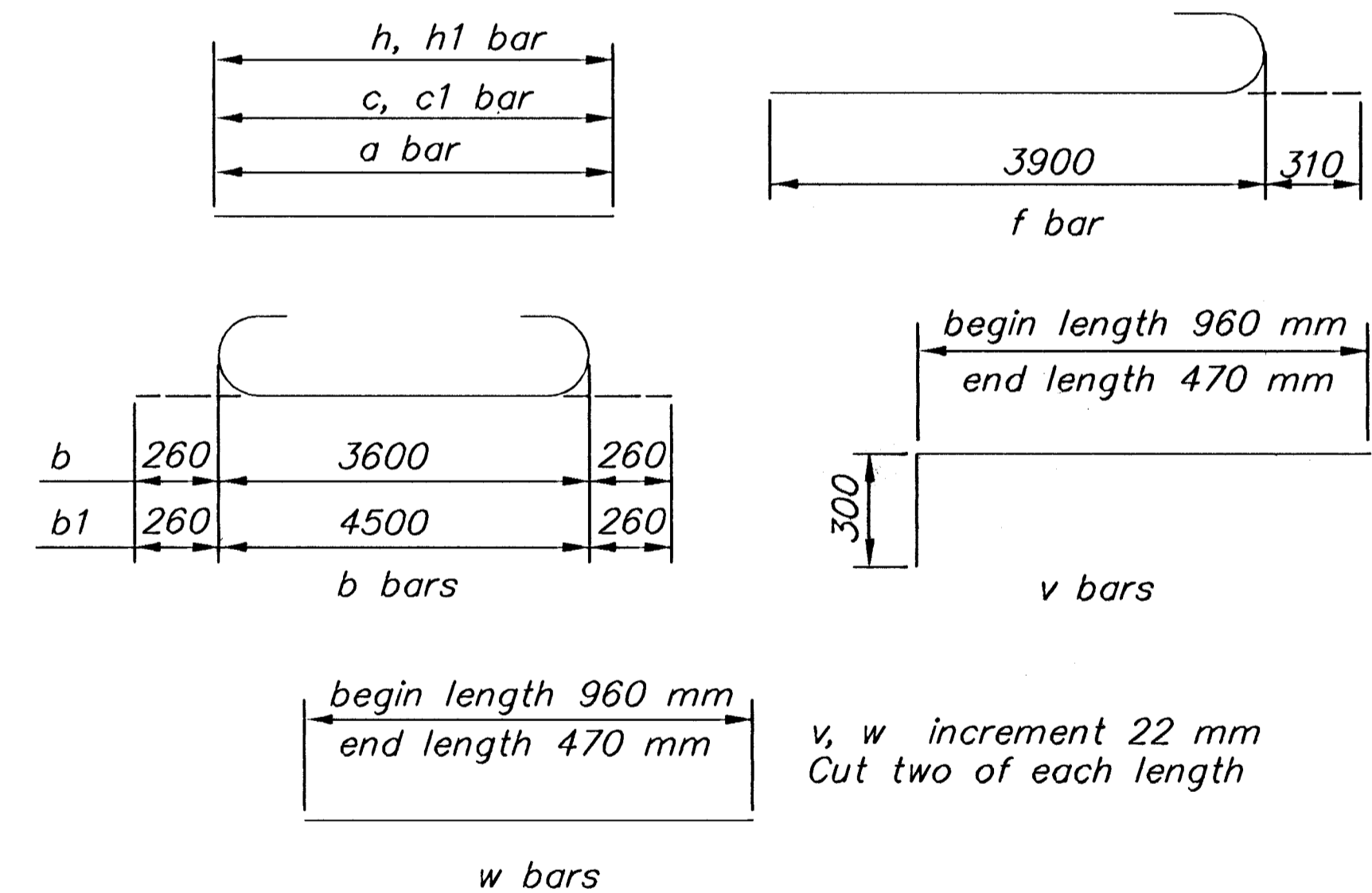
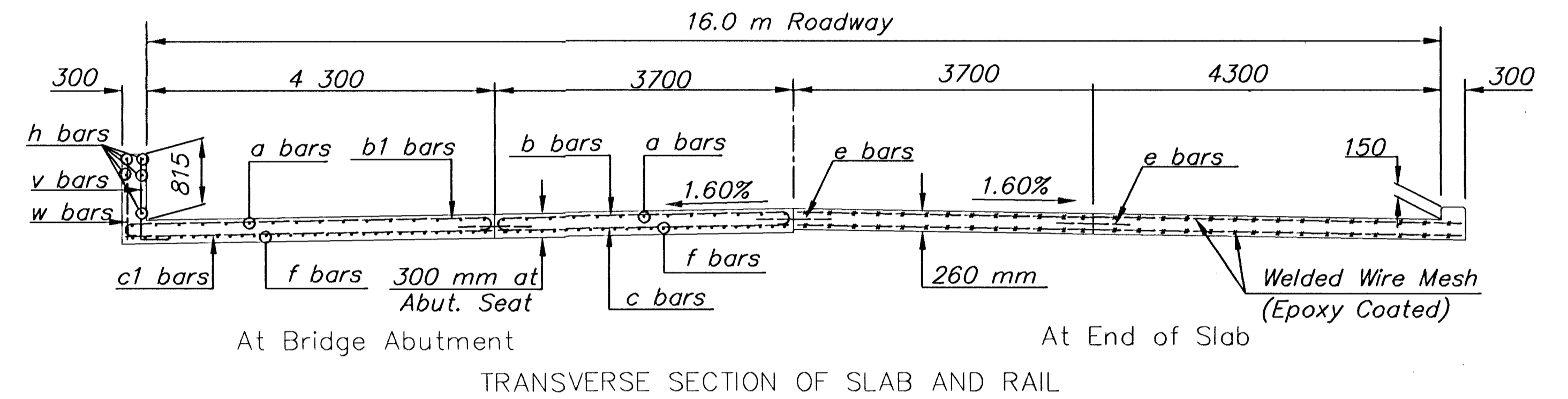
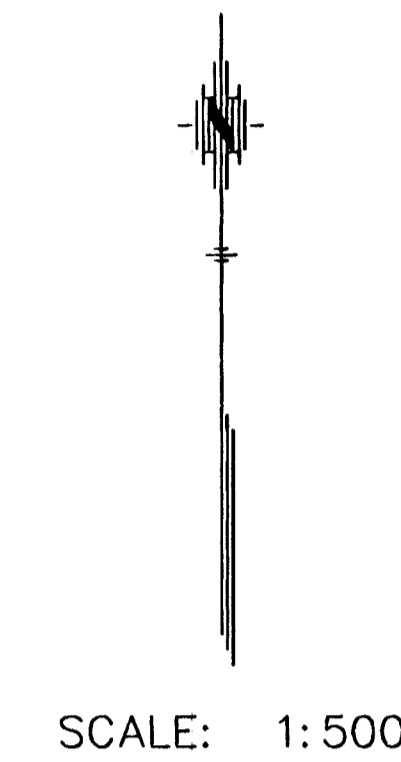
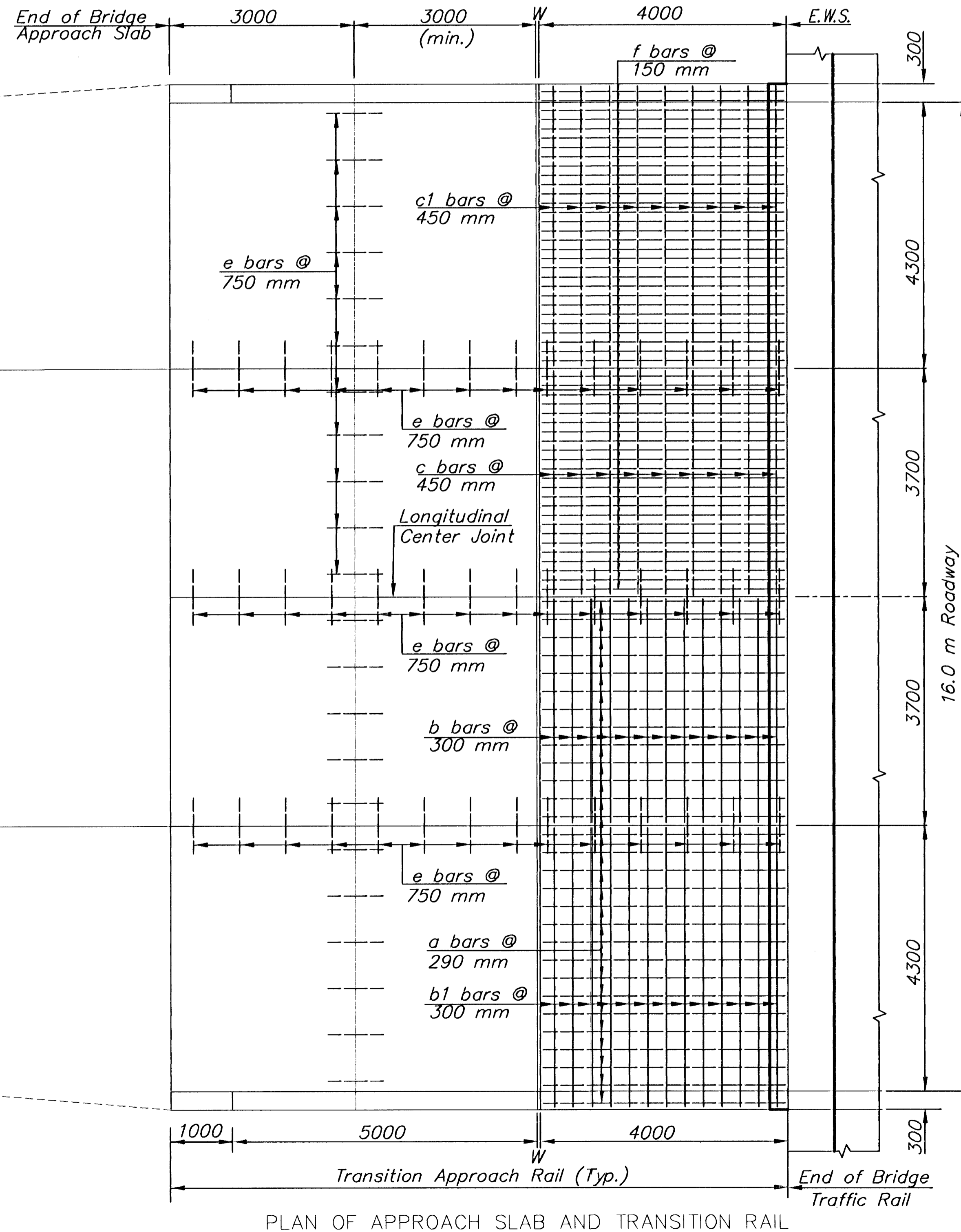
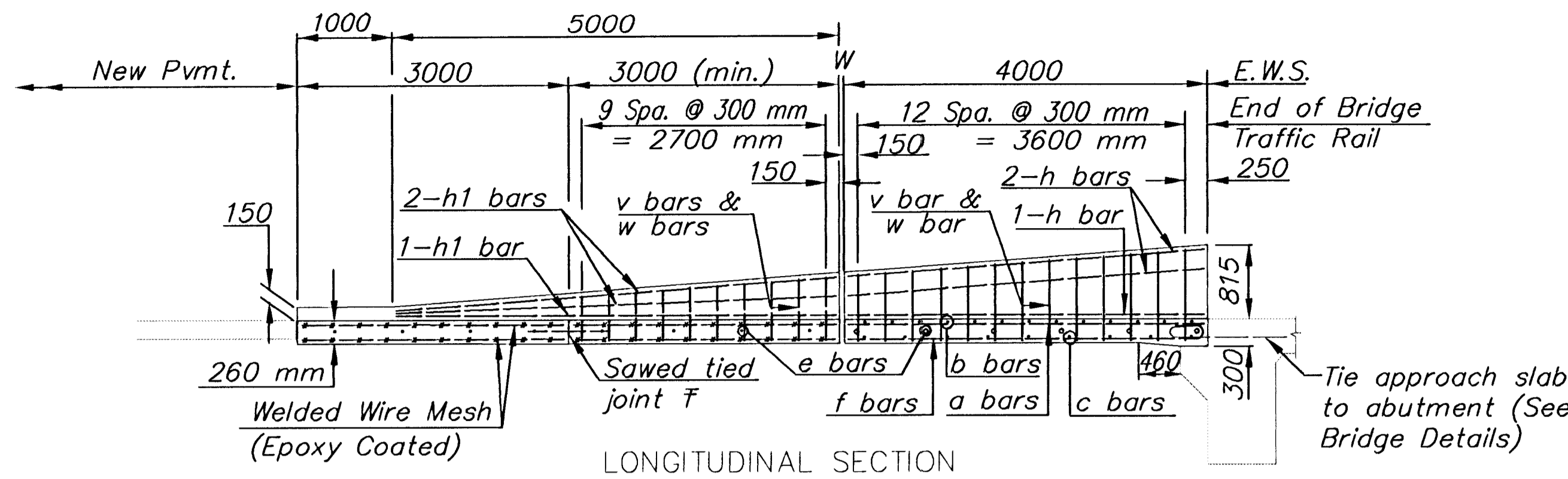

BILL OF MATERIALS (ONE APPROACH ONLY)								
Bar Schedule		△ See Bending Diagram						
Bar	a	b	b1	c	c1	e	f	
No.	58	28	28	18	18	64	108	
Size	16	16	16	16	16	19	19	
Length	3900	4120	5020	3600	4500	900	4210	
Bar	h	h1	v	w				
No.	10	10	46	46				
Size	16	16	13	13				
Length	3900	4900	△	△				
Reinforcing Steel							2350	kg
Concrete Pavement (260 mm Unif.)(AE)							166	m ²
Expansion Joint							16 600	mm
Concrete Safety Barrier (Special)(AE)							20	m

- NOTE:
- Quantities listed for one approach slab and rails only. Two required per bridge.
 - Reinforcing steel and joint lengths shown for information only.
 - Transition Approach Rail to be paid as m "Concrete Safety Barrier (Special)(AE)".

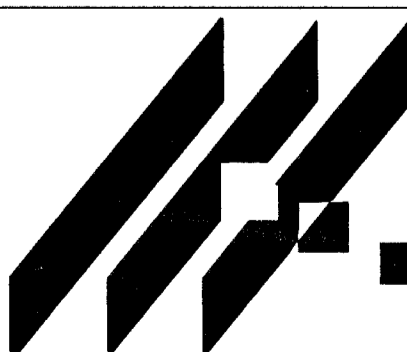

MID-KANSAS ENGINEERING CONSULTANTS, INC.
411 N WEBB ROAD
WICHITA, KS. 67206
316-684-9600

MAPLE STREET BRIDGE
(OVER NORTH FORK CALFSKIN CREEK)
PROJECT NAME

APPROACH SLAB & TRANSITION RAIL
SHEET TITLE

PAF DESIGN BY:	DPG DRAWN BY:	SDH CHECKED BY:
JUNE 1999 DATE	96099 JOB NO.	43 / 127 SHEET/OF