

**BENCHMARKS:**  
 Chiseled square at the end of the top of curb at the southeast corner of Ridge Port and 37th ST N.  
 Elev. = 1333.05 NAVD88

Chiseled square on the south side of curb inlet on the east side of Lakeway ST  
 Elev. = 1329.58 NAVD88

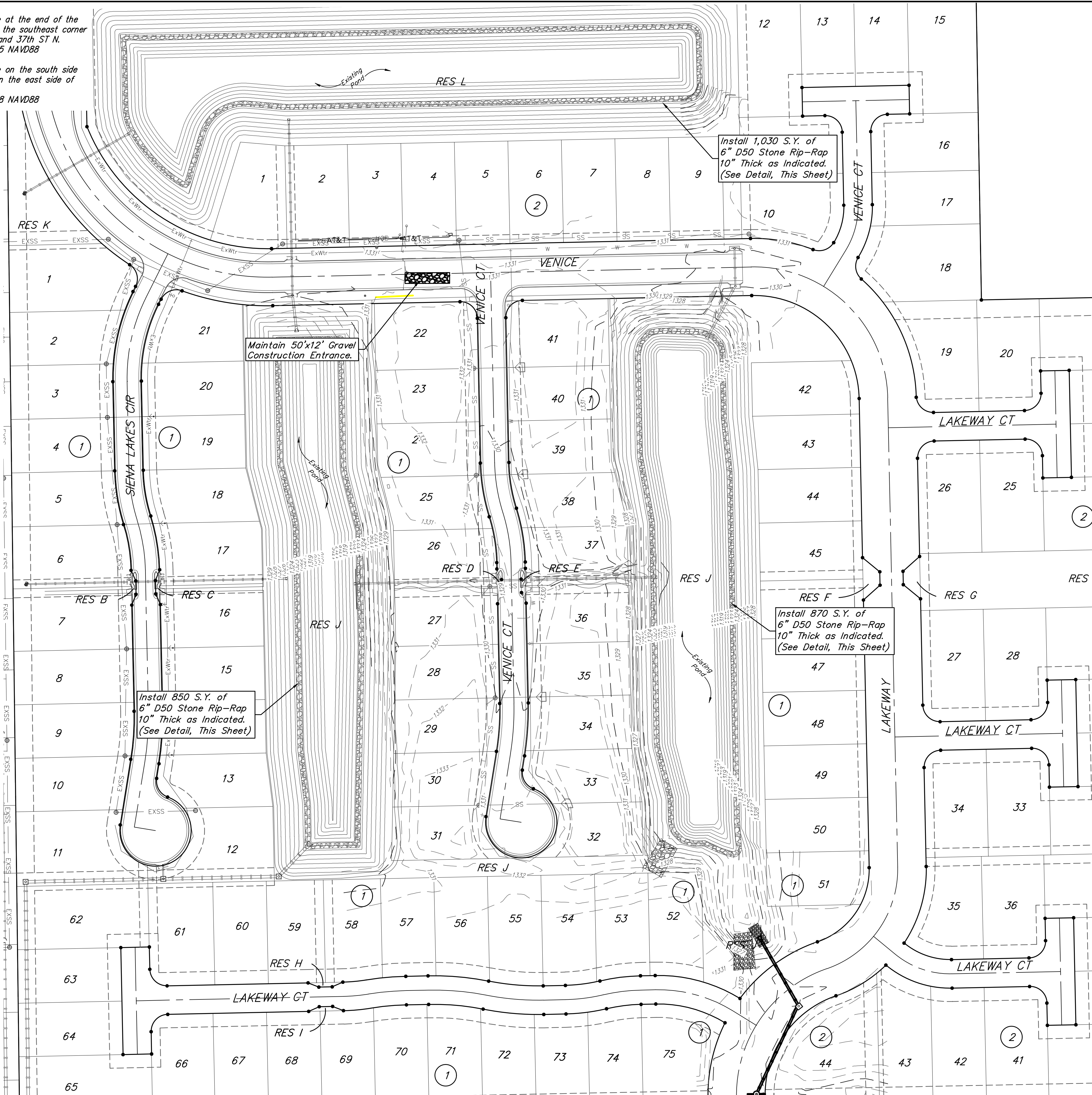
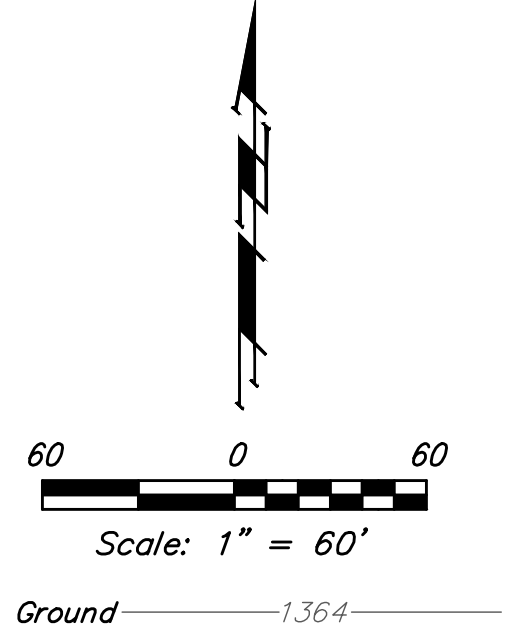

Install 1,030 S.Y. of 6" D50 Stone Rip-Rap 10" Thick as Indicated. (See Detail, This Sheet)

Maintain 50'x12' Gravel Construction Entrance.

Install 850 S.Y. of 6" D50 Stone Rip-Rap 10" Thick as Indicated. (See Detail, This Sheet)

Install 870 S.Y. of 6" D50 Stone Rip-Rap 10" Thick as Indicated. (See Detail, This Sheet)

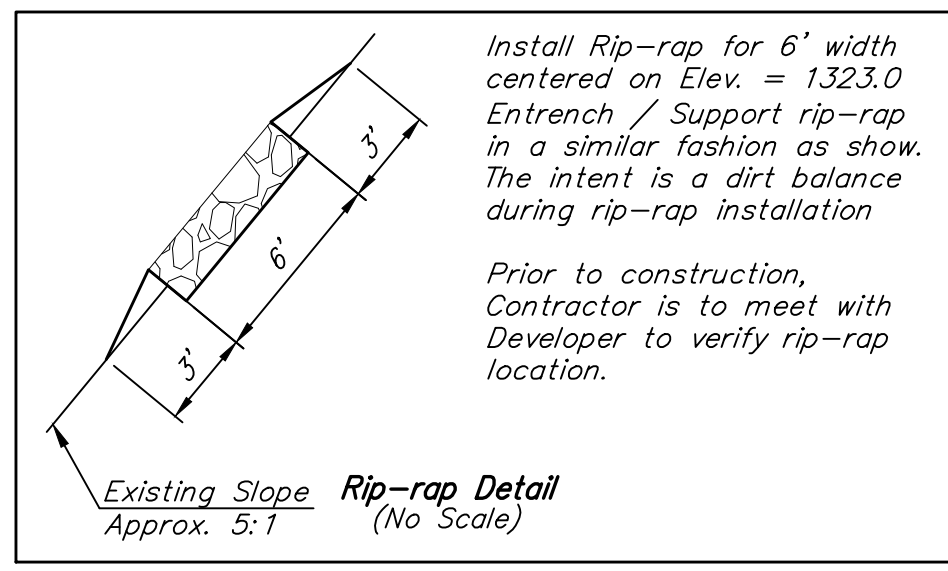
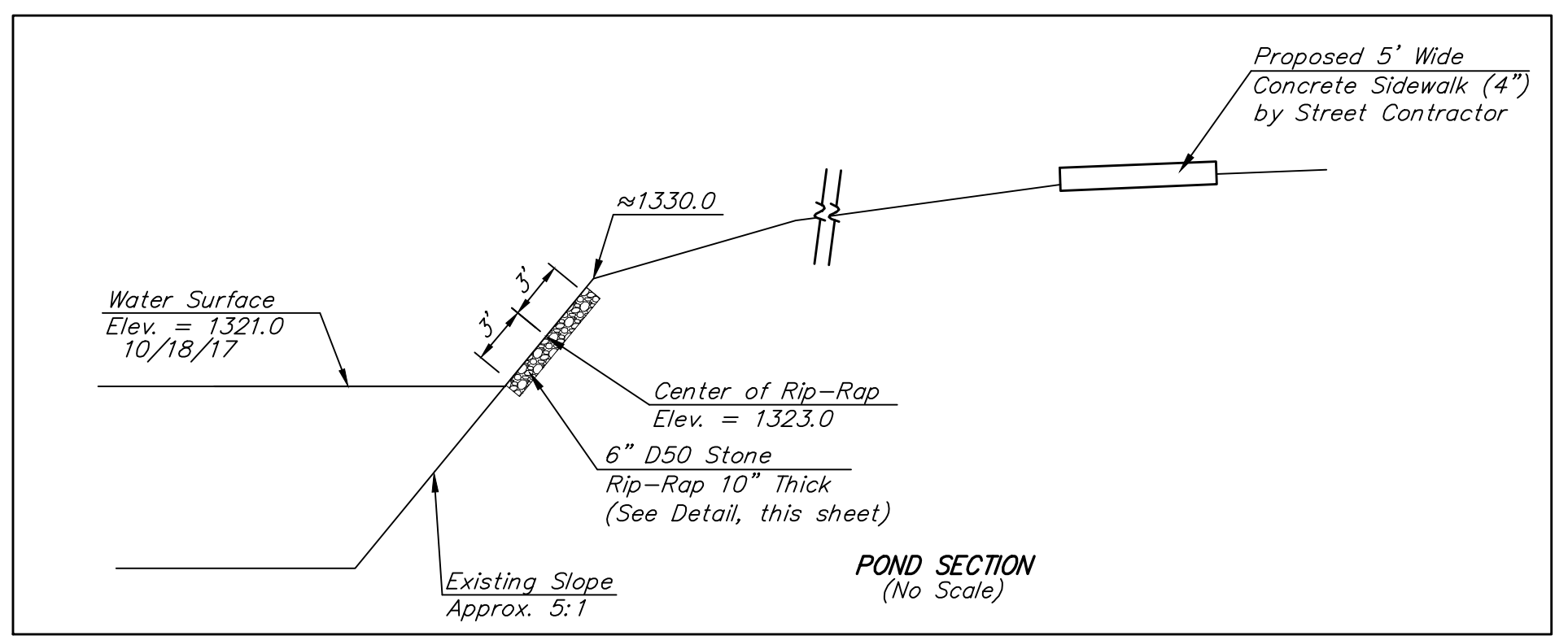

- NOTES:**
- Contractor shall make sure all erosion control is in place before project is accepted. This plan represents the minimum standard. Any additional erosion control measures shall be installed by the Contractor as needed.
  - Removal of Gravel Construction Entrance for pavement construction shall be included in bid item "Site Clearing & Restoration"
  - This Plan is Not To Be Used As A Comprehensive Grading Plan. All Spot Elevations Are Proposed & Subject To Change.

All areas disturbed during construction, unless otherwise noted, shall be seeded as follows: (Temporary Seeding)  
**SEED** -- Rye grass (PLS) -- 5 Lbs/1,000 Sq Ft.

Res. "J" & Res. "L" above static water surface shall be seeded and mulched up to existing grassed Elev. approx. 1325 as follows: (Permanent Seeding)  
**SEED** -- Kansas Premium Fescue Blend: 8 Lbs/1,000 Sq Ft  
 Annual Rye grass (PLS): 3 Lbs/1,000 Sq Ft  
**Fertilizer** -- 12-24-12 Ratio at 350 Lbs/Acre  
**Mulch** -- 2 Tons Prairie Hay / Acre

EROSION CONTROL MEASURE	INSTALL	MAINTAIN
BACK OF CURB PROTECTION (LF)	0	0
CONSTRUCTION ENTRANCE (EA)	0	1
CURB INLET BARRIER (EA)	0	0
EROSION CONTROL MAT (SY)	0	0
MAINTAIN EROSION CONTROL BMP's (LS)	0	1

\* ALL EXISTING BMPs INCLUDING CONSTRUCTION ENTRANCE, SEDIMENT BARRIERS, SILT FENCE, CUT-OFF TRENCH, AND EROSION CONTROL MAT SHALL BE MAINTAINED AND REPAIRED IF NECESSARY.

**Baughman** Siena Lakes Addition - Phase II  
**EROSION CONTROL**  
 Storm Water Sewer #695

Baughman Company, P.A. 315 Ellis St. Wichita, KS 67211 P 316-262-7271 F 316-262-0149  
 ENGINEERING | SURVEYING | PLANNING | LANDSCAPE ARCHITECTURE

PROJECT NUMBER 468-85053	DESIGN AEG	DRAWN JAK
REVISIONS:	APPROVED	DATE 1/05/18
	SCALE Noted	SHEET <b>3 OF 14</b>

E:\Projects\Siena Lakes\Engineering\Phase 2\SWS\_17-08-E786\SWS PLANS.dwg